

PROGRAM & EXHIBITS GUIDE

109th Thomas P. Hinman Dental Meeting

2022

Hinman®

Navigating Dental Disruptions

March 17–19 | Atlanta, Georgia

Georgia World Congress Center
& Omni Hotel at CNN Center

Dr. Kathleen L. Robinson, General Chair
Dr. William H. Rousseau, President

Hinman's NIGHT OUT

AT THE TABERNACLE

Friday, March 18 | 7–10:30 p.m. | Event Fr407

HINMAN'S NIGHT OUT is GOING to ROCK!

Food stations
& two drink
tickets for
all attendees

One of the
top party bands
in the Southeast,
performing Top 40 hits,
Motown, Classic Rock
and more.

featuring

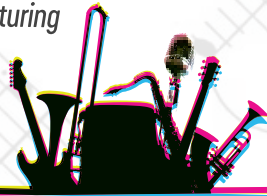

THE RUPERT'S ORCHESTRA

Casual
Attire

A chance
to win
gift card
prizes valued
between
\$5 & \$500,
with \$4,000
in total
prizes

TICKETS

- 🎵 All tickets must be purchased in advance
- 🎵 Visit Hinman Registration to purchase tickets
- 🎵 \$50 per attendee, \$25 students
(Must be 18 years of age)

HOW TO GET THERE

- 🎵 The Tabernacle is located at 152 Luckie Street
- 🎵 Shuttles: All hotel shuttles (additional stop at the Omni) will run until 11 p.m.
- 🎵 Walk: Half-mile from the GWCC
- 🎵 Drive: Numerous parking decks (rates vary)

Everyone attending MUST register for the Meeting and the event since tickets are required for entry. Tickets must be purchased in advance.

HINMAN WOULD LIKE TO THANK OUR PARTNERS FOR THEIR SUPPORT:



**CoastDental
& Orthodontics**

CITY NATIONAL BANK
AN RBC COMPANY



2022

Hinman

Navigating Dental Disruptions

TABLE OF CONTENTS

Accreditation & CE Information 15

Business Center Information 15

Exhibit Hall Floor Plan 26-27

Exhibitors Alphabetically 36-55

Exhibitors by Product Category 28-35

Friday Courses 6-8

Georgia World Congress Center Map 21-22

Hinman History 9

Keynote Session 2-3

Learning Lab 12

Omni Hotel Map 22-23

Receptions and Gatherings 14

Saturday Courses 10-11

Shuttle Schedule 17

Thursday Courses 4-5

Total Health Pavilion 13

Virtual CE 11

2023 Meeting Information 18-19



COVID GUIDELINES AND MASK POLICY:

Hinman recommends that attendees wear a protective mask while in course rooms and in the Exhibit Hall. Please visit [Hinman.org/General-Info/COVID-Policy](https://hinman.org/General-Info/COVID-Policy) for current COVID guidelines.



Keynote Session with Kathleen Madigan

Thursday from 5:30 – 7 p.m. | No Fee | Event Th401
GWCC, Sidney Marcus Auditorium

Join us for the official opening of the Hinman Dental Meeting!

Comedian Kathleen Madigan’s 32-year comedy career is showing no signs of slowing down. Madigan has been touring 250 nights a year on the road and has risen from performing in comedy clubs to performing in marquee theaters with sold out shows. She’s squeezed in over 40 appearances on late night talk shows and multiple comedy specials airing on Netflix, Comedy Central and HBO. She also

recently joined Jerry Seinfeld on his Netflix show “Comedians in Cars Getting Coffee” and made the most of the pandemic by launching a podcast, “Madigan’s Pubcast,” on all streaming outlets. Recently asked if her career was planned, she said, “No, like that guy in the Joy of Painting used to say, it was a happy accident. This whole thing just started out as a reason to drink and wow, what a great drinking accident.”

Madigan has performed internationally at festivals in theaters in Ireland, England, Hong Kong, Australia and has filmed seven Montreal Gala Shows at the Montreal Comedy Festival for CBC TV. “I never realized how middle America I am until performing overseas. It all works but needs some tweaking when the crowd isn’t all Americans. It’s a good challenge and made me a better comedian.” She also has joined numerous USO trips to entertain troops around the globe, including Iraq and Afghanistan.

She’s won the American Comedy Award for “Best Female Comedian” and the Phyllis Diller award for “Best Female Comedian.” She has written and produced for Lewis Black’s “Root of All Evil” on Comedy Central and done multiple USO tours in Iraq and Afghanistan. “The USO shows are the best. Trust me, no crowd is as appreciative and fired up to see any entertainer. I’m glad I have the chance because God knows I don’t wanna have to do their job!”

Madigan is an advocate and fundraiser for Cystic Fibrosis and Autism.

Originally from St. Louis, Missouri, Madigan splits her time between her home in the Missouri Ozarks and LA.

Marvin C. Goldstein Memorial Lecture

This session is sponsored by the Atlanta chapter of the Alpha Omega International Dental Fraternity in cooperation with the Thomas P. Hinman Dental Meeting. The Fraternity has dedicated this lectureship in memory of Dr. Marvin C. Goldstein.

Agenda

Musical Prelude

Call to Order

Introductions of The Thomas P. Hinman

Medallion Recipients

Dr. Mark Kleive

Dr. Jay Smith

Mr. Thomas Viola

Pledge to the Flag and National Anthem

Invocation and Greeting

Dr. William H. Rousseau, President

Welcome, Kathleen L. Robinson,
General Chair

Kathleen Madigan

Adjournment

Separate not thyself from the community~Ethics of the Fathers~

DR. MARVIN C. GOLDSTEIN

Marvin C. Goldstein, D.D.S., F.A.C.D., F.I.C.D. was a product of his heritage and his faith. He was devoted to his profession and to his family—immediate and extended. A man of his community, he gave of himself unstintingly to help make it the best it could be. Marvin’s philosophy about doing good things, simply put, was “because it’s the right thing to do.”



might not be completed, he knew he had to make the effort. But Marvin’s greatest passion was people. His community involvement knew no bounds. Civic leaders, regardless of faith, color, gender or political persuasion, turned to him as a man of courage and conviction. It was not only for financial help but also to seek his advice and counsel on subjects ranging from practicality to

those of more esoteric nature.

Active in more than 20 dental organizations, he devoted 48 years as a volunteer to the Ben Massell Dental Clinic in Atlanta where he was Chief of Staff Emeritus at the time of his death. He served as President of no less than eight dental, civic, religious or volunteer organizations, was Chairman of the board of ten such activities and participated as a worker in countless other associations. In addition to being a Clinical Professor of Orthodontics at the Medical College of Georgia School of Dental Medicine, he presented more than 200 lectures in the U.S. and abroad and contributed extensively to the literature.

His efforts to assist students trying to enter schools of higher education and the professions are legend. Those concerns were outdone only by the friendship he offered as they traveled the road of life. And, yet, this plate he had been served—so full of doing and giving to and for others—always had special room for his devoted wife and helpmate, Rita, and their five children and their families.

His plethora of activities make the point that one does what one wants to do and that time can be found to participate in total life-cycle experiences. Though realizing that many endeavors

Marvin Goldstein, whom we memorialize now and for the future, was truly “a man for all seasons”—a man for all reasons. Martin Buber, the great philosopher and theologian said, “God made no tools for himself; He needed none, for He created for Himself a partner.”

Such a partner was Marvin Goldstein. No more can— or need— be said.

These Dr. Marvin C. Goldstein Lectures, gifts to the Hinman Dental Meeting, are made possible by donations from members of the Atlanta Chapter of the Alpha Omega International Dental Fraternity, other Alpha Omega Fraters, friends and Dr. Goldstein’s family.

The Thomas P. Hinman Medallion

The Thomas P. Hinman Medallion is considered to be one of the highest honors bestowed in dentistry. The Medallion is not only an honor to the recipient, but also an honor to the memory of the man for whom it was named.

Julian Harris, the late world-famous sculptor, is responsible for the Medallion being a work of art. Mr. Harris, whose creations are seen in leading museums and in public buildings and squares across the nation, did diligent research before designing the Medallion. The primary motif is the official insignia of dentistry. The Medallion also includes the motto of the Hinman Dental Society, “Magna Est Veritas Et Praevalebit” – “Great is the Truth and It Shall Prevail.”



In 1950, the posthumous awarding of the first Medallion to Dr. Thomas P. Hinman was most fitting. Dr. Hinman was a student, an educator and a private practitioner of international renown. He was also president of the National Dental Association, predecessor of the American Dental Association. His greatest contribution to dental education, however, was the founding of the Mid-Winter Clinic in 1913, now the Thomas P. Hinman Dental Meeting.

COURSE INFORMATION Please visit the Hinman APP for course descriptions.

TYPE	COURSE #	FEES	DESCRIPTION
Participation Course	100	Fees vary	Seats for these hands-on courses should be purchased in advance as space is limited.
Registered Attendance Lecture	200	Fees vary	Seats for these lectures should be purchased in advance or onsite as space is available.
Interactive Course	200	Fees vary	Seats for these discussion-based courses should be purchased in advance as space is limited.
General Attendance Lecture	300 & 500	No fee	Seats for these lectures can be selected in advance or onsite (if space is available).
Special Event	400	Fees vary	Seats for these events can be purchased or selected in advance or onsite (if space is available).

Please be sure to record your four-digit course completion code at the conclusion of each course. You will need the code and your badge number in order to process your CE certificate. Course handouts are available at Hinman.org and on the Hinman APP until April 11.

COURSE BUILDING/ROOM	SPEAKER	TITLE	TIME
Th100 Omni/Dogwood A	Dr. Gigi Meinecke	Botox and Dermal Filler Training with Cadaver Anatomy Review Workshop	8 a.m. - 5 p.m.
Th101 Omni/Dogwood A	Dr. Gigi Meinecke	Botox Refresher Course	8 a.m. - 12 p.m.
Th102 GWCC/Exhibits 5	Dr. Mike Pruett	Management of Medical Emergencies in the Dental Office: The Team Approach	8 a.m. - 3 p.m.
Th103 Omni/Cottonwood	Dr. Alan Atlas	Mastering Posterior Composites and Alternatives for Compromised Situations - Hands-on Workshop*	8 - 11 a.m.
Th104 GWCC/Exhibits 2	Dr. Kevin Suzuki	Extraction and Guided Bone Regeneration: A Hands-On Workshop	8 - 11 a.m.
Th105 Omni/Juniper	Dr. Mark Kleive	Mastering Dental Photography with Your Smartphone*	8:30 - 11 a.m.
Th106 GWCC/Exhibits 6	Ms. Nancy Dewhirst	Instrument Sharpening: Never A Dull Moment	8:30 - 11:30 a.m.
Th107 GWCC/Exhibits 1	Ms. Marianne Dryer	From Assessment to Ascension: Components of the Exceptional Dental Hygiene Treatment Plan - What's in Your Operatory?	9 - 11 a.m.
Th108 Omni/Maple		Cardiopulmonary Resuscitation Re-Certification (CPR)*	9 a.m. - 12 p.m.
Th109 Omni/Redwood	Dr. Tanya Brown	Make Provisional Crowns as Easy as "ABC"™	9:30 - 11:30 a.m.
Th110 GWCC 		Preventive Equipment Maintenance*	9:30 - 10:30 a.m.
Th111 Omni/Cottonwood	Dr. Alan Atlas	Mastering Posterior Composites and Alternatives for Compromised Situations - Hands-on Workshop*	12 - 3 p.m.
Th112 Omni/Magnolia	Ms. Tija Hunter	Implant Pieces and Parts	12 - 3 p.m.
Th113 GWCC/Exhibits 2	Dr. Kevin Suzuki	Clinical Crown Lengthening: A Hands-On Workshop	12 - 3 p.m.
Th114 Omni/Juniper	Dr. Mark Kleive	Bite Splints in Restorative Practice	12:30 - 3 p.m.
Th115 Omni/Dogwood B	Dr. Ronni Schnell	The Nuts and Bolts of Implant-Assisted Overdentures Workshop	12:30 - 3:30 p.m.
Th116 Omni/Redwood	Dr. Tanya Brown	Make Provisional Crowns as Easy as "ABC"™	1 - 3 p.m.
Th117 GWCC/Exhibits 1	Dr. Howard Glazer	Composites Can Be "Beautiful!"	1 - 4 p.m.
Th118 GWCC/Exhibits 3	Dr. Amy Kuhmichel	Hands-On Oral Surgery Workshop*	1 - 4 p.m.
Th119 Omni/Oak	Dr. Dan Coleman & Dr. Paul Levi	Optimizing Non-Surgical Root Debridement*	1 - 5 p.m.
Th120 GWCC/Exhibits 6	Dr. Lee Silverstein	How to Perform the Restorative Procedure to Deliver the Teeth In-A-Day Prostheses	1:30 - 4 p.m.
Th121 Omni/Maple		Cardiopulmonary Resuscitation Re-Certification (CPR)*	1:30 - 4:30 p.m.
Th200 GWCC/A407	Ms. Laci Phillips Newland	Systems, Teams and Technology: Creating Balance-Driven Success in Your Practice	8 - 10 a.m.
Th201 GWCC/A403	Dr. Lee Brady	Top Clinical Tips for Esthetic Success*	8 - 10:30 a.m.
Th202 GWCC/A304	Dr. Tieraona Low Dog	Nutrition Update for the Dental Team*	8 - 10:30 a.m.
Th203 GWCC/A314	Dr. Gordon Christensen	2022 Christensen Bottom Line	8 - 11 a.m.
Th204 GWCC/A316	Dr. Mark Hyman	Cases That Haunt Us: How To React, Rebound and Recover from Clinical Failure	8 - 11 a.m.
Th205 Omni/International Ballroom C	Dr. Jeff Pafford	Understanding and Managing Root Resorption*	8 - 11 a.m.
Th206 GWCC/A313	Dr. Ronni Schnell	"Go Ahead, Bite Into That Apple!" Diagnosing for Success: Avoiding Complications with Implant-Assisted Overdentures	8 - 11 a.m.
Th207 GWCC/A312	Dr. John Svirsky	Come In and Catch It: The Review That Sticks	8 - 11 a.m.
Th208 GWCC/A402	Mr. Tom Viola	"Waiting To Inhale?": Do You Know Enough About Marijuana (Cannabis) to Have THAT Conversation With Your Patient?	8 - 11 a.m.
Th209 GWCC/A303	Dr. Witt Wilkerson	Integrating Airway and Sleep Disorders Into the Daily Practice of Dentistry	8 - 11 a.m.
Th210 GWCC/A409	Dr. Lee Silverstein	How to Perform the Facial Analysis and Restorative Procedures for Teeth In-A-Day Cases	8:30 - 11 a.m.
Th211 GWCC/A315	Ms. Karen Davis	Cannabis, Cancer and Chronic Pain: Exploring the Connections	8:30 - 11:30 a.m.
Th212 GWCC/A404	Dr. Hal Crossley	The New Street Drugs and Their Impact on Your Patients	9 - 11 a.m.
Th213 Omni/Chestnut	Dr. Jay Smith	Restorative Considerations for the Young Patient: A Team Approach	9:30 - 11:30 a.m.

THURSDAY MARCH 17

COURSE BUILDING/ROOM	SPEAKER	TITLE	TIME
Th214 GWCC/A310	Dr. Tom McDonald	Managing Forces: The Key to Restorative Success	9:30 a.m. - 12 p.m.
Th215 Omni/Hazelnut	Dr. Van Haywood	Bleaching a Single Dark Tooth	10 - 11:30 a.m.
Th216 GWCC/A406	Dr. Michael Gelb	TAO Dentistry: Integrating TMJ, Airway and Ortho into General Practice	10 a.m. - 12 p.m.
Th217 GWCC/A403	Dr. Tim Donley	Staging and Grading is Great if You Have Plenty of Time: Here is What to Do Chairside if You Do Not!	12 - 2:30 p.m.
Th218 GWCC/A405	Mr. Steve Anderson	STOP Cancellations! Schedule Disrupted No More!	12 - 3 p.m.
Th219 GWCC/A313	Dr. Gordon Christensen	The Best Crowns for 2022	12 - 3 p.m.
Th220 GWCC/A316	Dr. Gerry Kugel	The Future of Dentistry: It's Digital and 3D Printing!	12 - 3 p.m.
Th221 GWCC/A402	Dr. Susan Maples	Sleep Tight: Integrating Practices for Sleep-Disordered Breathing and OSA from Cradle to Grave	12 - 3 p.m.
Th222 GWCC/A303	Dr. Jeff Pafford	CBCT in Endodontics: Uses and Misuses	12 - 3 p.m.
Th223 GWCC/A304	Dr. Witt Wilkerson	Integrative Dental Medicine: The Next Great Frontier	12 - 3 p.m.
Th225 GWCC/A407	Dr. Lee Brady	Mastering Anterior Implant Aesthetics	12:30 - 3 p.m.
Th226 Omni/International Ballroom C	Mr. Charles Loretto	Accumulating Wealth in Your Practice: Financial Decisions to Take You There	12:30 - 3 p.m.
Th227 GWCC/A315	Ms. Marianne Dryer	Taking Diagnostically Acceptable Radiographs: The Importance of Being a Straight Shooter	1 - 2 p.m.
Th300 Omni/International Ballroom F	Ms. Penny Reed	Dental Metrics and the Wizard of Oz	8 - 10 a.m.
Th301 GWCC/A302	Mr. Steve Anderson	Disrupted or Reconstructed? Lessons from COVID-19 that Can Transform the Future of Your Practice	8 - 11 a.m.
Th302 Omni/International Ballroom E	Dr. Tim Donley	How to Transition to a Wellness-Oriented Practice Starting Tomorrow	8 - 11 a.m.
Th303 GWCC/A411	Dr. Susan Maples	Seeing in the Mouth with Super Powered Eyes: Total Health Dentistry and Practice Profitability	8 - 11 a.m.
Th304 GWCC/A305	Ms. Tija Hunter	Rock-Star Dental Assistant	8:30 - 10:30 a.m.
Th305 Omni/Grand Ballroom D2-E	Dr. Ellen Daley	HPV and Oropharyngeal Cancer: An Update on an Emerging Dental and Public Health Issue*	9 - 10 a.m.
Th306 GWCC/A401	Mr. Charles Loretto	Understanding Private Equity Offers: Sorting Through the Truth, Lies, Opportunities and Threats	9 - 11 a.m.
Th308 GWCC/A410	Ms. Carrie Webber	The High-Performing Team's Playbook	9:30 - 11 a.m.
Th309 Omni/International Ballroom D	Dr. Mitch Gardiner	Medical History and Informed Consent: Without a Complete Medical History and Valid Informed Consent You are Playing Russian Roulette!	9:30 a.m. - 12:30 p.m.
Th310 GWCC/A412	Mr. Kevin Henry	Solving the Three Most Common Battles Between the Front Office and the Back Office	10 a.m. - 12 p.m.
Th311 Omni/Grand Ballroom A-D1	Dr. Uche Odiatu	Maximum Immunity: Fortify Your Body's Natural Defenses*	10 a.m. - 12 p.m.
Th312 Omni/International Ballroom F	Ms. Laci Phillips Newland	Leading Through the Disruption: Five Keys to Great Leadership*	12 - 2 p.m.
Th313 Omni/Grand Ballroom D2-E	Dr. Alan Budenz	Numb, Number, Numbest: Updates on Local Anesthesia	12 - 3 p.m.
Th314 GWCC/A404	Dr. Rick Cardoza	21st-Century Laser-Assisted Dentistry	12 - 3 p.m.
Th315 GWCC/A305	Dr. Mark Hyman	The High Impact Private Practice Dental Hygiene Team	12 - 3 p.m.
Th316 Omni/International Ballroom AB	Dr. Greg Psaltis	Think and Work Like a Pediatric Dentist	12 - 3 p.m.
Th317 GWCC/A410	Dr. Larry Williams	Geriatric Dentistry: Treatment Planning, Treatment Concerns and Communication*	12 - 3 p.m.
Th318 GWCC/A302	Ms. Amber Auger	Progressive Periodontal Therapy	12:30 - 2 p.m.
Th319 Omni/International Ballroom E	Dr. Van Haywood	Bleaching Tips and Pearls: Single Dark Teeth, Sensitivity and Caries Control	12:30 - 3 p.m.
Th320 GWCC/A311	Dr. Michael Gelb	The Hygienist as Oral PA	1 - 2 p.m.
Th321 Omni/Grand Ballroom A-D1	Dr. Tieraona Low Dog	Emotional Wellness in Times of Transition	1 - 3 p.m.
Th322 GWCC/A411	Ms. Penny Reed	Driving Case Acceptance: Be More Like DISNEY and Less Like the IRS	1 - 3 p.m.
Th323 GWCC/A312	Dr. Jay Smith	Simplified Shade Matching	1 - 3 p.m.
Th324 Omni/International Ballroom D	Ms. Carrie Webber	Marketing Mash-Up: The Internal and External Marketing Recipe to Grow Your Practice	1:30 - 3 p.m.
Th375 GWCC/A311	Dr. John Olmsted	Navigating Endodontics: Diagnosis, Anesthesia, Access, Instrumentation Advancements	8:30 - 11:30 a.m.
Th376 GWCC/A314	Dr. John Olmsted	Charting the Latest Endodontic Technology: Irrigation, Obturation, Restoration, Post-Op	1 - 4 p.m.
Th501 GWCC 	Ms. Mary Ellen Psaltis	What's Disrupting Your Health?	10 - 11 a.m.
Th502 GWCC 	Dr. Ellen Daley	HPV and Oropharyngeal Cancer: An Update on an Emerging Dental and Public Health Issue*	12 - 1 p.m.
Th503 GWCC 	Mr. Tom Viola	"Sugar? Yes, Please!": How Will You Successfully Treat Your Patient With Diabetes?	1 - 2 p.m.
Th504 GWCC 	Dr. John Svirsky	For the Fun of It: Human Papilloma Virus in 2022	2 - 3 p.m.
Th550 GWCC 	Ms. Susan Wingrove	Disrupt, Debride and Detoxify: Implant Maintenance and Disease Treatment*	3:30 - 4:30 p.m.

SPECIAL EVENTS

Th400 AmericasMart	AmericasMart Shopping*	10 a.m. - 4 p.m.
Th401 GWCC/Sidney Marcus Auditorium	Keynote Session with Kathleen Madigan	5:30 - 7 p.m.

COURSE INFORMATION Please visit the Hinman APP for course descriptions.







TYPE	COURSE #	FEES	DESCRIPTION
Participation Course	100	Fees vary	Seats for these hands-on courses should be purchased in advance as space is limited.
Registered Attendance Lecture	200	Fees vary	Seats for these lectures should be purchased in advance or onsite as space is available.
Interactive Course	200	Fees vary	Seats for these discussion-based courses should be purchased in advance as space is limited.
General Attendance Lecture	300 & 500	No fee	Seats for these lectures can be selected in advance or onsite (if space is available).
Special Event	400	Fees vary	Seats for these events can be purchased or selected in advance or onsite (if space is available).

Please be sure to record your four-digit course completion code at the conclusion of each course. You will need the code and your badge number in order to process your CE certificate. Course handouts are available at Hinman.org and on the Hinman APP until April 11.

COURSE BUILDING/ROOM	SPEAKER	TITLE	TIME
Fr100 Omni/Dogwood A	Dr. Gigi Meinecke	Botox and Dermal Filler Training with Cadaver Anatomy Review Workshop	8 a.m. - 5 p.m.
Fr123 Omni/Dogwood A	Dr. Gigi Meinecke	Dermal Filler Refresher Course	8 a.m. - 12 p.m.
Fr124 GWCC/Exhibits 5	Dr. Mike Pruett	Introduction to Implant Dentistry: Hands-On Placement with Models	8 a.m. - 4 p.m.
Fr125 Omni/Oak	Dr. Dan Coleman & Dr. Paul Levi	Optimizing Non-Surgical Root Debridement*	8 a.m. - 12 p.m.
Fr126 Omni/Magnolia	Dr. Alan Budenz	X Marks the Spot: Local Anesthesia Techniques Simulation Hands-On Workshop	8:30 - 11:30 a.m.
Fr128 Omni/Maple		Cardiopulmonary Resuscitation Re-Certification (CPR)*	9 a.m. - 12 p.m.
Fr130 GWCC/Exhibits 3	Dr. Amy Kuhmichel	Hands-On Oral Surgery Workshop*	9:30 a.m. - 12:30 p.m.
Fr131 GWCC/Exhibits 6	Dr. Lee Silverstein	Atraumatic Extraction and Socket Grafting for the General Practitioner	9:30 a.m. - 12:30 p.m.
Fr132 GWCC/Exhibits 1	Dr. Rick Cardoza	21st-Century Laser-Assisted Dentistry: A Participatory Workshop*	10 a.m. - 12 p.m.
Fr133 Omni/Cottonwood	Dr. Greg Psaltis	Stainless-Steel Crowns Are a Snap	1 - 4 p.m.
Fr134 Omni/Dogwood B	Dr. Ronni Schnell	Do Your Dentures Suck? They Should! Achieving Suction the Digital Way	1 - 4 p.m.
Fr136 Omni/Oak	Dr. Dan Coleman & Dr. Paul Levi	Optimizing Non-Surgical Root Debridement*	1 - 5 p.m.
Fr137 Omni/Maple		Cardiopulmonary Resuscitation Re-Certification (CPR)*	1:30 - 4:30 p.m.
Fr138 GWCC 		Preventive Equipment Maintenance*	1:30 - 2:30 p.m.
Fr139 GWCC/Exhibits 6	Dr. Lee Silverstein	Suturing for the General Practitioner and Surgical Staff	2 - 4:30 p.m.
Fr140 GWCC/Exhibits 3	Dr. Amy Kuhmichel	Hands-On Oral Surgery Workshop*	2 - 5 p.m.
Fr141 GWCC/Exhibits 1	Dr. Rick Cardoza	21st-Century Laser-Assisted Dentistry: A Participatory Workshop*	2:30 - 4:30 p.m.
Fr155 Omni/Redwood	Dr. John Olmsted	Excellent and Efficient Endodontic Workshop*	8:30 - 11:30 a.m.
Fr156 Omni/Redwood	Dr. John Olmsted	Excellent and Efficient Endodontic Workshop*	1 - 4 p.m.
Fr228 GWCC/B402	Dr. Tanya Brown, Mr. Kevin Henry, Ms. Tija Hunter, Dr. Mark Hyman	Assisting Essentials	9 a.m. - 4 p.m.
Fr229 Omni/Hickory	Mr. Steve Anderson, Dr. Mark Kleive, Mr. Charles Loretto, Ms. Christy Ratcliff, Ms. Carrie Webber	New Dentist Track	9 a.m. - 4 p.m.
Fr230 GWCC/A311	Ms. Carol Paige, Ms. Laci Phillips Newland, Ms. Penny Reed, Ms. Grace Rizza	Business Office Bonanza	9 a.m. - 4 p.m.
Fr231 GWCC/A412	Ms. Amber Auger, Ms. Karen Davis, Dr. Dan Dunwody, Dr. Susan Maples	Prevention Convention	9 a.m. - 4 p.m.
Fr232 Omni/Chestnut	Dr. Howard Glazer	I Have It...You Need It! The 2022 Edition	9:30 a.m. - 4:30 p.m.
Fr233 Omni/Sycamore	Ms. Christy Ratcliff	Having It All: Making Your Practice Work for You	8 - 10 a.m.
Fr234 Omni/Grand Ballroom A-D1	Dr. Gordon Christensen	Fifty New Clinical Tips for 2022	8 - 11 a.m.
Fr235 GWCC/A403	Dr. Hal Crossley & Dr. Mitch Gardiner	Changing Standards of Care 2022: Practice in the Present and Protect Your Patients	8 - 11 a.m.
Fr236 GWCC/A303	Mr. Tom Viola	"Phantom of the Opera-tory!": Essential Pharmacology for Successful Patient Management for the Whole Dental Team!	8 - 11 a.m.
Fr237 GWCC/A310	Dr. Alan Atlas	Impress with Success! Prep, Impress and Cement Using Evidenced-Based Techniques for Ceramics	8:30 - 11:30 a.m.
Fr238 Omni/International Ballroom E	Ms. Teresa Duncan	Today's Insurance Coordinator Field Guide	8:30 - 11:30 a.m.
Fr239 GWCC/A313	Dr. Ronni Schnell	Digital Complete Dentures: Not Your Grandma's Dentures Anymore!	8:30 - 11:30 a.m.
Fr240 GWCC/A406	Dr. Witt Wilkerson	Integrating Splint Therapy in the Treatment of TMD and Airway Disorders	8:30 - 11:30 a.m.

FRIDAY MARCH 18

COURSE BUILDING/ROOM	SPEAKER	TITLE	TIME
Fr241 GWCC/A315	Dr. Tim Donley	Doctors are from Mars and Hygienists are from the Real World: How to Get Doctor and Hygienists to Better Communicate to Help Your Patients and Your Practice	9 - 11 a.m.
Fr242 Omni/International Ballroom C	Ms. Laci Phillips Newland	Creating Leaders in Your Practice: Three Key Systems to a Perfect Team	9 - 11 a.m.
Fr243 Omni/Walnut	Mr. Charles Loretto	Creating a Successful Dental Partnership: Lessons Learned from 35 Years of Practice Transitions	9:30 a.m. - 12 p.m.
Fr244 GWCC/A401	Dr. Ken Berley	Dental Sleep Medicine: How to Make this Work! Part 1	9 a.m. - 12 p.m.
Fr245 Omni/Spruce	Ms. Nancy Dewhirst	Ergonomics: It's a Balancing Act	9:30 - 11:30 a.m.
Fr246 GWCC/A404	Dr. John Svirsky	Oral Cancer 2022: Lumps, Bumps and Lesions for All Seasons	9:30 a.m. - 12:30 p.m.
Fr247 GWCC/A409	Dr. Kevin Suzuki	Peri-implant Disease: Diagnoses, Management and Maintenance	10 - 11:30 a.m.
Fr248 GWCC/A316	Dr. Tieraona Low Dog	Immune Health in the Era of Pandemics	10 a.m. - 12 p.m.
Fr249 Omni/Hazelnut	Dr. Jeff Pafford	Pain, Testing and Diagnostics: How to Get it Right the First Time*	10 a.m. - 12 p.m.
Fr250 GWCC/A407	Ms. Carrie Webber	Plagued by Cancellations and No Shows? Three Remedies to Keep Your Practice Thriving	11 a.m. - 1 p.m.
Fr251 Omni/International Ballroom AB	Dr. Hal Crossley	Opioid Use, Misuse, Abuse and Addiction: Appropriate Opioid and Non-Opioid Prescribing*	1 - 3 p.m.
Fr252 GWCC/A313	Dr. Lee Brady	Anterior Composite Artistry	1 - 3:30 p.m.
Fr253 GWCC/A315	Dr. Tim Donley	How to Keep Your Implants Off of the Failure List	1 - 3:30 p.m.
Fr254 GWCC/A304	Dr. Tom McDonald	Anterior Tooth Positioning for Occlusion and Esthetics	1 - 3:30 p.m.
Fr255 GWCC/A405	Dr. Alan Atlas	Myth Buster! The Evidence Reveals What's Best for Posterior Composites and Alternatives for Compromised Situations	1 - 4 p.m.
Fr256 GWCC/A410	Ms. Nancy Dewhirst	Annual OSHA Training and Infection Control: Are We Safe "Enough?"*	1 - 4 p.m.
Fr257 GWCC/A312	Dr. John Nosti	Treating Worn Smiles	1 - 4 p.m.
Fr258 GWCC/A403	Mr. Tom Viola	"Hurts So... Swell!": Management of Acute Dental Pain, Guidelines for Appropriate Opioid Prescribing and Abuse Awareness	1 - 4 p.m.
Fr259 GWCC/A314	Ms. Amber Auger	From Pockets to Pathogens: Maximize Technology for Optimal Periodontal Therapy Success	1:30 - 3 p.m.
Fr260 GWCC/A409	Ms. Karen Davis	The Magic of Air on Dysbiotic Biofilms	1:30 - 3 p.m.
Fr261 Omni/Spruce	Ms. Teresa Duncan & Mr. Kevin Henry	Insider Perspectives: State of the Dental Industry	1:30 - 3:30 p.m.
Fr262 GWCC/A316	Dr. Tieraona Low Dog	Nutrition Update for the Dental Team*	1:30 - 4 p.m.
Fr263 GWCC/A407	Dr. John Svirsky	Tumors Are Things That Grow Bump in the Night	1:30 - 4 p.m.
Fr264 GWCC/A406	Dr. Alan Budenz	Are Your Patients Getting Comfortably Numb? Maximizing the Pharmacology of Local Anesthesia	1:30 - 4:30 p.m.
Fr265 Omni/International Ballroom C	Dr. Gerry Kugel	Direct Adhesive Restorative and Bioactive Dentistry	1:30 - 4:30 p.m.
Fr266 GWCC/A303	Ms. Grace Rizza	Social Media Marketing That Works*	2 - 3:30 p.m.
Fr267 GWCC/A402	Dr. Larry Williams	Tobacco, Vaping and Cannabis: What Do You Know?	2 - 4 p.m.
Fr268 GWCC/A401	Dr. Ken Berley	Dental Sleep Medicine: How to Make this Work! Part 2	2 - 5 p.m.
Fr269 GWCC/A310	Dr. Jay Smith	Demystifying Sequencing of the Full Mouth Rehabilitation	2 - 5 p.m.
Fr326 GWCC/A305	Dr. Michael Gelb	The New Healthy Nightguard 2022: Lifesaver?	8 - 9:30 a.m.
Fr327 GWCC/A411	Dr. Brian Novy	Nobody Caries	8 - 10:30 a.m.
Fr328 Omni/International Ballroom F	Dr. Mark Kleive	Wealth Accumulation for Every Stage of Your Dental Career	8:30 - 11 a.m.
Fr329 GWCC/B401	Dr. Ellen Daley	HPV and Oropharyngeal Cancer: An Update on an Emerging Dental and Public Health Issue*	9 - 10 a.m.
Fr330 Omni/International Ballroom AB	Ms. Tija Hunter	Dental Unit Waterline Contamination: What's in Your Water?	9 - 11 a.m.
Fr331 GWCC/A405	Dr. John Alonge	Differential Diagnosis of Oral Lesions: An Interactive Presentation Using Audience Response Polling	9 a.m. - 12 p.m.
Fr332 GWCC/Sidney Marcus Auditorium	Ms. Marianne Dryer	The AAP Classification of Periodontal and Peri-Implant Diseases: Aligning the Dental Hygiene Diagnosis	9 a.m. - 12 p.m.
Fr333 GWCC/A402	Ms. Carol Paige	HIRE RIGHT: Shopping Therapy to Help You Find Your Best-Fit Team Member!	9 a.m. - 12 p.m.
Fr334 GWCC/A410	Dr. Jay Smith	Consideration for Enhanced Aesthetics in Implant Dentistry	9 a.m. - 12 p.m.
Fr335 GWCC/A314	Dr. Van Haywood	Matrix Bands for Posterior Composite Restorations	9:30 - 10:30 a.m.
Fr336 GWCC/A304	Dr. Dan Dunwody	Observations, Reflections, and Expectations from Over 35 years of Clinical Evaluation and Dentofacial Treatment of Patients with Chronic Airway Compromises	9:30 - 11:30 a.m.
Fr337 Omni/International Ballroom D	Dr. Rich Constantine	Rediscover Your Authentic Self: Gain Greater Satisfaction in Life*	10 - 11 a.m.
Fr338 GWCC/A302	Dr. Larry Williams	How Much Do You Know About Vaping?	10 - 11:30 a.m.
Fr339 GWCC/A312	Dr. Pat Little	HIPAA Security Rule, Data Breaches and Identity Theft: Don't Get Bitten*	10 a.m. - 12 p.m.
Fr341 Omni/Grand Ballroom D2-E	Dr. Michael Gelb	TMD: First Sign of an Airway Disorder?	11 a.m. - 12 p.m.
Fr342 GWCC/A411	Ms. Marianne Dryer	The Polishing Spin: A look at the Science, History and New Technologies	1 - 2 p.m.
Fr343 Omni/Grand Ballroom D2-E	Dr. Rich Constantine	Rediscover Your Authentic Self: Gain Greater Satisfaction in Life*	1 - 2 p.m.

COURSE BUILDING/ROOM	SPEAKER	TITLE	TIME
Fr344 GWCC/A302	Dr. Brian Novy	Codependent Cariology	1 - 3:30 p.m.
Fr345 GWCC/Sidney Marcus Auditorium	Dr. Neil Warshawsky	Learn to Identify the Top Five Reasons to Refer Your Kids for Orthodontic Intervention	1 - 4 p.m.
Fr346 Omni/International Ballroom D	Dr. Kevin Suzuki	Periodontal Plastic Surgery	1:30 - 3 p.m.
Fr347 Omni/Grand Ballroom A-D1	Dr. John Alonge	Practical Concepts and Applications for Office Oral Surgery	1:30 - 4:30 p.m.
Fr348 GWCC/A404	Dr. Michael Gelb	Growing the Airway with Orthodontics	2 - 3 p.m.
Fr350 GWCC/A305	Dr. Tanya Brown	Get Off the Treadmill for Good: A Total Team Approach	2 - 3:30 p.m.
Fr351 Omni/International Ballroom E	Dr. Van Haywood	Novel Tray Fabrication Options for Bleaching, Sensitivity and Caries Control	2 - 3:30 p.m.
Fr352 GWCC/B401	Dr. Mitch Gardiner	Your Dental Team Can Defend You From Malpractice: Teach Them How	2 - 4:30 p.m.
Fr353 Omni/International Ballroom F	Ms. Carrie Webber	Seven Case Presentation Stumbling Blocks and How to Overcome Them	2 - 4:30 p.m.
Fr505 GWCC 	Dr. Susan Maples	Slaying Dragons: Acid Reflux and Diabetes Detection in the Dental Office	10 - 11 a.m.
Fr506 GWCC 	Ms. Mary Ellen Psaltis	Add Up Your Numbers	11 a.m. - 12 p.m.
Fr507 GWCC 	Ms. Mary Ellen Psaltis	Aging with Power	1 - 2 p.m.
Fr508 GWCC 	Dr. Uche Odiatu	Nutrition Essentials for Optimal Health	3:30 - 5 p.m.
Fr551 GWCC 	Ms. Susan Wingrove	Disrupt, Debride, and Detoxify: Implant Maintenance and Disease Treatment*	9:30 - 10:30 a.m.
Fr552 GWCC 		New Product Symposium	11 a.m. - 12 p.m.

SPECIAL EVENTS

Fr402 AmericasMart	AmericasMart Shopping	10 a.m. - 4 p.m.
Fr403	Southern Beer Tour	12:30 - 5:30 p.m.
Fr404 Omni/Atrium	Wine Tasting and Seminar with Michael Gallant	3 - 4:30 p.m.
Fr405 AmericasMart	Shoppportunity at AmericasMart	11 a.m. - 2 p.m.
Fr407 The Tabernacle	Hinman's Night Out at the Tabernacle	7 - 10:30 p.m.

GET THE HINMAN APP!

Manage your registration account on the go and access these features in real time:



- ✓ Course Room Locations
- ✓ Exhibitor Lists, Floor Plans and Show Specials
- ✓ Maps of the GWCC and Omni
- ✓ CE Verification
(avoid the lines and email certificates to print from home)
- ✓ Add Courses and Special Events Onsite



WiFi will be provided by





History of the THOMAS P. HINMAN DENTAL MEETING

The Thomas P. Hinman Dental Meeting is sponsored by the Hinman Dental Society, a non-profit organization. The first Meeting was held in Dr. Thomas P. Hinman and was considered to be the first clinic strictly for serious-minded educational purposes. The Meeting developed a reputation for devotion to detail and hospitality that continues to grow through the years with every meeting.

Born in 1870, Thomas Hinman graduated from Southern Dental College in Atlanta with his Doctor of Dental Surgery degree in 1891.

The first classes for the Atlanta Midwinter Clinic, later renamed the Thomas P. Hinman Dental Meeting, were initially limited to 40 dentists with strict focus on education. The attendee was honor-bound to return to his state dental society and present what he had learned in a formal program.

Today, the focus is still on providing the best possible education, not only for dentists, but also for the entire dental team. The program addresses the needs of general dentists, specialists, hygienists, assistants, office staff, lab techs and students.

The Hinman Dental Society today is comprised of 830 dentist members, primarily located in metropolitan Atlanta. The membership responsibilities include service during the Meeting each year.

The excess revenue of the Meeting is invested and gifted in the form of scholarships to individuals and in contributions to institutions that foster dental education whether at the undergraduate or post-graduate level. As of March 2022, the Society has provided more than \$10 million in total giving.

Photo Op Alert!

Snap a photo and use the official hashtag **#myhinman** in your posts!
Tag **@hinmandental** so we can follow along!



Outside Sidney Marcus Auditorium
GWCC, Level 400



Exhibit Hall, Social Media Lounge
Booth 2147

Hinman.org | | **#myhinman**

COURSE INFORMATION Please visit the Hinman APP for course descriptions.

TYPE	COURSE #	FEES	DESCRIPTION
Participation Course	100	Fees vary	Seats for these hands-on courses should be purchased in advance as space is limited.
Registered Attendance Lecture	200	Fees vary	Seats for these lectures should be purchased in advance or onsite as space is available.
Interactive Course	200	Fees vary	Seats for these discussion-based courses should be purchased in advance as space is limited.
General Attendance Lecture	300 & 500	No fee	Seats for these lectures can be selected in advance or onsite (if space is available).
Special Event	400	Fees vary	Seats for these events can be purchased or selected in advance or onsite (if space is available).

Please be sure to record your four-digit course completion code at the conclusion of each course. You will need the code and your badge number in order to process your CE certificate. Course handouts are available at Hinman.org and on the Hinman APP until April 11.

COURSE BUILDING/ROOM	SPEAKER	TITLE	TIME
Sa100 Omni/Dogwood A	Dr. Gigi Meinecke	Botox and Dermal Filler Training with Cadaver Anatomy Review Workshop	8 a.m. - 1 p.m.
Sa142 Omni/Juniper	Dr. Mark Kleive	Mastering Dental Photography with Your Smartphone*	8:30 - 11 a.m.
Sa143 Omni/Dogwood B	Dr. Ken Berley & Ms. Patty Berley	Dental Sleep Medicine: Hands-On Workshop	8:30 - 11:30 a.m.
Sa144 Omni/Spruce	Dr. John Nosti	Smile Design Dentures	8:30 - 11:30 a.m.
Sa145 Omni/Redwood	Dr. Neil Warshawsky	A Practical Approach to Building Clear Aligners for Tooth Movement	8:30 - 11:30 a.m.
Sa146 Omni/Oak	Dr. Dan Coleman & Dr. Paul Levi	Optimizing Non-Surgical Root Debridement*	8:30 a.m. - 12:30 p.m.
Sa148 Omni/Cottonwood	Dr. John Alonge	Oral Biopsy Techniques Workshop	9 - 11:30 a.m.
Sa149 GWCC/Exhibits 6	Dr. Lee Silverstein	Basic Dental Implant Fixture Placement in Pig Jaws	9 - 11:30 a.m.
Sa150 GWCC/Exhibits 3	Dr. Amy Kuhmichel	Hands-On Oral Surgery Workshop for DENTAL STUDENTS ONLY	10 a.m. - 12 p.m.
Sa151 Omni/Magnolia	Dr. Tom McDonald	Diagnostic Waxing for Complex Cases	12:30 - 3:30 p.m.
Sa152 GWCC/Exhibits 6	Dr. Lee Silverstein	Suturing for DENTAL STUDENTS ONLY	1 - 3 p.m.
Sa153 Omni/Juniper	Dr. Gerry Kugel	The Dos and Don'ts of Porcelain Laminate Veneers Workshop	1 - 4 p.m.
Sa154 Omni/Spruce	Dr. John Nosti	Mastering Posterior All Ceramics	1 - 4 p.m.
Sa270 Omni/Chestnut	Dr. Uche Odiatu	Zen Body 60	8 - 9 a.m.
Sa271 GWCC/A303	Dr. Tom McDonald	Staging Complex Restorative Cases: Putting Things in the Proper Order	8:30 - 11 a.m.
Sa272 Omni/International Ballroom F	Ms. Nancy Dewhirst	Annual OSHA Training and Infection Control: Are We Safe "Enough?"*	8:30 - 11:30 a.m.
Sa273 GWCC/A314	Dr. Gerry Kugel	The Dos and Don'ts of Porcelain Laminate Veneers	8:30 - 11:30 a.m.
Sa274 Omni/Maple	Dr. Jeff Pafford	Understanding and Managing Root Resorption*	8:30 - 11:30 a.m.
Sa275 Omni/Walnut	Ms. Teresa Duncan	The Essential PPO Planning Workshop	9 - 11:30 a.m.
Sa276 GWCC/A409	Mr. Steve Anderson	Why Dental Teams Fail: Lessons from the Most Successful Practices who Adapt, Pivot and Change in a Dynamic World	9 a.m. - 12 p.m.
Sa277 GWCC/A401	Dr. Lee Brady	Occlusion in Everyday Dentistry	9 a.m. - 12 p.m.
Sa278 Omni/International Ballroom AB	Dr. Mark Hyman	The Questions You Hate and the Answers You'll LOVE: A Guide for Dealing with Difficult Patients	9 a.m. - 12 p.m.
Sa279 GWCC/A310	Dr. Hal Crossley	Opioid Use, Misuse, Abuse and Addiction: Appropriate Opioid and Non-Opioid Prescribing*	9:30 - 11:30 a.m.
Sa280 Omni/Sycamore	Mr. Kevin Henry	Avoiding the Turnover Wheel: Finding, Hiring and Retaining an Amazing Post-Pandemic Team	9:30 - 11:30 a.m.
Sa281 GWCC/A408	Dr. Susan Maples	Breathe Well, Little One! Pediatric Airway from Cradle to Commencement	9:30 a.m. - 12:30 p.m.
Sa282 Omni/Hickory	Dr. Jay Smith	Prosthetic "Pearls" for Enhanced Efficiency in Implant Dentistry	9:30 a.m. - 12:30 p.m.
Sa283 Omni/Chestnut	Ms. Karen Davis & Dr. Witt Wilkerson	Optimal Sleep to Optimal Perio	12 - 3 p.m.
Sa284 GWCC/A304	Ms. Grace Rizza	Social Media Marketing That Works*	12:30 - 2 p.m.
Sa285 Omni/International Ballroom C	Mr. Tom Viola	"Mysteries of the Medical History!": Every Dental Professional's Toolkit in Successfully Interpreting a Patient's Medical History	12:30 - 3:30 p.m.
Sa286 GWCC/A401	Dr. Uche Odiatu	Great Guts: What Every Dental Professional Needs to Know about the Human Microbiome	1 - 3 p.m.
Sa287 Omni/Hazelnut	Dr. Jeff Pafford	Pain, Testing and Diagnostics: How to Get it Right the First Time*	1 - 3 p.m.
Sa288 Omni/Maple	Dr. Ken Berley & Ms. Patty Berley	Billing Medical Insurance and Medicare: How Do We Get Paid?	1 - 4 p.m.
Sa289 GWCC/A406	Dr. Rick Cardoza	Dentistry's Role in the Mass Disaster Scenario/Child Abuse and Intimate Partner Violence Recognition	1 - 4 p.m.

COURSE BUILDING/ROOM	SPEAKER	TITLE	TIME
Sa290 GWCC/A409	Dr. Greg Psaltis & Ms. Mary Ellen Psaltis	Problem Parents? No Problem!	1 - 4 p.m.
Sa291 Omni/International Ballroom AB	Dr. Lee Brady	Top Clinical Tips for Esthetic Success*	1:30 - 4 p.m.
Sa292 GWCC/A406	Dr. Mitch Gardiner	The Periodontal Ligament Injection for Mandibular Local Anesthesia: Say Goodbye to the Mandibular Block for Most of Your Restorative Dentistry	9 - 10:30 a.m.
Sa354 GWCC/A407	Ms. Carol Paige	Interviewing: Best Practices, Best Results!	8 - 11 a.m.
Sa355 Omni/Grand Ballroom A-D1	Dr. John Svirsky	A Patient Can Have as Many Diseases as THEY Pleases	8:30 - 11 a.m.
Sa356 GWCC/A304	Pre-Dental Society	9 - 11 a.m.	
Sa357 Omni/Hazelnut	Dr. Pat Little	A Secret Pay Raise: How Embezzlers Think and Act	9 - 11 a.m.
Sa358 GWCC/A312	Ms. Laci Phillips Newland	Leading Through the Disruption: Five Keys to Great Leadership*	9 - 11 a.m.
Sa359 GWCC/A305	Ms. Penny Reed	The Unstoppable Dental Team	9 - 11 a.m.
Sa360 GWCC/A412	Dr. Rick Cardoza	Dispelling the "CSI Effect" Myth: An Overview of Contemporary Forensic Dentistry	9 a.m. - 12 p.m.
Sa361 Omni/International Ballroom E	Dr. Van Haywood	Occlusal Adjustment Techniques: Limited and Complete	9:30 - 11 a.m.
Sa362 Omni/International Ballroom C	Ms. Grace Rizza	Attracting High-Quality New Patients	9:30 - 11 a.m.
Sa363 GWCC/A302	Dr. Larry Williams	Geriatric Dentistry: Treatment Planning, Treatment Concerns and Communication*	9:30 a.m. - 12:30 p.m.
Sa364 GWCC/A402	Dr. Dan Dunwoody	Outside-In Facial and Oral Examination	10 a.m. - 12 p.m.
Sa365 Omni/International Ballroom D	Dr. Uche Odiatu	Maximum Immunity: Fortify Your Body's Natural Defenses!*	10 a.m. - 12 p.m.
Sa366 GWCC/A313	Ms. Carol Paige & Ms. Christy Ratcliff	Thrive! Staying Vital as Mom, Dentist, Partner and...YOU! A Women's Networking and Panel Discussion	12 - 1:30 p.m.
Sa367 GWCC/A305	Dr. Brian Novy	Offensive Dentistry	12:30 - 3 p.m.
Sa368 Omni/Grand Ballroom A-D1	Ms. Amber Auger	You Are What You Eat! Is Your Patient Feeding the Periodontal Pathogens?	1 - 2:30 p.m.
Sa369 GWCC/A303	Ms. Laci Phillips Newland	Constantly Plugged In and Desperately Seeking Balance	1 - 2:30 p.m.
Sa370 GWCC/A412	Dr. Hal Crossley	Marijuana's Coming to Town: Will You Be Ready?	1 - 3 p.m.
Sa371 GWCC/A312	Dr. Pat Little	HIPAA Security Rule, Data Breaches and Identity Theft: Don't Get Bitten*	1 - 3 p.m.
Sa372 GWCC/A410	Dr. Neil Warshawsky	Going Digital: How to Learn to Make the Jump from Analog to Digital	1 - 4 p.m.
Sa373 GWCC/A310	Mr. Kevin Henry & Ms. Penny Reed	Podcasting 101: Answering Your Questions About Going "On the Air"	1:30 - 3:30 p.m.
Sa374 GWCC/A407	Ms. Christy Ratcliff	Valuation 101: Knowing the Basics of How Your Practice is Valued	2 - 3:30 p.m.
Sa509 GWCC 	Dr. Wayne Kerr	When Life Needs a Sticky Note	10 - 11 a.m.

Virtual Courses

As part of your in-person registration fee, you have access to complimentary virtual CE. Log into your Hinman registration to view the below courses and earn an additional five hours of self-instruction CE!"

5 HOURS of complimentary virtual CE

Dr. Lee Silverstein

Vr600 | The Teeth Express Process for the Restorative Dentist

Dr. Ken Berley

Vr601 | Dental Sleep Medicine: A Required Course

Mr. Charles Loretto

Vr602 | Key Financial Decisions for Practice Owners

Ms. Carol Paige

Vr603 | Staffing: Aim Right to Hire Right

Vr604 | Exhibitor New Product Showcase

AVAILABLE NOW until May 31, 2022





Pavilion Schedule

Plan to stop by the Learning Lab Pavilion in the Exhibit Hall to hear these seminars.
Earn one hour of CE for each hour of attendance. Courses will be held near Booth 205.

	SPEAKER	COURSE TITLE	TIME
THURSDAY	Ms. Susan Wingrove Presented by Crest Oral-B 	Th550 No Fee Disrupt, Debride and Detoxify: Implant Maintenance and Disease Treatment	3:30 – 4:30 p.m.
		Th122 No Fee Preventive Equipment Maintenance	9:30 – 10:30 a.m.
FRIDAY	Ms. Susan Wingrove Presented by Crest Oral-B 	Fr551 No Fee Disrupt, Debride and Detoxify: Implant Maintenance and Disease Treatment	9:30 – 10:30 a.m.
		Fr552 No Fee New Product Symposium	11 a.m. – 12 p.m.
		Fr138 No Fee Preventive Equipment Maintenance	1:30 – 2:30 p.m.

Crest + Oral-B
Booth 1105

Tokuyama America
Booth 1821

OraCare
Booth 1924

Pharmacists Mutual
Insurance Company
Booth 1716

The Smile Defenders
Booth 1827

Sunbit
Booth 1231

Name Badge Updates

Your ticket summary does not contain the room locations. The locations are available at Hinman.org, on the APP or in this publication.

BARCODE:

This code contains your contact information. Exhibitors will scan this barcode when you visit their booths.

We'll send you an email after the Meeting with a list of all the booths you visited!

BADGE NUMBER:

You will need this number to access your registration account, redeem CE and to log into the Hinman APP.

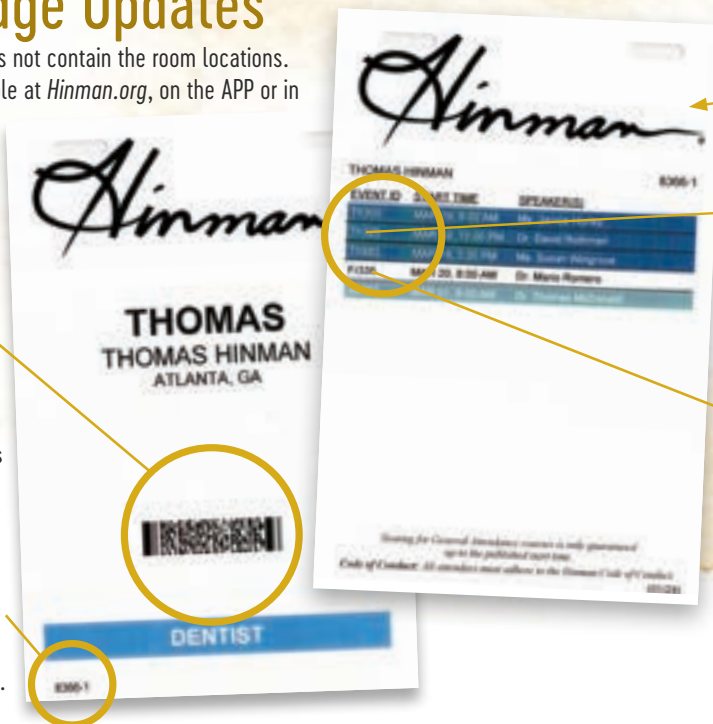

This is your ticket summary

EVENT ID:

Th for Thursday
Fr for Friday
Sa for Saturday

The number tells you about the type of course:

- 100 (participation course)
- 200 (registered attendance lecture and interactive course)
- 300 & 500 (general attendance lecture)
- 400 (special event)



Pavilion Schedule

Plan to stop by the Total Health Pavilion in the Exhibit Hall to hear these seminars related to nutrition and health. Earn one hour of CE for each hour of attendance. Courses will be held near Booth 1553.

THURSDAY		FRIDAY
10 – 11 a.m.	Ms. Mary Ellen Psaltis Th501 What's Disrupting Your Health?	Dr. Susan Maples Fr505 Slaying Dragons: Acid Reflux and Diabetes Detection in the Dental Office
11 a.m. – 12 p.m.		Ms. Mary Ellen Psaltis Fr506 Add Up Your Numbers
12 – 1 p.m.	Dr. Ellen Daley Th502 HPV and Oropharyngeal Cancer: An Update on an Emerging Dental and Public Health Issue	
1 – 2 p.m.	Mr. Tom Viola Th503 “Sugar? Yes, Please!”: How Will You Successfully Treat Your Patient With Diabetes?	Ms. Mary Ellen Psaltis Fr507 Aging with Power
2 – 3 p.m.	Dr. John Svirsky Th504 For the Fun of It: Human Papilloma Virus in 2022	
3:30 – 5 p.m.		Dr. Uche Odiatu Fr508 Nutrition Essentials for Optimal Health
SATURDAY		
10 – 11 a.m.	Dr. Wayne Kerr Sa509 When Life Needs a Sticky Note	

Stop by for a free cup of gourmet coffee!

Gourmet Coffee Station
Thursday and Friday from 2 – 5 p.m.
Saturday from 10 a.m. – 12 p.m.

Courtesy of
HEARTLAND
DENTAL

CardioRisk Laboratories
At the Heart of Good Health

Stop heart attacks and strokes before they occur. Book a CIMT scan via the **Hinman APP (Exhibit Hall icon)** or in the Total Health Pavilion.

Time slots are limited so please book in advance. This 10-minute ultrasound procedure on your neck can save your life.

Receptions & Gatherings

ALUMNI RECEPTIONS

Dental College of Georgia

Event Fr457 - Alumni Reception

Friday, March 18, 5 – 7 p.m.

Hudson Grille, 120 Marietta Street NW

Kim Koss | kkoss@augusta.edu | 706-723-0140

Emory Dental Association

Event Fr450 - Emory Dental Reception

Friday, March 18, 5:30 – 7 p.m.

Omni Hotel - International AB

Ruthy Cunningham | ruth.cunningham@emory.edu | 404-825-6348

The Ohio State University – College of Dentistry

Event Fr459 - Alumni and Friends Reception

Friday, March 18, 5:30 – 7 p.m.

Omni Hotel - International C

Ted Backus | backus.30@osu.edu | 614-292-9307

University of Alabama Birmingham - School of Dentistry

Event Fr451 - Reception

Friday, March 18, 5:30 – 7 p.m.

Omni Hotel - Pecan Foyer

Abby Vinson | abbyv@uab.edu | 205-934-3575

University of Kentucky – College of Dentistry

Event Fr452 - Alumni Reception

Friday, March 18, 5:30 – 7 p.m.

Omni Hotel – International D

Ryan Vicini | rlvici2@uky.edu | 859-323-6676

University of Louisville – School of Dentistry

Event Fr453 - Reception

Friday, March 18, 5:30 – 7 p.m.

Ruth's Chris Steakhouse

Fran Williams | fran.williams@louisville.edu | 502-852-5077

University of North Carolina – School of Dentistry

Event Fr456 - Alumni Reception

Friday, March 18, 5:30 – 7 p.m.

Omni Hotel - Grand Ballroom Pre-Function

Kaylee Cutler | kayleec@unc.edu | 919-537-3895

University of Tennessee Health Sciences Center – College of Dentistry

Event Fr458 - Alumni and Friends Reception

Friday, March 18, 5 – 7 p.m.

Omni Hotel - International E

Terri Catafygiotu | tcatafyg@uthsc.edu | 901-448-8580

Virginia Commonwealth University – School of Dentistry

Fr454 - Alumni, Student and Friends Reception

Friday, March 18, 5:30 – 7 p.m.

Omni Hotel - International F

Gloria Callihan | gfcallihan@vcu.edu | 901-604-1078

ACCREDITATION & CONTINUING EDUCATION CREDIT

The Thomas P. Hinman Dental Meeting has carefully selected all lecturers, exhibits and exhibitors to present at the 2022 Hinman Dental Meeting. The contents of any particular program, lecture, exhibit or handout are the responsibility of the respective lecturer or exhibitor presenting such material. The Hinman Dental Society does not endorse or approve any materials so presented.

The Hinman Dental Meeting utilizes a computerized accreditation process. Hinman provides one hour of credit for each hour of lecture, unless indicated under the course description. Use your name badge and four-digit completion code to process your CE credit while onsite.

Continuing education credits can be processed and certificates printed during the Meeting:

- 1) **Exhibit Hall CE Printing Station**
[located by Eatery #1]
Saturday: 1 – 5:30 p.m.
Friday: 9:30 a.m. – 6 p.m.
Saturday: 9:30 a.m. – 3 p.m.
- 2) **Registration Hall**
Thursday: 9:30 a.m. – 5 p.m.



The Thomas P. Hinman Dental Meeting
Nationally Approved PACE Program
Provider for FAGD/MAGD credit.
Approval does not imply acceptance by
any regulatory authority or AGD endorsement.
6/1/2021 to 5/31/23
Provider ID# 219082



Avoid the lines!
Verify your CE in the Hinman APP and
email certificates to yourself for
printing at home.

BUSINESS CENTER

Georgia World Congress Center - A full-service business center, operated by FedEx Kinkos, is located inside the main entrance of the GWCC.
Wednesday, March 16 – Friday, March 18, Hours: 8 a.m. – 5 p.m. | Saturday, March 19, Hours: 8 a.m. – 6 p.m.

Omni Hotel - A full-service business center, operated by FedEx, is located in the South Tower next to the Oak Room.
Wednesday, March 16 – Friday, March 18, Hours: 7 a.m. – 6 p.m. | Saturday, March 19, Hours: 10 a.m. – 4 p.m. Hotel guests have keycard access
24 hours a day / 7 days a week.

HINMAN CODE OF CONDUCT

As a professional organization, The Hinman Dental Society of Atlanta, Inc. [the “Society”] insists upon maintaining an atmosphere of decorum, courteousness and professionalism. **The Society is dedicated to providing a safe, harassment-free and inclusive experience for all participants at all Society-organized events and has a zero-tolerance policy for harassment of participants in any form.** Participants include but are not limited to Society employees, members, attendees, guests, staff, speakers, sponsors, exhibitors, Advisory Committee members and Executive Council members. A Society-organized event includes business at the Society office as well as The Thomas P. Hinman Dental Meeting and official social events and receptions, the Hinman Annual Meeting and other membership meetings, board meetings, committee meetings and any other event for which attendees are asked to RSVP or register through the Society.

Harassment includes but is not limited to offensive comments or gestures related to gender, gender identity, age, sexual orientation, disability, physical appearance, race, ethnicity or religion. **Harassment also includes but is not limited to** intimidation, bullying, stalking, following, harassing photography or recording, sexual images in public spaces, sustained disruption of presentation or other event, inappropriate physical contact and unwelcome sexual attention. Harassment can occur in real or virtual space, including social media related to a Society-organized event.

If you observe or experience harassing behavior that you believe is in violation of the Code of Conduct, **please report the incident immediately** to the Hinman office at (404) 231-1663 and ask to speak to either the President or the Executive Director regarding an incident of harassment. The Society will take every complaint seriously and investigate each complaint promptly, thoroughly and impartially. All complaints will be handled as confidentially as possible. The Society reserves the right to determine, in its sole discretion, whether any behavior at any Society-organized event is unacceptable and in violation of this Code of Conduct. In the event that it is determined that an individual has violated this Code of Conduct or has otherwise engaged in conduct that is deemed to be improper, prejudicial or detrimental, the Society reserves the right to discipline such individual, including but not limited to (1) removing any such individual from the event or meeting with no refund of any fees paid, (2) barring any individual from attending future Society events or meetings, and/or (3) suspending any such individual’s Society membership or terminating any such individual’s Society membership with no refund of any dues paid, or any other disciplinary action authorized under Article III, Section 8 of the Bylaws.

The Society shall have no liability whatsoever arising out of its interpretation and enforcement of the Code of Conduct.



Booth 1049

Head to Booth 1049 to tune in as these popular dental podcasters record episodes LIVE from the Exhibit Hall.

The Podcast Lounge is also a great place to relax after a busy day or to catch up with friends. See you there!

THURSDAY

A Tale of Two Hygienists 9:30 a.m. – 1 p.m.
with Andrew Johnston & Michelle Strange

Chew on This with Teresa Duncan & Kevin Henry 2 – 5 p.m.

Dental Assistant Nation with Kevin Henry

Nobody Told Me That! with Teresa Duncan

FRIDAY

Just DeW It 9:30 a.m. – 12:30 p.m.
with Anne Duffy

Growing Your Dental Business 1 – 3 p.m.
with Penny Reed

Bulletproof Dental Practice 3:30 – 6 p.m.
with Dr. Peter Boulden & Dr. Craig Spodak

SATURDAY

Transition Talk 9:30 – 11 a.m.
with Charles Loretto & Christy Ratcliff

Bulletproof Dental Practice 12 – 3 p.m.
with Dr. Peter Boulden & Dr. Craig Spodak

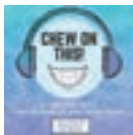

2022 SHUTTLE SCHEDULE

Every 10-15 Minutes

Thursday, March 17	7 a.m. – 8 p.m.
Friday, March 18*	7 a.m. – 7 p.m.
Saturday, March 19	7 a.m. – 5:30 p.m.

Route 1

Westin Peachtree Plaza	Spring Street Motor Lobby
Holiday Inn Downtown Express & Suites	Board at Westin
Hotel Indigo	Board at Westin
The American, a Doubletree by Hilton	Board at Westin
AC Hotel Downtown	Board at Westin

Route 2

Aloft	In front of hotel - Baker Street
Atlanta Marriot Marquis	Corner of Baker & Peachtree Center
Hilton Atlanta	NE Corner, Baker & Courtland
Hilton Garden Inn Downtown	In front of hotel - Baker Street
Hyatt Place Atlanta Downtown	Board at Hilton Garden Inn
Hyatt Regency Atlanta	NE Corner, Baker & Peachtree

Route 3

Ritz-Carlton, Atlanta	Ellis & Peachtree (opposite side of street)
Courtyard Atlanta Downtown	Board at Ritz
Sheraton Atlanta	Andrew Young & Courtland (across street)

*Shuttle service runs from the above hotels (and the Omni) to the Tabernacle, to service the Hinman's Night Out party, from 7 – 11 p.m.

AUDIO, PHOTO AND VIDEO DISCLAIMER

Photographs, audio recordings and videos may be taken during the meeting by Hinman and approved media representatives and contractors. When registering for the meeting, exhibitors and attendees grant Hinman, its subsidiaries and affiliated entities, approved media and their respective employees and agents, the irrevocable right and permission to use any such photograph, audio recording and video taken during the meeting, for purposes of news reporting, promotion and advertising and trade in any medium or context now known or later developed, without further authorization.

COURSES LOCATED ON THE EXHIBIT FLOOR

Course Room 1	Ms. Marianne Dryer Th107 9 – 11 a.m. Dr. Howard Glazer Th117 1 – 4 p.m.	Dr. Anthony Cardoza Fr132 10 a.m. – 12 p.m. Fr141 2:30 – 4:30 p.m.	
Course Room 2	Dr. Kevin Suzuki Th104 8 – 11 a.m. Th113 12 – 3 p.m.		
Course Room 3	Dr. Amy Kuhmichel Th118 1 – 4 p.m.	Dr. Amy Kuhmichel Fr130 9:30 a.m. – 12:30 p.m. Fr140 2 – 5 p.m.	Dr. Amy Kuhmichel Sa150 10 a.m. – 12 p.m.
Course Room 5	Dr. Mike Pruett Th102 8 a.m. – 3 p.m.	Dr. Mike Pruett Fr124 8 a.m. – 4 p.m.	
Course Room 6	Ms. Nancy Dewhirst Th106 8:30 – 11:30 a.m. Dr. Lee Silverstein Th120 1:30 – 4 p.m.	Dr. Lee Silverstein Fr131 9:30 a.m. – 12:30 p.m. Fr139 2 – 4:30 p.m.	Dr. Lee Silverstein Sa149 9 – 11:30 a.m. Sa152 1 – 3 p.m.

Expand Your Horizons

20

23

Hinman[®]
Explore Your Future

March 16 -18, 2023 | Atlanta

110th Thomas P. Hinman Dental Meeting

Georgia World Congress Center & Omni Hotel at CNN Center

Dr. Roy A. McDonald, General Chair | Dr. E. David Anderson, President



2023 HOTEL RATES

HOTEL	STARTING RATE
AC Hotel Atlanta Downtown	\$.235
Aloft Atlanta Downtown	\$.199
American Hotel Atlanta Downtown - a Doubletree by Hilton	\$.219
Atlanta Marriott Marquis	\$.221
Courtyard Atlanta Downtown	\$.214
Embassy Suites Atlanta at Centennial Park	\$.249
Glenn Hotel	\$.245
Hilton Garden Inn Atlanta Downtown	\$.236
Holiday Inn Express	\$.189
Hyatt Place Centennial Park	\$.229
Omni Hotel at CNN Center	\$.229
The Sheraton.	\$.203
Springhill Suites Atlanta Downtown	\$.209
Ritz-Carlton, Atlanta	\$.252
Westin Peachtree Plaza	\$.217

Book your hotel room for Hinman 2023

while you are onsite at Hinman 2022 (with our official housing provider, Hinman Housing Powered by Eventsphere) **and be eligible to win** one of the prizes listed below.

Book on Thursday, March 17 and be entered for a chance to win:

- One (1) complimentary three (3) night stay at Hinman 2023.
- One (1) complimentary three (3) night stay at any Marriott property in the Continental U.S.
- One (1) complimentary five (5) night stay at any Marriott property in the Continental U.S.

Book on Friday, March 18 and be entered for a chance to win one (1) complimentary three (3) night stay at Hinman 2023.

Book on Saturday, March 19 and be entered for a chance to win one (1) complimentary three (3) night stay at Hinman 2023.

The housing desk is located at the top of the escalators going into the exhibit hall (outside of room A308).

2023 SPEAKERS*

Ms. Amber Auger Periodontal Disease	Dr. Joel Laudenbach Oral Medicine/Biopsy Techniques
Dr. Shahrokh Bagheri Oral Surgery	Dr. Sam Low Periodontics
Ms. Lois Banta Practice Management	Ms. Lisa Mallonee Nutrition & Oral Health
Mr. Kirk Behrendt Motivation/Communication	Dr. Glenn Maron Medical Emergencies
Dr. Lee Ann Brady Aesthetics & Functional Treatment Planning	Mr. John McGill Practice Management & Accounting
Dr. Gordon Christensen Prosthodontics	Dr. Gigi Meinecke Facial Injectables
Mr. Bruce Christopher Motivation/Communication	Dr. Michael Melkers Occlusion/Communication
Dr. David Clark Composites	Dr. Ben Miraglia Orthodontics/Airway Issues
Dr. Hal Crossley Pharmacology	Dr. Mark Murphy Sleep Apnea/Practice Success
Ms. Nancy Dewhirst OSHA/Clinical Safety	Dr. Linda Niessen Aging & Oral Health
Dr. John Droter TMJ	Dr. Jeff Okeson TMD & Orofacial Pain
Dr. Greg Folse Removable Prosthetics	Dr. Mike Pruett Implants/Conscious Sedation
Dr. Mark Hyman Management & Leadership	Ms. Minal Sampat Social Media
Ms. Jo-Anne Jones Oral Cancer/Systemic Health/Periodontics	Dr. Lee Silverstein Oral Surgery
Dr. Wayne Kerr Life Skills, Inspiration & Motivation	Dr. John Svirsky Pathology
Dr. Kevin Kwiecien Digital Dentistry/Treatment Planning	Mr. Tom Viola Pharmacology

*Visit Hinman.org on June 1 to see complete list of speakers.

Thank you to our Hinman Dental Meeting Committee Chairs!

Advisory

Dr. Bob O'Donnell

Arrangements

Dr. Evis Babo
Dr. Cristi Cheek

Clinic Captains

Dr. Neil Browning
Dr. Melissa Durand
Dr. Matt Mazzawi

Closing Session

Dr. Steve Rafeedie

Continuing Education

Dr. Dan Hodges

Finance

Dr. Jim Roos

Hinman Information

Dr. Lauren Bowersox
Dr. David Marion
Dr. Jeremy Ward

Hinman's Night Out

Dr. Ken Berger
Dr. Michael Long
Dr. Lindsay Pope

Hospitality

Dr. Bruce Ashendorf
Dr. Billy Callahan
Dr. Tom Callahan
Dr. Pat Yancey, III

Host

Dr. Sedgie Newsom

Keynote Session

Dr. Dave Lee

Participation

Dr. Rod Carter
Dr. Lauren Freitag
Dr. Patrick French
Dr. Andy Ramsey
Dr. Brett Schroeder

Pre-Keynote

Dr. Sidney Tourial

Program

Dr. Randy Phillips
Dr. Jim Roos

Publications

Dr. Janine Bethea
Dr. Darryal McCullough

Public Relations

Dr. Brook Corbett
Dr. Shiven Gandhi

Registration

Dr. Kristina Dawson
Dr. Ben Hawkins

Reserve

Dr. Slade Lail

Signs

Dr. Sherry Jordan
Dr. Anna Schultz

Special Events

Dr. Robby Robinson
Mrs. Beth Rousseau

Table Clinics

Dr. Jim Granade, III

Technical Exhibits

Dr. Brad Greenway
Dr. Jane Puskas

Transportation

Dr. Henry Benson, Jr.
Dr. Bobby Shirley

Treasurer

Dr. David Anderson

OMNI ATLANTA HOTEL AT CNN CENTER SOUTH TOWER

OMNI  HOTELS
& RESORTS
cnn center | atlanta

ATRIUM TERRACE LEVEL (AT)

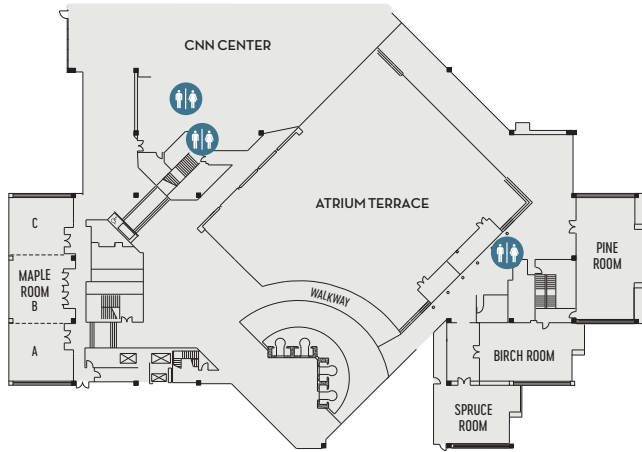

HOTEL LOBBY LEVEL

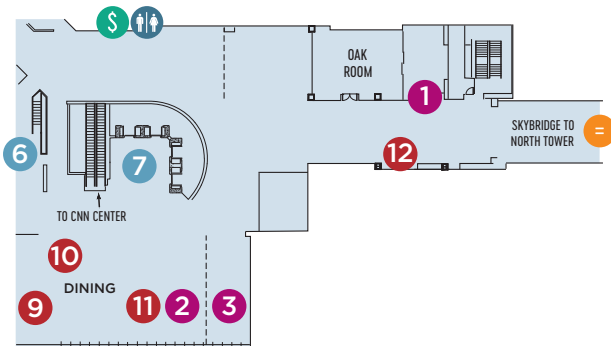

MOTOR LOBBY LEVEL (ML) & ACCESS TO CNN ATRIUM

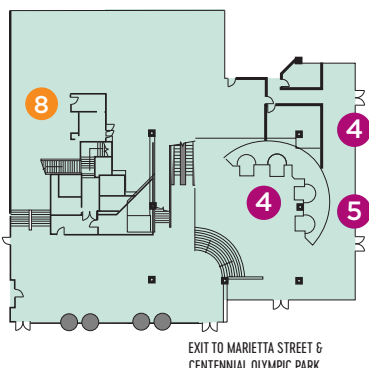

SERVICES

- 1 FedEx Office Business Center
- 2 Gift Shop
- 3 Front Desk
- 4 Valet
- 5 Bell Service

ELEVATORS

- 6 ADA Elevator
- 7 Guest Room Elevators (Hotel Lobby, Motor Lobby)

LANDMARKS

- = Skybridge
- 8 Walkway to CNN Food Court, State Farm Arena & Public Transportation

DINING

- 9 New South Kitchen
- 10 Vues Lobby Bar
- 11 Centennial Grounds
- 12 Top Draft

 ATM

 RESTROOMS

NOW OPEN

Omni Atlanta Hotel at CNN Center has completed the South Tower renovation, offering guests a transformed arrival and lobby experience and four brand-new dining options.

OMNI ATLANTA HOTEL AT CNN CENTER NORTH TOWER

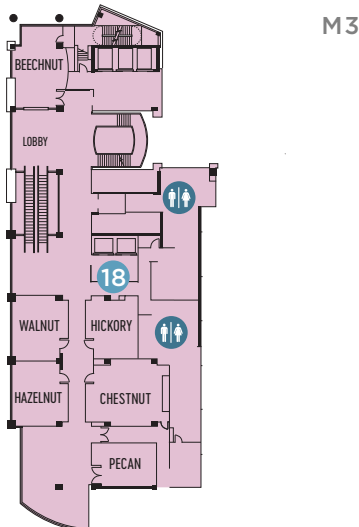
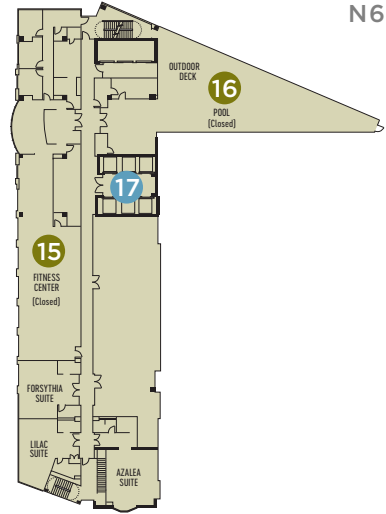
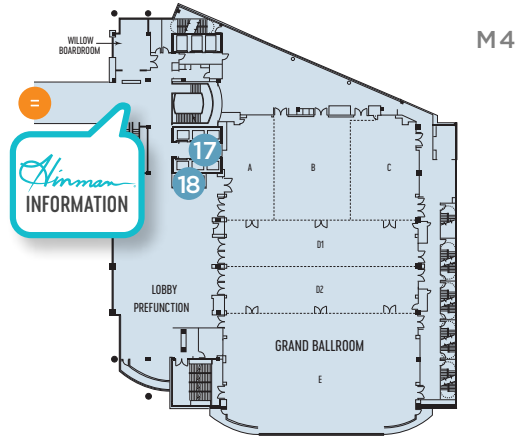

SERVICES	LANDMARKS
13 Bell Services	= Skybridge
14 Valet	19 Walkway to Georgia World Congress Center & College Football Hall of Fame
RECREATION & ACTIVITIES	
15 24-Hour Fitness Center (Closed)	
16 Pool (Closed)	
	\$ ATM
ELEVATORS	RESTROOMS
17 Guest Room Elevators (M1, M4, N6 - 28)	
18 Meeting Room Elevators (M1 - M4)	



what's happening IN THE EXHIBIT HALL

EXHIBIT HALL HOURS

Thursday, March 17

9:30 a.m. Hall Opens
 10 a.m. – 1 p.m. Table Clinics
 11 a.m. – 3 p.m. Eatery Hours
 2 – 5 p.m. Table Clinics
 3 – 5 p.m. Exhibit Only Hours
 5 p.m. Hall Closes

Friday, March 18

9:30 a.m. Hall Opens
 11 a.m. – 3 p.m. Eatery Hours
 10:30 a.m. – 1:30 p.m. . . . Table Clinics
 3 – 6 p.m. Table Clinics
 5 – 6 p.m. Exhibit Only Hours
 6 p.m. Hall Closes

Saturday, March 19

9:30 a.m. Hall Opens
 10 a.m. – 2 p.m. Eatery Hours
 10 a.m. – 1 p.m. Table Clinics
 3 p.m. Hall Closes



Learning Lab - Booth 205

Stop by for complimentary exhibitor-presented CE in the Exhibit Hall.

Don't miss our featured course, **Crest + Oral-B** presented by Crest + Oral-B. Susan Wingrove will speak on Thursday, 3:30 p.m. – 4:30 p.m. and Friday, 9:30 a.m. – 10:30 a.m.



Hinman Marketplace

Relax and unwind with some well-deserved retail therapy at the Hinman Marketplace! Check out non-dental-related exhibitors (Booths 450 – 650). The Hinman Marketplace will be open each day. Stop by while you are in the hall or on your way to or from your courses.

The Hinman Shop

Take Hinman home with you! Stop by the Hinman Shop, located in the Exhibit Hall Booth 557.

Proceeds from the store will be used by the Hinman Trustees for scholarships to support the future of dentistry. A variety of items are for sale, including t-shirts, water bottles, tote bags, baby onesies, teddy bears...and more!!!

Podcast Lounge - Booth 1049

Sit back and take a break while you listen to these popular dental podcasters, recording episodes LIVE from Hinman! Recharge your device and regroup after a busy day at the Meeting in this comfortable lounge.



- > **A Tale of Two Hygienists** with Mr. Andrew Johnston & Ms. Michelle Strange
- > **Bulletproof Dental Practice** with Dr. Peter Boulden & Dr. Craig Spodak
- > **Chew on This** with Ms. Teresa Duncan & Mr. Kevin Henry
- > **Dental Assistant Nation** with Mr. Kevin Henry
- > **Growing Your Dental Business** with Ms. Penny Reed
- > **Just DeW It** with Ms. Anne Duffy
- > **Nobody Told Me That!** with Ms. Teresa Duncan
- > **Transition Talk** with Mr. Charles Loretto & Ms. Christy Ratcliff

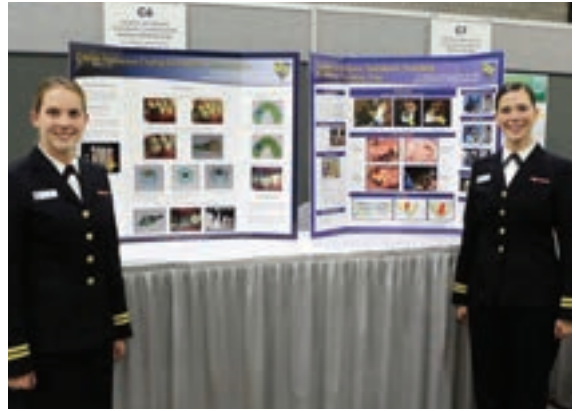

Table Clinics - Back of 1900 aisle

Earn free CE at these scientific table-top presentations that are each approximately 10 minutes in length and are given by volunteers in the dental community. Receive a continuing education code for each hour that you spend in the table clinics area.

Total Health Pavilion - Booth 1555

Stop by to get a free gourmet coffee from Heartland Dental. The coffee bar hours are Thursday and Friday 2 – 5 p.m. and Saturday 10 a.m. – 12 p.m.



CardioRisk is back by popular demand to provide CIMT testing. Go to the pavilion to make your appointment today.



Complimentary CE offered daily [see page 13].



Popsicle Break - Booth 1231



Pop in for a cold, sweet treat. Sunbit is offering complimentary popsicles on Thursday and Friday starting at 3 p.m. while supplies last.



Social Media Lounge - Booth 2147

Visit the new Social Media Lounge, located near the Table Clinics on the right side of the hall. Stop by to take a selfie with the life-sized Hinman Signature. Post, hashtag and tweet to show the fun you are having at this year's Hinman. Don't forget to use **#myhinman**. As a bonus, DentalCast Productions will be live streaming in the lounge.

Lounge brought to you by



DENTALINTELLIGENCE



EXHIBIT HALL Floor Plan

672	674	676	772	774	874	873
-----	-----	-----	-----	-----	-----	-----

Exhibitor Lounge



COURSE ROOM #3

COURSE ROOM #4

COURSE ROOM #5

CE Redemption

HINMAN MARKETPLACE

The Hinman Shop

957

450	650
-----	-----

Only Entrepreneurs

PODCAST LOUNGE

646
644
642
640

647	746
645	744
643	742
641	740

743	842
741	840

853	952
851	950
849	848
847	846
845	844
843	944 & Quality
841	840

959	1052
951	1050
949	1048
947	1046
945	1044
943	1042
941	RGP Dental

Porter Royal Sales

1149	1248
1147	1246
1145	1244
1143	1242
1141	1240

1249	1348
1247	1346
1245	1344
1241	1342
1241	1340

COURSE ROOM #2

COURSE ROOM #1

634
632
630
628
626
624
622
620

635	734
633	732
631	730
629	728
627	726
625	724
623	722
621	720

735	834
733	832
731	830

Weave	
833	
831	930
829	928
827	926
825	924
823	922
821	920

Biotech Dental
formerly
Integrated
Dental Systems

935	1034
933	1032
931	1030
929	1028
927	1026
925	1024
923	1022
921	1020

1035	1134
1033	1132
1031	1130

1125	1224
1123	1222
1121	1220

1135	1234
1133	1232
1131	1230
1129	1228
1127	1226
1125	1224
1123	1222
1121	1220

1235	1332
1231	1330
1229	1328
1227	1326
1225	1324
1223	1322
1221	1320



616
614
612
610
608
606
604

617	716
615	714
613	
611	Ritter Dental USA
609	
607	
605	704

717	816
715	814
713	812

817	916
815	914
813	912
811	910
809	908
807	906
805	Salvin Dental

806	906
805	904

917	1016
913	1012
911	1010
909	1008
907	1006
905	1004

1017	1114
1015	1112
1013	1110

1109	1208
1107	1206
1105	

1115	1210
1113	1208
1111	1206
1109	1204
1107	1202
1105	1200

1211

700	701	800	801
-----	-----	-----	-----

1000	1002	1001	1000	Atlantic	1101
------	------	------	------	----------	------



EXHIBITORS

by Product Category

ABRASIVES, ABRASIVE DISKS, POINTS & WHEELS

Shofu Dental Corporation 1322

AIR ABRASION

LabStore 1211
Medidenta 1020

AIR COMPRESSORS

ADS Dental System Inc. 1228
Air Techniques, Inc. 1940
Aseptico, Inc. 1340
Dansereau Health Products 840
Dental Equipment Liquidators, Inc. 1702
DentalEZ 1441
Nashville Dental Inc. 1429
Professional Sales Associates, Inc. 1441
Ritter Dental USA 704
Sunrise Dental Equipment, Inc. 1532
Superior Dental Design & Upholstery 801

ALLOYS

Argen Refining 1229
Georgia High Tech Dental Lab Inc. 1730

AMALGAM

Academy of General Dentistry 1246
M.A.R.S Bio-Med Processes Inc. 1004

AMALGAMATORS

Academy of General Dentistry 1246

ANALGESIA EQUIPMENT & SUPPLIES

Porter Royal Sales 1041
Professional Sales Associates, Inc. 1441

ANALGESICS

StellaLife 1227

ANATOMICAL MODELS

Georgia High Tech Dental Lab Inc. 1730
Kilgore International, Inc. 1234

ALLOYS

Argen Refining 1229
Georgia High Tech Dental Lab Inc. 1730

AMALGAM

Academy of General Dentistry 1246
M.A.R.S Bio-Med Processes Inc. 1004

AMALGAMATORS

Academy of General Dentistry 1246

ANALGESIA EQUIPMENT & SUPPLIES

Porter Royal Sales 1041
Professional Sales Associates, Inc. 1441

ANALGESICS

StellaLife 1227

ANATOMICAL MODELS

Georgia High Tech Dental Lab Inc. 1730
Kilgore International, Inc. 1234

ANESTHESIA EQUIPMENT

CMI Health Inc. 1829
Onpharma Company 1131

ANESTHETICS, LOCAL & ACCESSORIES

Aseptico, Inc. 1340
Onpharma Company 1131

ANTIBACTERIAL SOAPS & DETERGENTS

FiteBac Dental LLC 1709

APEX LOCATORS

J. Morita USA, Inc. 1240
Vector Research & Development 1100

ARTICULATORS & ACCESSORIES

Bausch Articulating Papers, Inc. 1244
LabStore 1211
VeriONE 1120
Whip Mix Corp. 1021

ATTACHMENTS

Dental Office Support 1125
Keating Dental Lab 1817

AUTOCLAVES

Atlanta Dental Supply 1211
Benco Dental 1833
Dental Equipment Liquidators, Inc. 1702
Midmark Corporation 1132
Nashville Dental Inc. 1429
SciCan / Coltene 1235
Sunrise Dental Equipment, Inc. 1532
Superior Dental Design & Upholstery 801
Tuttinauer USA Co., Ltd. 1441

BLEACHING PRODUCTS/TEETH WHITENING

Burst 1921
Colgate 1705
Crest + Oral-B 1105
DentLight Inc. 1100
Philips Sonicare and Zoom Whitening 1515
Top Quality Mfg., Inc. - Glove World 1109
Ultradent Products, Inc. 1621

BLOOD PRESSURE DIAGNOSTIC INSTRUMENTS

CardioRisk Laboratories 1657
CMI Health Inc. 1829

BONDING AGENTS

BISCO 1521
GC America, Inc. 1630
Pulpdent Corporation 1206
Tokuyama America 1821
Top Quality Mfg., Inc. - Glove World 1109
Ultradent Products, Inc. 1621

BONE GRAFTING MATERIALS, SYNTHETIC & IMPLANTS

HansBiomed USA 1714
Impladent Ltd. 1124
J. Morita USA, Inc. 1240
Nobel Biocare USA 1507
Power Dental USA 726
Salvin Dental 805

BOOKS & PUBLICATIONS PROFESSIONAL/SCIENTIFIC

Academy of General Dentistry 1246
Georgia Dental Hygienists' Association 744

BURS, ALL TYPES

Brasseler USA 1017
Coltene 1235
Golden Dent 1331
Impladent Ltd. 1124
Microcopy 1509
Shofu Dental Corporation 1322
Top Quality Mfg., Inc. - Glove World 1109

BUSINESS SERVICES

ADIT	735
Affinity Bank	1640
Bank of America Practice Solutions	1241
CardioRisk Laboratories	1657
CARR / Dental Real Estate	920
Cross Country Healthcare	716
Crown Tenant Advisors	935
Dental Office Support	1125
eAssist Dental Solutions	1333
Heartland Dental	1651
MGE Management Experts	834
PPM-Professional Practice Management	1211
PracticeLife	1211
Podium	1210
Simplifeye	1610
Scratch	830
Star Dental Partners	746
Transition Acceleration Group	1030
Weave	833

CABINETS

A-dec	1411
ADS Dental System Inc.	1228
Atlantic Dental Solutions	1100
DCI Edge	2031
Dental Equipment Liquidators, Inc.	1702
Midmark Corporation	1132
PLANMECA USA, Inc.	1115
Professional Sales Associates, Inc.	1441
Sunrise Dental Equipment, Inc.	1532
Superior Dental Design & Upholstery	801
Symmetry Dental Equipment Cabinetry	1100

CAD/CAM EQUIPMENT

Atlanta Dental Supply	1211
Benco Dental	1833
Biolase	1328
Carestream Dental	1529
Dandy Dental Lab	1806
Glidewell Dental	1220
Ivoclar Vivadent	806
Invisalign iTero	705
LabStore	1211
Nobel Biocare USA	1507
PLANMECA USA, Inc.	1115
Shining 3D Technology Inc.	807
VeriONE	1120
Video Dental Concepts	1221
Whip Mix Corp.	1021
Zubler USA	917

CAMERAS

Atlanta Dental Supply	1211
Atlantic Dental Solutions	1100
Benco Dental	1833
Carestream Dental	1529
DentLight Inc.	1100
Designs for Vision, Inc.	1341

Digital Doc	1000
Shofu Dental Corporation	1322
Surgitel	1635
Video Dental Concepts	1221

CASTING MACHINE & ALLOYS

Argen Refining	1229
Georgia High Tech Dental Lab Inc.	1730

CAVITY PREP SYSTEMS

FiteBac Dental LLC	1709
--------------------	------

CEMENTS, ALL TYPES

3M Oral Care	1321
BISCO	1521
GC America, Inc.	1630
Georgia High Tech Dental Lab Inc.	1730
Ivoclar Vivadent	806
Kettenbach	821
Pulpdent Corporation	1206
Shofu Dental Corporation	1322
Tokuyama America	1821
Ultradent Products, Inc.	1621

CHAIRS & ACCESSORIES

A-dec	1411
ADS Dental System Inc.	1228
Atlanta Dental Supply	1211
BDS - Beverstate Dental Systems	1101
BQ Ergonomics LLC	1841
Dansereau Health Products	840
DCI Edge	2031
Dental Equipment Liquidators, Inc.	1702
DentalEZ	1441
Midmark Corporation	1132
Nashville Dental Inc.	1429
PLANMECA USA, Inc.	1115
Porter Royal Sales	1041
Professional Sales Associates, Inc.	1441
Ritter Dental USA	704
RGP Dental Inc.	941
Sunrise Dental Equipment, Inc.	1532
Superior Dental Design & Upholstery	801
Surgitel	1635

CLAIMS PROCESSING

Dental Office Support	1125
eAssist Dental Solutions	1333
PPO Profits	914
PracticeLife	1211
Transition Acceleration Group	1030

COLLECTION FIRMS

Bankers Healthcare Group	1915
--------------------------	------

COMPOSITE RESIN PRODUCTS

3M Oral Care	1321
BISCO	1521
Coltene	1235
Garrison Dental Solutions	1427

Golden Dent	1331
Kettenbach	821
Pulpdent Corporation	1206
Shofu Dental Corporation	1322
Spident Co., Ltd.	1114
Tokuyama America	1821
Top Quality Mfg., Inc. - Glove World	1109
Ultradent Products, Inc.	1621
Zubler USA	917

COMPUTERS

Advantage Technologies	1642
Digital Technology Partners	1035
Florida Probe VoiceWorks	1608
Professional Sales Associates, Inc.	1441
PracticeLife	1211
RecallMax	1133
Sodium Dental	641
Vatech America	1613

CONSULTANT

ADS South, LLC	1326
Advantage Technologies	1642
Affordable Dentures & Implants	1015
Atlanta Design Associates	1211
Crown Tenant Advisors	935
Dental Office Support	1125
Digital Technology Partners	1035
Heartland Dental	1651
McGill & Hill Group	1423
MGE Management Experts	834
PPM-Professional Practice Management	1211
PPO Profits	914
On Demand Orthodontist	2000
Transition Acceleration Group	1030

CONTINUING EDUCATION & TRAINING

Academy of General Dentistry	1246
Academy of Microscope Enhanced Dentistry	925
Affordable Dentures & Implants	1015
CR Foundation Gordon J. Christensen	1224
Clinicians Report	
DentalPost	1634
Georgia Dental Association	1810
Georgia Dental Hygienists' Association	744
Georgia State University Byrdine F. Lewis	1348
School of Nursing and Health Professions	
Golden Dent	1331
Heartland Dental	1651
Hiossen	1012
McGill & Hill Group	1423
MGE Management Experts	834
Millennium Dental Technologies, Inc.	1511
On Demand Orthodontist	2000
OSAP (Organization for Safety, Asepsis and Prevention)	926
PracticeLife	1211
The Pankey Institute	1626
Transition Acceleration Group	1030

COTTON PRODUCTS

Coltene	1235
Microcopy	1509

CROWNS AND/OR CROWN & BRIDGE MATERIALS

3M Oral Care	1321
Argen Refining	1229
Common Sense Dental Products	733
Dandy Dental Lab	1806
Georgia High Tech Dental Lab Inc.	1730
Glidewell Dental	1220
Golden Dent	1331
Hiossen	1012
Ivoclar Vivadent	806
Keating Dental Lab	1817
Kettenbach	821
PDT, Inc. - Paradise Dental Technologies	1808
Spident Co., Ltd.	1114
Water Pik Inc.	1315

CURING LIGHTS

Acteon North America	1421
AMD Lasers	1143
Atlantic Dental Solutions	1100
Coltene	1235
DentLight Inc.	1100
Ivoclar Vivadent	806
Millennium Dental Technologies, Inc.	1511
Spident Co., Ltd.	1114
Ultradent Products, Inc.	1621
Vector Research & Development	1100

DEFIBRILLATORS

ZOLL Medical Corporation	1324
--------------------------	------

DELIVERY SYSTEMS PORTABLE

A-dec	1411
Aseptic, Inc.	1340
Medidenta	1020

DENTAL DEALERS

Atlanta Dental Supply	1211
Benco Dental	1833
Doral Refining Corp.	1208
Henry Schein Dental Practice Transitions	1026
LIGHTMED Corporation	1346
Spident Co., Ltd.	1114
Top Quality Mfg., Inc. - Glove World	1109
Video Dental Concepts	1221

DENTAL HYGIENE MATERIALS (not otherwise classified)

Elevate Oral Care	1330
GC America, Inc.	1630
Georgia Dental Hygienists' Association	744
Georgia State University Byrdine F. Lewis School of Nursing and Health Professions	1348
Microcopy	1509
Pulpdent Corporation	1206

Rose Micro Solutions	1135, 1617, 1741
Simply Hygiene	1211

DENTAL LABORATORIES

Affordable Dentures & Implants	1015
ClearCorrect	1520
Dandy Dental Lab	1806
Georgia High Tech Dental Lab Inc.	1730
Glidewell Dental	1220
Keating Dental Lab	1817
LabStore	1211
Leixir Dental Group	1700
Straumann Group Digital Solutions	1520

DENTAL UNITS

A-dec	1411
ADS Dental System Inc.	1228
AMD LASERS	1143
Atlantic Dental Solutions	1100
BDS - Beaverstate Dental Systems	1101
Dansereau Health Products	840
DCI Edge	2031
MEDI LAZER	1601
Midmark Corporation	1132
PLANMECA USA, Inc.	1115
Symmetry Dental Equipment Cabinetry	1100
VeriONE	1120
Whip Mix Corp.	1021

DENTIFRICE

BURST	1921
Colgate	1705
Crest + Oral-B	1105
Elevate Oral Care	1330

DENTURES

Glidewell Dental	1220
Ivoclar Vivadent	806
LabStore	1211

DESENSITIZERS

BISCO	1521
Elevate Oral Care	1330
Tokuyama America	1821

DIAGNOSTIC EQUIPMENT

Air Techniques, Inc.	1940
CardioRisk Laboratories	1657
Carestream Dental	1529
J. Morita USA, Inc.	1240
LED Dental	916
Pharmanex	1652
Sodium Dental	641
Vatech America	1613
Pharmanex	1652

DISINFECTING SOLUTIONS, ASEPSIS

AMD LASERS	1143
SciCan / Coltene	1235

EDUCATIONAL MATERIALS & VIDEOS (PATIENT & DOCTOR)

Academy of General Dentistry	1246
Affordable Dentures & Implants	1015
ClearCorrect	1520
CR Foundation Gordon J. Christensen Clinicians Report	1224
Curve Dental	717
Elevate Oral Care	1330
Florida Probe VoiceWorks	1608
Georgia Dental Hygienists' Association	744
Glidewell Dental	1220
Gordon J. Christensen-Practical Clinical Courses	1222
Greater New York Dental Meeting	842
Kilgore International, Inc.	1234
LIGHTMED Corporation	1346
Nadia International, Inc.	1320
On Demand Orthodontist	2000
OSAP (Organization for Safety, Asepsis and Prevention)	926
Straumann	1520
TMJ Services	1732

ELECTROSURGICAL EQUIPMENT

Impladent Ltd.	1124
----------------	------

ENDODONTIC INSTRUMENTS & SUPPLIERS

A. Titan Instruments	1141
AMD Lasers	1143
Avalon Biomed	740
Brasseler USA	1017
Carl Zeiss Meditec USA	1807
Coltene	1235
Common Sense Dental Products	733
HuFriedy Group	1005
J. Morita USA, Inc.	1240
Karl Schumacher Dental, LLC	1928
Medidenta	1020
Pulpdent Corporation	1206
Zoll-Dental	1604

EQUIPMENT LEASING & FINANCING

Atlanta Design Associates	1211
Bank of America Practice Solutions	1241
PNC Healthcare Business Banking	933
The Huntington National Bank	1443
United Community Bank	841

EVCUATORS & EVCUATOR SYSTEMS

Air Techniques, Inc.	1940
Zyris - Smiles All Around	1432

EYEWEAR, PROTECTIVE

DentLight Inc.	1100
Designs for Vision, Inc.	1341
Halyard Global Products	1430
Lumadent, Inc.	1717
Q-Optics & Quality Aspirators	940
Rose Micro Solutions	1135, 1617, 1741
Surgitel	1635

Get back to patient care, faster.

Your time matters.

At Humana, we are committed to continuously improving our dental provider experience and making it easier for you to provide high-quality care to your patients.



Humana®

LC16747ALL0222

Scan this QR code or call **800-255-5930** to learn more about joining Humana's dental network.

FIBER OPTIC ILLUMINATOR PRODUCTS

Designs for Vision, Inc.	1341
Medidenta	1020
Q-Optics & Quality Aspirators	940

FILLING MATERIALS & ACCESSORIES

3M Oral Care	1321
Ivoclar Vivadent	806

FINANCIAL SERVICES

Affinity Bank	1640
Bank of America Practice Solutions	1241
Bankers Healthcare Group	1915
Cain Watters & Associates	1707
CareCredit - Synchrony	1729
City National Bank	1805
Columbia Bank	1010
Doctors Disability Specialists	1006, 1628
First Citizens Bank	817
Henry Schein Dental Practice Transitions	1026
Live Oak Bank	1122
McGill & Hill Group	1423
MVB Bank	1840
PNC Healthcare Business Banking	933
PPM- Professional Practice Management	1211
Practice Pathways - Zions Bank	1042
PracticeLife	1211
Provide, Inc.	1032
Scratch	830

The Huntington National Bank	1443
United Community Bank	841
Wells Fargo N.A.	1417

FLOSS

Burst	1921
Colgate	1705
Crest + Oral-B	1105
Sunstar Americas, Inc.	1624

FLUORIDE PRODUCTS (other than dentifrice)

BISCO	1521
Colgate	1705
Elevate Oral Care	1330
Water Pik Inc.	1315

FURNACES

Ivoclar Vivadent	806
VeriONE	1120
Whip Mix Corp.	1021
Zubler USA	917

GLOVES

Benco Dental	1833
Halyard Global Products	1430
Top Quality Mfg., Inc. - Glove World	1109

GOLD

Doral Refining Corp.	1208
Garfield Refining	1335

HANDPIECES, OPERATING, LABORATORY & ACCESSORIES

A-dec	1411
ADS Dental System Inc.	1228
Aseptico, Inc.	1340
Atlantic Dental Solutions	1100
Brasseler USA	1017
Dental Enterprises LLC - Magnetic Mallet	1226
DentalEZ	1441
J. Morita USA, Inc.	1240
LIGHTMED Corporation	1346
Medidenta	1020
Nashville Dental Inc.	1429
NSK America Corp.	1721
Prophy Magic	1020
SciCan / Coltene	1235
The Dentist's Choice	1606
Vector Research & Development	1100
Zubler USA	917

IMPLANTS & ACCESSORIES

Affordable Dentures & Implants	1015
Best Instruments	1034
Biotech Dental	721
<i>formerly integrated dental systems</i>	
Common Sense Dental Products	733
Dandy Dental Lab	1806
Glidewell Dental	1220
Golden Dent	1331

Hiossen	1012
Impladent Ltd.	1124
Keating Dental Lab	1817
Medentika	1520
Neodent	1520
Nobel Biocare USA	1507
PDT, Inc. - Paradise Dental Technologies	1808
Power Dental USA	726
Stellalife	1227
Straumann Group Digital Solutions	1520

IMPRESSION MATERIALS

3M Oral Care	1321
Coltene	1235
GC America, Inc.	1630
Glidewell Dental	1220
Invisalign iTero	705
J. Morita USA, Inc.	1240
Kettenbach	821
Power Dental USA	726
SciCan / Coltene	1235
Water Pik Inc.	1315

INFECTION CONTROL PRODUCTS

Air Techniques, Inc.	1940
Atlanta Dental Supply	1211
Benco Dental	1833
Garrison Dental Solutions	1427
Halyard Global Products	1430
HuFriedyGroup	1005
M.A.R.S Bio-Med Processes Inc.	1004
OSAP [Organization for Safety, Asepsis and Prevention]	926
Q-Optics & Quality Aspirators	940
Salvin Dental	805
Simply Hygiene	1211
Solmetex, LLC	1112
Top Quality Mfg., Inc. - Glove World	1109
Tuttnauer USA Co., Ltd.	1441

INSTRUMENTS, OPERATING & ACCESSORIES

ACTEON North America	1421
Bausch Articulating Papers, Inc.	1244
Best Instruments	1034
Brasseler USA	1017
Dental Enterprises LLC - Magnetic Mallet	1226
Garrison Dental Solutions	1427
Golden Dent	1331
HuFriedyGroup	1005
Karl Schumacher Dental, LLC	1928
PDT, Inc. - Paradise Dental Technologies	1808
Pharmanex	1652
ProDent USA	905
Ritter Dental USA	704
Salvin Dental	805
Zoll - Dental	1604
Zyris - Smiles All Around	1432

INSURANCE

Academy of General Dentistry	1246
Anthem BlueCross BlueShield	1332
Dental Office Support	1125
Doctors Disability Specialists	1006, 1628
eAssist Dental Solutions	1333
GEHA Connection Dental Network	1633
Georgia Dental Association	1810
Pharmacists Mutual Insurance Company	1716
PPO Profits	914
Practicelife	1211
Scratch	830

INTERCOMMUNICATION SYSTEMS

Advantage Technologies	1642
Black Diamond Radio	1001
Kenwood / Wired Fox	1225
Porter Royal Sales	1041

INTERDENTAL CLEANERS

Philips Sonicare and Zoom Whitening	1515
Sunstar Americas, Inc.	1624

INTERNET SERVICES

ADIT	735
Curve Dental	717
Heartland Dental	1651
itrac llc	1031
Simplifeye	1610

INTRA ORAL VIDEO SYSTEMS

ACTEON North America	1421
DentLight Inc.	1100
Invisalign iTero	705
Nobel Biocare USA	1507
Shining 3D Technology Inc.	807
Sodium Dental	641
Straumann Group Digital Solutions	1520

INVESTMENT MATERIALS & EQUIPMENT

VeriONE	1120
Whip Mix Corp.	1021
Zubler USA	917

LABORATORY EQUIPMENT (not otherwise classified)

LabStore	1211
NSK America Corp.	1721
Shining 3D Technology Inc.	807
Zubler USA	917

LASERS

AMD LASERS	1143
Atlantic Dental Solutions	1100
Biolase	1328
Brasseler USA	1017
DentLight Inc.	1100
Fotona	1230
J. Morita USA, Inc.	1240
LIGHTMED Corporation	1346
MEDI LAZER	1601

Millennium Dental Technologies, Inc.	1511
Ultradent Products, Inc.	1621

LIGHTS

A-dec	1411
ADS Dental System Inc.	1228
Aseptico, Inc.	1340
Brasseler USA	1017
DCI Edge	2031
Dental Equipment Liquidators, Inc.	1702
Designs for Vision, Inc.	1341
Lumadent, Inc.	1717
Medi Loupes	1016
Orascoptic	1605
Q-Optics & Quality Aspirators	940
Rose Micro Solutions	1135, 1617, 1741
Snap On Optics	1121
Sunrise Dental Equipment, Inc.	1532

LOUPES

Brasseler USA	1017
Carl Zeiss Meditec USA	1807
Designs for Vision, Inc.	1341
Lumadent, Inc.	1717
Medi Loupes	1016
Orascoptic	1605
Q-Optics & Quality Aspirators	940
Rose Micro Solutions	1135, 1617, 1741
Snap On Optics	1121
Surgitel	1635
Ultraflight Optics	734, 1935

MARKET RESEARCH

Simplifeye	1610
TMJ Services	1732

MASKS

Halyard Global Products	1430
HuFriedy Group	1005
Valumax International	1127

METAL RECOVERY, REFINING

Doral Refining Corp.	1208
Garfield Refining	1335

MICROSCOPES

Academy of Microscope Enhanced Dentistry	925
Carl Zeiss Meditec USA	1807
Rose Micro Solutions	1135, 1617, 1741

MILITARY CAREER

Affordable Dentures & Implants	1015
--------------------------------	------

MIRRORS

A. Titan Instruments	1141
PDT, Inc. - Paradise Dental Technologies	1808

MOBILE DENTAL CLINIC

Christian Dental Society	722
--------------------------	-----

MOUTHWASHES

Crest + Oral-B	1105
Freedom Day USA	1825
OraCare	1924
The Smile Defenders	1827

NITROUS OXIDE EQUIPMENT/SUPPLIES

Porter Royal Sales	1041
--------------------	------

NUTRITIONAL PRODUCTS

Pharmanex	1652
-----------	------

OCCUSAL EXAM SYSTEMS/MATERIALS

Bausch Articulating Papers, Inc.	1244
Whip Mix Corp.	1021
VeriONE	1120

OFFICE CONSTRUCTION & DESIGN

Atlanta Design Associates	1211
Nashville Dental Inc.	1429

OFFICE FURNITURE & DECOR

BQ Ergonomics LLC	1841
RGP Dental Inc.	941

OFFICE SUPPLIES

Black Diamond Radio	1001
---------------------	------

ONLINE SERVICES

ADIT	735
Dental Office Support	1125
DentalPost	1634
Heartland Dental	1651
itrac llc	1031
Scratch	830
Simplifeye	1610

OPERATING LIGHTS

BDS - Beaverstate Dental Systems	1101
Dansereau Health Products	840
Designs for Vision, Inc.	1341
Surgitel	1635

OPERATING ROOM SUPPLIES & EQUIPMENT*(not otherwise classified)*

CMI Health Inc.	1829
Dental Enterprises LLC - Magnetic Mallet	1226
Halyard Global Products	1430
LIGHTMED Corporation	1346
Nashville Dental Inc.	1429

OPTICAL AIDS

Designs for Vision, Inc.	1341
Q-Optics & Quality Aspirators	940
Zyris - Smiles All Around	1432

ORAL HYGIENE AIDS

AMD Lasers	1143
BURST	1921

Colgate	1705
NSK America Corp.	1721
Philips Sonicare and Zoom Whitening	1515
Simply Hygiene	1211
StellaLife	1227
Sunstar Americas, Inc.	1624

ORAL IRRIGATION DEVICES

Water Pik Inc.	1315
----------------	------

ORAL RINSES

Colgate	1705
StellaLife	1227

ORAL SCREENING DEVICE

Atlantic Dental Solutions	1100
DentLight Inc.	1100
LED Dental	916

ORTHODONTIC/PEDODONTIC MATERIALS

Biotech Dental	721
<i>formerly integrated dental systems</i>	
ClearCorrect	1520
Dandy Dental Lab	1806
Henry Schein Orthodontics	1024
Invisalign iTero	705
On Demand Orthodontist	2000

PATIENT FINANCING

Alphaeon Credit	1113
CareCredit - Synchrony	1729
itrac llc	1031
Scratch	830
Sunbit	1231

PERIODICALS, PROFESSIONAL/SCIENTIFIC

Georgia Dental Hygienists' Association	744
--	-----

PERIODONTAL DIAGNOSTIC PRODUCTS

Power Dental USA	726
Pharmanex	1652

PERIODONTAL EXAM SYSTEMS, COMPUTERIZED

Florida Probe VoiceWorks	1608
--------------------------	------

PERIODONTAL INSTRUMENTS & SUPPLIES

A. Titan Instruments	1141
ACTEON North America	1421
HuFriedy Group	1005
Karl Schumacher Dental, LLC	1928
LIGHTMED Corporation	1346
Millennium Dental Technologies, Inc.	1511
PDT, Inc. - Paradise Dental Technologies	1808
Power Dental USA	726
Salvin Dental	805
StellaLife	1227
Zoll - Dental	1604

PHARMACEUTICALS (DRUGS)

Onpharma Company	1131
StellaLife	1227

PHOTOGRAPHIC EQUIPMENT, SUPPLIES, ACCESSORIES

Artman Instruments	911
--------------------	-----

PIT & FISSURE SEALANTS

Elevate Oral Care	1330
Pulpdent Corporation	1206
Shofu Dental Corporation	1322
Ultradent Products, Inc.	1621

PLAQUE & GINGIVITIS MOUTH RINSES

StellaLife	1227
------------	------

POLISHING SYSTEMS

NSK America Corp.	1721
Prophy Magic	1020
Vector Research & Development	1100

PORCELAIN PRODUCTS & ACCESSORIES

BISCO	1521
Keating Dental Lab	1817
Shofu Dental Corporation	1322
Zubler USA	917

PORTABLE DELIVERY SYSTEMS

Aseptico, Inc.	1340
Christian Dental Society	722
Medidenta	1020

PRACTICE MANAGEMENT

Academy of General Dentistry	1246
ADIT	735
Affordable Dentures & Implants	1015
CardioRisk Laboratories	1657
CareCredit - Synchrony	1729
Carestream Dental	1529
CARR / Dental Real Estate	920
Coast Dental	1603
Curve Dental	717
D4C Dental Brands	1925
Dental Office Support	1125
eAssist Dental Solutions	1333
Heartland Dental	1651
Lighthouse 360, a Henry Schein One Company	1023
McGill & Hill Group	1423
MGE Management Experts	834
North American Dental Group	1223
PNC Healthcare Business Banking	933
PractiLife	1211
RecallMax	1133
Sage Dental	1712
Solutionreach	1525
Star Dental Partners	746
Sunbit	1231
Transition Acceleration Group	1030

PRACTICE MARKETING

ADIT	735
Heartland Dental	1651
itrac llc	1031
Lighthouse 360, a Henry Schein One Company	1023
MGE Management Experts	834
Sage Dental	1712
Simplifeye	1610
Solutionreach	1525
TMJ Services	1732

PRACTICE SALES

ADIT	735
ADS South, LLC	1326
AFTCO	907
Bank of America Practice Solutions	1241
BridgeWay Practice Transitions	1631
Cain Watters & Associates	1707
CARR / Dental Real Estate	920
Columbia Bank	1010
D4C Dental Brands	1925
DDS Match South LLC	1013
Doctors Disability Specialists	1628
Heartland Dental	1651
Henry Schein Dental Practice Transitions	1026
McGill & Hill Group	1423
MGE Management Experts	834
PNC Healthcare Business Banking	933
PPM - Professional Practice Management	1211
Solutionreach	1525
Star Dental Partners	746
Sunbit	1231
Transition Acceleration Group	1030
Wells Fargo N.A.	1417

PREVENTIVE DENTISTRY PRODUCTS

3M Oral Care	1321
Burst	1921
Elevate Oral Care	1330
Florida Probe VoiceWorks	1608
GC America, Inc.	1630
Ivoclar Vivadent	806
Kilgore International, Inc.	1234
LED Dental	916
LIGHTMED Corporation	1346
NSK America Corp.	1721
Pharmanex	1652
Prophy Magic	1020
Pulpdent Corporation	1206
Simply Hygiene	1211
Sunstar Americas, Inc.	1624

PROPHYLAXIS ANGLES & KITS

Prophy Magic	1020
Simply Hygiene	1211
Water Pik Inc.	1315

PROSTHETIC & LABORATORY SUPPLIES

(not otherwise classified)

Dandy Dental Lab	1806
LabStore	1211

PROTECTIVE COVERINGS

Halyard Global Products	1430
-------------------------	------

PUBLICATIONS

Academy of General Dentistry	1246
Dental Tribune America	1711
Dentistry Today	1425
DeW Life	1008
McGill & Hill Group	1423

REFINERIES

Doral Refining Corp.	1208
Garfield Refining	1335
Zoll - Dental	1604

RESTORATIVE MATERIALS & ACCESSORIES

(not otherwise classified)

3M Oral Care	1321
Avalon Biomed	740
BISCO	1521
Brasseler USA	1017
Common Sense Dental Products	733
GC America, Inc.	1630
Golden Dent	1331
Keating Dental Lab	1817
Nashville Dental Inc.	1429
NSK America Corp.	1721
Pulpdent Corporation	1206
Shofu Dental Corporation	1322
Top Quality Mfg., Inc. - Glove World	1109
Water Pik Inc.	1315

RETRACTION DEVICES

Karl Schumacher Dental, LLC	1928
PDT, Inc. - Paradise Dental Technologies	1808
Zyris - Smiles All Around	1432

SCALING/STAIN REMOVAL DEVICES

Artman Instruments	911
Medidenta	1020
Millennium Dental Technologies, Inc.	1511
NSK America Corp.	1721
Vector Research & Development	1100
Water Pik Inc.	1315
Zoll - Dental	1604

SHARPENING SYSTEMS

PDT, Inc. - Paradise Dental Technologies	1808
Simply Hygiene	1211

SLEEP/AIRWAY DEVICES

Kettenbach	821
Vivos Therapeutics	713

STAFFING SERVICES

BridgeWay Practice Transitions	1631
Cross Country Healthcare	716
DDS Match South LLC	1013
Dental Dynamic Staffing	1922
Dental Office Support	1125
Star Dental Partners	746

STERILIZER ACCESSORIES

Artman Instruments	911
PDT, Inc. - Paradise Dental Technologies	1808
SciCan / Coltene	1235
Tuttner USA Co., Ltd.	1441

STERILIZERS

Best Instruments	1034
Dental Equipment Liquidators, Inc.	1702
Midmark Corporation	1132
Porter Royal Sales	1041
SciCan / Coltene	1235
Sunrise Dental Equipment, Inc.	1532
Tuttner USA Co., Ltd.	1441

STERILIZING & DISINFECTING SOLUTIONS

Halyard Global Products	1430
HuFriedy Group	1005
SciCan / Coltene	1235
Tuttner USA Co., Ltd.	1441

STOOLS, DENTAL OPERATING

A-dec	1411
ADS Dental System Inc.	1228
Aseptico, Inc.	1340
BDS - Beaverstate Dental Systems	1101
Benco Dental	1833
BQ Ergonomics LLC	1841
Dansereau Health Products	840
DCI Edge	2031
Midmark Corporation	1132
Porter Royal Sales	1041
Professional Sales Associates, Inc.	1441
RGP Dental Inc.	941
Ritter Dental USA	704
Superior Dental Design & Upholstery	801
Surgitel	1635

STOOLS, LABORATORY

BQ Ergonomics LLC	1841
RGP Dental Inc.	941
Simply Hygiene	1211

SURGICAL SUPPLIES

AMD Lasers	1143
Artman Instruments	911
Best Instruments	1034
Dental Enterprises LLC - Magnetic Mallet	1226
Halyard Global Products	1430
HuFriedy Group	1005
LIGHTMED Corporation	1346
Power Dental USA	726
Salvin Dental	805
Zoll-Dental	1604

SYRINGES, ALL TYPES

Artman Instruments	911
Best Instruments	1034
Karl Schumacher Dental, LLC	1928
Prophy Magic	1020

TEETH, ARTIFICIAL

Keating Dental Lab	1817
Kilgore International, Inc.	1234
LabStore	1211

TMJ PRODUCTS

TMJ Services	1732
--------------	------

TOOTH SHADE GUIDES

Glidewell Dental	1220
Video Dental Concepts	1221

TOOTH WHITENING

AMD Lasers	1143
Burst	1921
Colgate	1705
Crest + Oral-B	1105
Pharmanex	1652
Ultradent Products, Inc.	1621

TOOTHBRUSHES, HAND

Arm & Hammer	1641
Colgate	1705
Crest + Oral-B	1105
Simply Hygiene	1211
Sunstar Americas, Inc.	1624

TOOTHBRUSHES, POWER

Arm & Hammer	1641
Burst	1921
Crest + Oral-B	1105
Philips Sonicare and Zoom Whitening	1515
Sodium Dental	641
Sunstar Americas, Inc.	1624
Water Pik Inc.	1315

ULTRASONIC EQUIPMENT, LABORATORY

CardioRisk Laboratories	1657
Coltene	1235
Superior Dental Design & Upholstery	801
Tuttnauer USA Co., Ltd.	1441

ULTRASONIC EQUIPMENT, PROPHYLAXIS

CardioRisk Laboratories	1657
Coltene	1235
Medidenta	1020
Tuttnauer USA Co., Ltd.	1441

UNIFORMS & GOWNS

Valumax International	1127
-----------------------	------

VACUUM SYSTEMS

ADS Dental System Inc.	1228
Air Techniques, Inc.	1940
Dansereau Health Products	840
Dental Equipment Liquidators, Inc.	1702
DentalEZ	1441
Professional Sales Associates, Inc.	1441
Sunrise Dental Equipment, Inc.	1532
Symmetry Dental Equipment Cabinetry	1100
Zubler USA	917

WAX, ALL TYPES

VeriONE	1120
Whip Mix Corp.	1021

WEBSITE DESIGN

ADIT	735
Affordable Dentures & Implants	1015
Doctor Multimedia	921, 1804
itrac llc	1031

XEROSTOMIA PRODUCTS

Elevate Oral Care	1330
StellaLife	1227

X-RAY DIGITAL

ACTEON North America	1421
Air Techniques, Inc.	1940
Atlanta Dental Supply	1211
Carestream Dental	1529
Curve Dental	717
Digital Doc	1000
J. Morita USA, Inc.	1240
Midmark Corporation	1132
Nashville Dental Inc.	1429
PLANMECA USA, Inc.	1115
Sodium Dental	641
Superior Dental Design & Upholstery	801
Vatech America	1613
Video Dental Concepts	1221

X-RAY FILMS, INTRA ORAL & EXTRA ORAL

Biolase	1328
Vatech America	1613

X-RAY MACHINES & ACCESSORIES

ACTEON North America	1421
Air Techniques, Inc.	1940
Aseptico, Inc.	1340
Atlantic Dental Solutions	1100
Benco Dental	1833
Biolase	1328
Dental Equipment Liquidators, Inc.	1702
PLANMECA USA, Inc.	1115
Safe RayZ	959
Sodium Dental	641
Sunrise Dental Equipment, Inc.	1532
Superior Dental Design & Upholstery	801
Vatech America	1613
Vector Research & Development	1100
Video Dental Concepts	1221

X-RAY PROCESSING EQUIPMENT & ACCESSORIES

Biolase	1328
Microcopy	1509
Vatech America	1613

Photo Op Alert!

Snap a photo and use the official hashtag **#myhinman** in your posts!

Tag **@hinmandental** so we can follow along!



Outside Sidney Marcus Auditorium | GWCC, Level 400

Hinman.org | [f](#) [@](#) <#> **#myhinman**

EXHIBITOR *Listing*

3M Oral Care 1321

St. Paul, MN
800-634-2249
3M.com/dental
3M Oral Care promotes lifelong oral wellness by providing science-based solutions that help dental professionals achieve greater clinical, professional and personal success. Named one of the most innovative companies in the dental industry for 11 consecutive years, 3M products support dental professionals and their patients to realize optimal outcomes.

A. Titan Instruments 1141

Orchard Park, NY
877-284-8261
atitan.com
A. Titan Instruments is a supplier of the finest handcrafted dental and surgical instruments. A. Titan is enhancing patient care by providing dental professionals with superior instruments, exemplary customer service, and a sales team available to consult them on new instruments that will enable them to remain on the cutting edge of dentistry.

Academy of General Dentistry 1246

Chicago, IL
888-AGD-dent
agd.org
The Academy of General Dentistry is the second largest dental association in the U.S. We exclusively represent the general dentist with our advocacy efforts, while providing our members with CE tracking and the opportunity to achieve our Fellowship and Mastership awards for continuing education.

Academy of Microscope Enhanced Dentistry. 925

Lutz, FL
813-444-1011
microscopedentistry.com
The academy is an organization to encourage, inspire and educate the dentist and the public as to the benefits of microscopic dentistry and to grow from our combined wealth of experiences by sharing our successes. We also offer Microscope Training for the new and existing scope owner.

Accutron, a member of HuFriedy Group . 1441

Hauppauge, NY
800-483-7433
hufriedygroup.com/accutron

ACTEON North America 1421

Mount Laurel, NJ
800-289-6367
acteongroup.com/us
ACTEON North America provides all sales, marketing, customer service and technical support for ACTEON products in the United States and Canada. With a steady stream of inventive and minimally invasive products combined with dedicated customer support and technical service, ACTEON North America's position continues to grow each year in this marketplace.

A-dec 1411

Newberg, OR
800-547-1883
a-dec.com
A-dec provides simple, innovative solutions that deliver superior value to the customer worldwide.

ADIT 735

Rosenberg, TX
832-410-8230
adit.com
Adit is a data-driven practice growth platform that centralizes and quantifies the patient experience. Starting with a stunning website, to ranking high in search engines, to social media engagement, to digital booking, to post-visit follow-up – Adit accelerates practice growth via new patient acquisition, streamlining the patient experience and automating the front office.

ADS Dental System Inc. 1228

Parker, CO
623-262-0246
adsequip.com
ADS Dental System Inc., the branch company of Guangzhou Ajax Medical Equipment Co., Ltd. in America. The local warehouse is benefit for delivery speed and provide after-sales service in time. We have an experienced, responsible, skilled and good service after-sales team.

ADS South, LLC 1326

St. Augustine, FL
800-231-4540
adssouth.com
Since 1984, Earl Douglas and his associates have served your practice transition, appraisal, associateship services, pre-retirement transition support and expert testimony needs. ADS South is known by its impeccable reputation as being fair, honest and effective in helping dentists plan and implement their practice transition strategies.

Advantage Technologies 1642

Chesterfield, MI
877-723-8832
adv-tech.com/georgia
Advantage Technologies is the premier provider of technology integration solutions for dental practices. Our array of strategic partnerships allows us to design a solution customized for your needs. Our highly skilled information technology team makes it our goal to understand your front office computer management programs and clinical treatment technology. The training and experience we have, allows us to truly deliver "Hassle Free I.T." experience to your entire practice.

Affinity Bank 1640

Atlanta, GA
866-736-8194
myaffinitybank.com
"Bringing Personal Service to Your Dental Practice and Home." Affinity Bank is a full-service bank with a niche expertise in the dental industry. We use a tailored approach with each client so they benefit greatly from competitive lending rates, loan structures, money market rates, CDs, money management solutions and complimentary Remote Deposit Systems. *(Minimum Balance Required.)

Affordable Dentures & Implants 1015

Morrisville, NC
704-938-0444
careers.affordabledentures.com
Founded in 1975, today Affordable Care, LLC is America's largest dental support organization (DSO) focused on tooth replacement services, serving more than 320 dental practices across the United States. Each practice has an on-site dental laboratory, allowing the practice to provide same-day dental services including extractions, dentures and implants. Affordable Care is the DSO for two top dental brands: Affordable Dentures & Implants and DDS Dentures + Implant Solutions.

AFTCO907

Marietta, GA
800-232-3826
aftco.net

AFTCO is the oldest and largest dental practice transition consulting firm in the United States. AFTCO assists dentists with associateships, purchasing and selling of practices and retirement plans. We are much more than a practice broker, we are here to serve you through all stages of your career.

Air Techniques, Inc.1940

Melville, NY
800-247-8324
airtechniques.com

Air Techniques, Inc. is a global corporation continuing to pave the way with compelling, reliable dental products, ensuring today's dental professionals are "Equipped for Life®". With a strong product portfolio of utility systems, digital imaging and merchandise, Air Techniques products are capable of equipping the smallest practice to the largest university or hospital. Air Techniques continues to represent superior quality and is a trusted brand to dealers and dental professionals worldwide.

Alphaeon Credit1113

Newport Beach, CA
920-306-1794
myalphaeoncredit.com

Alphaeon Credit is a patient financing program, offered through Comenity Capital Bank, that can help you help more patients with strong approval rates, superior credit limits and stress-free service.

AMD LASERS1143

West Jordan, UT
866-999-2635
amdlasers.com

AMD Lasers is the global leader in providing ultra-affordable dental laser technology.

Anthem Blue Cross and Blue Shield . . 1332

Oxnard, CA
805-335-3412
anthem.com/dentalproviders

Argen Refining1229

San Diego, CA
858-455-7900
argenrefining.com

The Argen Corporation is the world's largest manufacturer of precious dental gold alloys, leader in scrap refining services, and leading innovator of digital dentistry solutions. Argen utilizes state-of-the-art technology, proprietary materials, and a unique processing system that ensures the maximum amount of precious metals is recovered.

Arm & Hammer1641

Richardson, TX
609-945-8700
oralcarepro.com

For over 170 years, baking soda has been recognized for its unique oral care benefits. ARM & HAMMER™, the baking soda expert, is pleased to provide you with the latest clinical information on the advantages of baking soda toothpaste and power brushes for your patients.

Artman Instruments911

Acworth, GA
470-775-9109
artmaninstruments.com

Aseptico, Inc.1340

Woodinville, WA
425-487-3157
aseptico.com

Aseptico manufactures the world's widest range of advanced high quality electric motors for rotary endodontics, implantology, laboratory and portable dentistry applications. The company also produces rubber dams, and many other accessories. Aseptico is FDA, CE, and ISO 13485 certified and seeks to expand its distributor network worldwide.

Atlanta Dental Supply1211

Duluth, GA
800-241-3743
atlantadental.com

It's Simple. Atlanta Dental answers to you, not Wall Street or outside investors. We succeed by helping you control your costs, by standing behind what we sell, and never compromising when it comes to service and support. We have this in common with you; we both want what is best for your practice. We are both employee-owned and take pride in doing what is right. Take our Supply Audit® and see how much we can save you on supplies, shipping service and more!

Atlanta Design Associates1211

Duluth, GA
800-209-9106
atlantadesign.net

Our mission at Atlanta Design is to elevate the ergonomics and efficiency of dental office design. The expertise that has managed over 3,500 projects can help you optimize your space allocation and construction costs. Our design team is experienced in whatever size project you have. Surprisingly, most of our plans are free with the purchase of equipment from Atlanta Dental Supply.

Atlantic Dental Solutions1100

St. Augustine, FL
954-445-3008
atlanticdentalsolutions.com

Vector R&D provides everything you need from a full line of handpieces, accessories, prophylaxis and scalers to implant systems and handheld x-ray units. DentLight manufactures award-winning curing lights and loupe lights for over a decade. They also manufacture oral cancer screening devices, HD camera systems and lasers systems. Symmetry Dental Equipment provides dental operatory and sterilization cabinetry and equipment.

Avalon Biomed740

Houston, TX
941-896-9948
avalonbiomed.com

Based in Houston, Avalon Biomed is a leading designer, manufacturer and marketer of advanced bioceramic dental materials that are unsurpassed in versatility and quality. These products have a variety of uses in vital pulp therapy and endodontics, including: root canal sealing, root-end filling, apexification, obturation, resorption, perforation repair, apexogenesis, pulpotomy and cavity liner/base, direct pulp capping/partial pulpotomy and indirect pulp capping.

Bank of America Practice Solutions . . 1241

Westerville, OH
800-344-8325
bankofamerica.com/

smallbusiness/practice-loans/overview.g0 Bank of America Practice Solutions specializes in financing for new and existing dental practices providing loans for new practice start-ups, refinancing, practice sales & acquisitions, remodeling, expansions, relocations, business debt consolidation, equipment, real estate and more. We offer low competitive rates and fixed or variable terms from 12 months up to 25 years. Receive a reply in just one day!

Bankers Healthcare Group 1915

Syracuse, NY
315-256-9748
bhg-inc.com
BHG is a private equity direct lender providing healthcare professionals access to working capital loans, personnel consumer loans, a Suite of 6 Exclusive Master Cards, an SBA Lending Program and Collection Services. BHG has been in business for 20 years having provided over \$5.5 billion in financial solutions nationwide in the USA. With 600 employees, offices in South Florida, Syracuse, NY and NYC BHG is pleased to support the Hinman 2020 meetings!

Bausch Articulating Papers, Inc 1244

Nashua, NH
888-622-8724
bauschdental.com
Bausch is a 65 year old German company that manufacturers articulating and occlusion test materials. We have a wide array of products including papers, foils and sprays. Bausch Articulating Papers, Inc. is based in New England, and all products are sold through our authorized distributors in the U.S. – we make Occlusion visible.

BDS - Beaverstate Dental Systems. 1101

Newberg, OR
800-237-2303
beaverstatedental.com
BDS - Beaverstate Dental Systems is an Oregon manufacturer of dental carts, hand piece controls, operatory lights, dental chair, assistant’s instrumentation, clean water systems and a complete line of replacement components. Complete with a five year warranty, our products are produced with reliability and simplicity to provide years of trouble free service.

Ben Massell Dental Clinic 715

Atlanta, GA
770-677-9461
benmasselldentalclinic.org
The Atlanta place to volunteer. Ben Massell is a Center of Excellence and Top 5 Dental Clinic in the country. The Clinic provides free service for indigent adults in a state of the art facility. We need more dentists, general and specialty providers, as well as hygienist to give back a few hours a month. Our mission is ensuring hope and opportunity are achieved through increased quality of life and self-sufficiency for patients. Help change thousands of lives each year in Atlanta.

Benco Dental 1833

Pittston, PA
800-462-3626
benco.com
At Benco Dental, we Drive Dentistry Forward through innovative solutions and our caring family culture. Our firsts include CenterPoint design/equipment superstores, OneVisit™ open architecture CAD/CAM, Painless® electronic ordering and automated supply management. Independent since founded by Ben Cohen in 1930, we’ve grown to become the country’s largest family-owned dental distributor.

Best Instruments 1034

Woodhaven, NY
718-847-1102
best-inst.com
Wholesaler importer and distributor of all kinds of dental, surgical, orthodontic and implant instruments.

Big Mouth Toothbrush by Dr Bobbi 2006

Brooklyn, NY
718-922-2800
bigmouthtoothbrush.com

Biolase 1328

Foothill Ranch, CA
888-424-6527
biolase.com
Biolase, Inc. is a biomedical company that develops, manufactures and markets dental and medical lasers and also distributes and markets digital impressioning and 3D imaging equipment for dentistry. BIOLASE is transforming surgery in dentistry and medicine by providing diagnosis planning and biological treatments that enhance the patient experience.

Biotech Dental *formerly integrated dental systems* 721

Englewood, NJ
866-277-5662
biotechdentalusa.com
Biotech Dental offers integrated products that are more affordable, provide faster procedures, and most importantly, ensure more successful patient outcomes. Our implant, orthodontic, digital, regenerative and aesthetic solutions are designed to bring real and lasting improvement to the quality of life of your patients. We look forward to working together with you to create a world of smiles.

BISCO 1521

Schaumburg, IL
800-247-3368
bisco.com
BISCO strives to inspire better dentistry worldwide by developing best-in-class dental products, educating and sharing our knowledge and research with the dental community, and supporting our customers’ needs as their go-to restorative dental experts. Established in 1981, BISCO has been providing industry leading materials to dental customers in the U.S. and in over 60 countries worldwide for 40 years.

BLACK DIAMOND RADIO 1001

Aurora, CO
800-711-7317
customearpiece.com
Black Diamond Radio is the leader in providing communication solutions to dental offices. 1,000s of offices use our 2-way radios and earpieces to communicate effectively, work as a team and improve the patient experience. The radio weighs only 4 oz. and our earpieces provide hands-free communication without contamination. Complete 6-user system for just \$1249.95. Includes a FREE 6-bank charger!

BQ Ergonomics LLC 1841

Overland park, KS
877-938-9034
bqergonomics.com
Back Quality Ergonomics has been developing and manufacturing ergonomic chairs, work stools for over 20 years, in over 26 countries and aims to contribute to a better quality of life by providing a unique and longlasting solution for back and neck problems. Our chairs and stools facilitate a better posture when working in all seating positions and are widely used by health care practitioners, dentist, surgeons, optometrists, laboratory workers, office and administrative staff.

Brasseler USA 1017

Savannah, GA
800-841-4522-5151
brasselerusa.com
Leading instrumentation provider to the dental profession. Product offering includes clinical and laboratory diamonds, carbides and polishers; a complete line of endodontic instrumentation and equipment; direct restorative materials, clinical and laboratory hand Instruments; dental hygiene instrumentation and handpieces; loupes & headlights; handpieces for operatory, laboratory, oral surgery/implant, endodontic and hygiene uses.

BridgeWay Practice Transitions 1631

Atlanta, GA
800-516-4640
bridgewaytransitions.com
BridgeWay Practice Transitions helps dentists in all stages of practice transitions, from a new graduate looking for their first job to the seasoned practice owner ready for retirement. Founded on the principles of excellent customer service, complete transparency and a passion for helping people, BridgeWay works hard to make sure that all transitions are win/win.

BURST 1921

Walnut, CA
833-287-7887
burstoralcare.com/ambassador
The affordable, subscription oral care company recommended to you by over 26,000 trusted dental professionals! Become an ambassador and earn extra income or sign up your office and stock our various products for resale and gifting. Come join us and see why we have over 40,000 5 star customer reviews!

Cain Watters & Associates 1707

Plano, TX
972-977-2900
cainwatters.com
Cain, Watters & Associates, PLLC is a fee-only CPA firm that has been serving dental professionals across the United States for almost 30 years with personalized, comprehensive financial planning. Stop by our booth for a complimentary financial review. If we can't find savings for you, then don't hire us!

CardioRisk Laboratories 1657

Sandy, UT
801-855-6775
cardiorisk.us
CardioRisk offers a 15-minute, non-invasive diagnostic test (CIMT) which detects atherosclerotic disease responsible for the majority of Heart Attacks and Strokes. In a 10-year, 100,000 person-year study, this test caught 98.6% of the events BEFORE they occurred. The test measures atherosclerotic plaque and inflammation. Don't miss your opportunity to get this test at the Health Pavilion. There are a limited number of appts available so make sure to book soon at www.cardiorisk.us/hinman2022

CardioSound 1900

Woodstock, GA
678-576-4053
cardiosound.com

CareCredit- Synchrony 1729

Costa Mesa, CA
800-300-3046
carecredit.com
When dentistry requires an out-of-pocket cost, help more patients accept the treatment they want, need or may have postponed by recommending they privately apply for the CareCredit credit card on their smart device or computer. If approved, patients may be able to pay over time with convenient monthly payments on purchases of \$200 or more.

Carestream Dental 1529

Atlanta, GA
800-944-6365
carestreamdental.com
Carestream Dental is transforming dentistry, simplifying technology and changing lives around the world with our innovative digital product line of systems, solutions and support. With our products, we aid in more precise diagnoses, improved workflows and superior patient care.

Carl Zeiss Meditec USA 1807

Dublin, CA
800-442-4020
med-showroom.zeiss.com/mcs/dental/showroom
For 175 years, ZEISS has been developing optical instruments that set groundbreaking standards around the world. ZEISS remains a worldwide leader in optical visualization solutions for dental applications and offers a full line of optical systems, including EyeMag® Loupes, OPMI® pico, PROergo® and EXTARO® 300 Dental Microscopes.

CARR / Dental Real Estate 920

Lone Tree, CO
719-522-3340
carr.us
Carr Healthcare Realty is the nation's leading provider of commercial real estate for healthcare tenants and buyers. Every year hundreds of healthcare practices trust us to help them achieve the most favorable terms on their lease and purchase negotiations. By not representing landlords or sellers, we strongly advocate for healthcare providers.

Centurion Health 1130

Vienna, VA
571-762-4731
teamcenturion.com

CERT International 724

Crossville, TN
931-707-9328
certinternational.org
CERT International is a 501(c)3 non-profit, nondenominational, serve and assist Christian organization. Our purpose is to provide physical and spiritual relief to suffering and needy people around the world in the name of Jesus Christ.

Christian Dental Society 722

Belhaven, NC
910-389-8897
christiandental.org
The Christian Dental Society seeks to share the Good News of Jesus Christ around the world by providing knowledge, expertise, encouragement, portable equipment and instrument kits to dental personnel who provide free dental care in third world countries.

City National Bank 1805

Atlanta, GA
678-630-2934
cnb.com

ClearCorrect 1520

Round Rock, TX
888-331-3323
clearcorrect.com
Founded by dentists in 2006, ClearCorrect has helped thousands of doctors around the world correct simple and complex malocclusion with its affordable, discreet and effective clear aligners. ClearCorrect's proudly designs, manufactures and supports its products in Round Rock, Texas. ClearCorrect is now offering new customizable Flex™ and full-featured Unlimited™ pricing options for US providers.

Cloud Dentistry 1650

Boston, MA
844-643-3128
clouddentistry.com

CMI Health Inc 1829

Alpharetta, GA
888-985-1125
cmihealth.com
CMI Health is a manufacturer of innovative patient monitoring devices. We have developed, manufactured and marketed Oximeters, Vital Sign Monitors and Patient Monitors since 2000. Our Best-in-Class PC-900B Capnograph and Oximeter device provides an affordable patient monitoring solution for any size dental practice. Keep patient monitored EtCO2 and SpO2 during any level of sedation to ensure safety operations, protecting both the patient and the practice.

Coast Dental 1603

Tampa, FL
813-288-6264
coastdental.com
Coast Dental, with practices in Florida, Georgia, and Texas, is always in search of talented dentists, hygienists and other staff to help us create healthy and beautiful smiles – one patient at a time. We offer our dentists competitive wages, great benefits including health insurance, paid time off and a 401(k) plan and a unique experience where they can focus on patient care. Explore the opportunities to grow at careers.coastdental.com.

Colgate 1705

Libertyville, IL
800-265-4283
colgateprofessional.com
Colgate-Palmolive is the global leader in Oral Care technology, products and education. Colgate’s products include technologically advanced toothpastes, toothbrushes, mouth rinses and floss. Our Colgate Oral Pharmaceuticals subsidiary provides professional fluoride, gingival health, toothwhitening and oral first aid products. Please visit our booth for additional information and an overview of our complete line of professional products.

Coltene 1235

Cuyahoga Falls, OH
800-221-3046
coltene.com
As your competent business partner, Coltene/Whaledent supports all aspects of dentistry and dental technology with innovative dental products and comprehensive dental solutions.

Columbia Bank 1010

Portland, OR
503-350-5376
columbiabank.com/business-banking/healthcare/dental-practices/national-dental-team
Columbia Bank specializes in working with the dental professionals in all 50 states. We provide competitive financing solutions for practice acquisitions, partnership buy-ins, practice remodels, debt refinancing, expansion, equipment and real estate.

Common Sense Dental Products 733

Spring Lake, MI
888-853-5773
commonsensedental.com
Common Sense Dental Products has developed several innovative products such as Flexi Wedge, Logi Bloc and Prep Check to make dentistry easier and more efficient.

Core Scientific 1644

CARY, IL
877-308-2388
core-scientific.com

CR Foundation Gordon J. Christensen Clinicians Report 1224

Provo, UT
888-272-2345
cliniciansreport.org
CR is the only non-profit dental research company committed to identify, evaluate and compare competitive dental products, concepts and techniques to determine those that are faster, easier, better or less expensive than others. Research funds come from subscriptions to the Gordon J. Christensen Clinicians Report®.

Crest + Oral-B 1105

Mason, OH
800-543-2577
dentalcare.com
Crest + Oral-B features a complete line of oral care products including Crest toothpaste and mouthwash, Oral-B electric rechargeable and manual toothbrushes, Crest Whitestrips, Glide floss and specialty products. Visit our booth or www.dentalcare.com to learn more. At Crest + Oral-B, we’re committed to providing you and your patients with quality products for excellent oral health.

Cross Country Healthcare 716

Boca Raton, FL
800-347-2264
crosscountryhealthcare.com
For over 35 years, Cross Country Healthcare’s family of brands has helped dental professionals customize careers with travel, locum tenens and per diem opportunities, nationwide.

Crown Tenant Advisors 935

Roswell, GA
770-649-8036
crowntenantadvisors.com
Crown Tenant Advisors is a boutique healthcare real estate firm. Our expertise representing dental practices along with in-depth knowledge of our geographic markets gives you a unique advantage. We conduct demographic reports, market analysis, and negotiate favorable terms to save you money. We work on your behalf, never the property owner, and offer unbiased advice with no conflict of interest. Our fees are paid by the landlord or seller, so you pay no out-of-pocket cost for our services.

Curve Dental 717

Provo, UT
770-286-0581
curvedental.com
Curve Dental is a leader in cloud-based dental practice management software that makes growing your practice easy, so you can focus on patient care. Curve SuperHero™ is the all-in-one practice management and patient engagement solution that eliminates the need for expensive, clunky add-on software. You can count on SuperHero for automatic patient communication, 5-star rated customer service, secure and easily accessible data, actionable reporting and insightful business intelligence.

CUTCO CUTLERY 1944

Canton, GA
678-592-8400
cutco.com

D4C Dental Brands 1925

Atlanta, GA
404-805-7800
smilesforlifework.com
The Smiles For Life Network is the largest and fastest growing Specialty Dental Support Organization. Exclusively Pediatric Dentistry and Orthodontics.

Dandy Dental Lab 1806

New York, NY
847-987-3470
meetdandy.com
Dandy is the first dental lab of its kind: full-service and fully digital. We offer the consistency and scale of a large, national lab, but with the same trust and feel of your small, local lab. Our mission is to provide the technology and support our partners need so they can focus on what they’re best at: treating patients. Come visit us to learn more about the future of digital dentistry and how we can support your practice’s transition from analog to digital.

Dansereau Health Products 840

Corona, CA
800-423-5657
dhp dental.com
Dansereau manufactures and sells direct to the dentis a full line of dental equipment. Made in the USA.

DCI Edge 2031

Newberg, OR
503-267-4888
dciedge.com

For over 35 years, our primary goal at DCI Edge has been to provide our customers with the highest quality service and products on the market. As a family-owned and operated company, we believe people come first. We not only offer the highest quality dental chairs, cabinetry, dental delivery systems and other dental tools and equipment, but we also provide outstanding customer service nationwide.

DDS Match South LLC. 1013

Brentwood, TN
614-402-3952
ddsmatch.com

DDS Match specializes in connecting buyers and sellers by integrating tremendous relationship capabilities, using a unique process for dentists “The Trusted Transition Process,” supported by a robust website and professional advice. We can assist with: practice sales, practice mergers, dental practice partnerships, associate placements, dental practice appraisals and dental real estate sales.

DENTAL CARE ALLIANCE. 906

Sarasota, FL
888-876-4531
dentalcarealliance.com

Dental Dynamic Staffing 1922

Parma Heights, OH
440-481-3131
dentaldynamicstaffing.com

Dental Dynamic Staffing is a nationwide dental staffing company who specializes in the placement of dentists, hygienists, dental assistants, EFDA and front office staff. Our placement services include temporary, direct hire and payroll services.

Dental Enterprises LLC - Magnetic Mallet . . 1226

Tuscaloosa, AL
205-799-3066
DentalEnterprisesLLC.com

Dental Enterprises LLC is a young company (2019) with an AMAZING NEW product for Dentistry! The MAGNETIC MALLETT Nothing simplifies Extractions, Condenses Bone, Facilitates Sinus Lifts and Controls Ridge Splitting like the MAGNETIC MALLETT, powered by patented Magnetic Dynamic Technology. Perform Extractions, Osteotomies, Sinus Lifts, Ridge Splits with one device. Oral surgery and implantology become more predictable and less invasive with NO heat; NO irrigation, NO bone loss, NO aerosol.

Dental Equipment Liquidators, Inc. . . . 1702

Hudson, FL
877-289-3368
DentalEquipment.com

Doing business since 1998, Dental Equipment Liquidators, Inc. specializes in High Quality Refurbished Equipment. Offering dental practices trusted brand named equipment, unsurpassed service, one-year warranties and the best prices, places us in the forefront and makes us a very smart option for all your dental equipment needs. Please stop by Booth #1702 to view our showcased products and show specials.

Dental Intelligence 1941

Pleasant Grove, UT
855-776-2673
dentalintel.com

Dental Intelligence, LocalMed and Modento are now combined into a single, powerful solution to help your practice provide more and better dentistry. Whether you need key insights about your performance as an individual or team; you want to give patients the ability to schedule their own appointments in real-time; or want to offer a beginning-to-end communication experience to better engage with your patients, Dental Intelligence is the partner you’ve been looking for.

Dental Lifeline Network 714

Denver, CO
303-407-1102
dentallifeline.org

The Donated Dental Services (DDS) program provides free, comprehensive dental treatment to our country’s most vulnerable people with disabilities or who are elderly or medically fragile. These are people who cannot afford necessary treatment and cannot get public aid.

Dental Office Support 1125

Graniteville, SC
803-624-6599
dentalofficesupport.com

Dental Office Support takes the bite out of insurance! Produce more. Collect more. Keep more. Rush service in just 4 hours. Outstanding US-based customer service. While the pandemic ran some of the industry’s best out of the verification business, we haven’t missed a beat and haven’t increased our fees? Dental Office Support also posts insurance payments and cleans up claims. We jump through hoops so you don’t have to. Finally, what you want. When you need it. Priced to make you smile!

Dental Tribune America 1711

New York, NY
212-244-7181
dental-tribune.com

The DTI publishing group is composed of the world’s leading dental trade publishers. Its combined portfolio includes more than 100 trade publications and multiple websites that reach more than 650,000 dentists in more than 90 countries and 25 languages. DTI’s collective activities also include the organization of continuing education programs as well as congresses and exhibitions.

DentalEZ 1441

Malvern, PA
866-383-4636
dentalez.com

DentalEZ® is committed to advancing the practice of dentistry through five distinct product categories: StarDental®, DentalEZ®, RAMVAC®, NevinLabs™ and Columbia Dentoform®. DentalEZ Integrated Solutions strives to create a complete line of products to elevate the health, comfort and efficiency of the dental facilities.

DentalPost 1634

Atlanta, GA
770-540-8585
dentalpost.net

DentalPost is the industry’s premier job board and community. With more than 750,000 job seekers in the U.S. and Canada, DentalPost connects dental professionals with dental offices to help create dental teams that excel. DentalPost leads the industry in metric-based career matching including personality tests as well as values, skills and work culture assessments to help dental offices hire right. The company recently launched DentalPost EDU, a platform to earn CE credits online.

The Dentist’s Choice 1606

Peachtree City, GA
770-412-3605
thehandpiecechoice.com

The Dentist’s Choice is your local handpiece repair expert. We can repair all major brands including pneumatic, electric, slow speed and attachments. In addition we offer new and refurbished handpieces for sale. We use high quality German parts for our handpiece repair.

Dentistry Today 1425

Fairfield, NJ
973-882-4700
dentistrytoday.com
Dentistry Today is the #1 Nations Leading Clinical News Magazine for Dentists, boasting new clinical articles each issue - written by authors in the profession. Specialty sections include: Buyers' Guides, Product Focus, Top Products, New Products Innovations, Spotlight and Technology product sections and Technology Today and Implants Today editorial sections. Please visit us at our website for information on how to advertise.

DentLight Inc. 1100

Plano, TX
877-570-9748
dentlight.com
DentLight has manufactured award-winning curing lights and loupe lights for over a decade including the 2017 Cellerant Best of Class Technology Award for the FUSION5 Curing Light with Twinhead Curing Attachment. DentLight also manufactures oral cancer screening devices, HD camera systems and lasers systems.

Designs for Vision, Inc. 1341

Bohemia, NY
800-345-4009
DesignsForVision.com
See The Visible Difference® with Designs for Vision's new Infinity VUE Loupes and High Definition Imaging (HDI) Headlights.

DeW Life 1008

Charlotte, NC
704-953-0261
dew.life
DeW Life Mag stands for Dental entrepreneur Woman. It is an online platform and print publication for all women in dentistry. Our goal is to inspire, highlight, empower and connect. It is FAB! For women, About women, By women. Please join our movement and help us to share our commitment of being our best in all things, using our gifts for ourselves and others by serving our profession. A rising tide raises all ships. Let's raise each other up to great heights and find our true calling and passion.

DG SHAPE, A Roland Company 741

Irvine, CA
949-727-2100-1261
rolanddga.com

Digital Doc 1000

El Dorado, CA
800-518-1102
digi-doc.com
Intra Oral Cameras

Digital Technology Partners 1035

Conyers, GA
770-918-0075
dtpartners.com
Digital Technology Partners [DTP] provides fast, reliable and secure IT solutions for dental practices across the U.S. We manage all aspects of your dental technology, so you can focus on providing excellent care to your patients. For more than 16 years, over 500 dental practices have trusted DTP for their helpdesk support, backup monitoring/updates, onsite support, IT projects, electronic waste recycling, custom dental software products and a full cybersecurity and HIPAA compliance program.

DIGITAL HEALTHCARE PROFESSIONALS . . 827

San Diego, CA
845-518-4678
digitalhealthcareprofessionals.com

Ditto Enterprises, LLC. 650

Montgomery, TX
713-824-3105
toothcollectorfairies.com
Stop by to meet the author of the *Tooth Collector Fairies* series and her *BFF Little Bird*. Purchase a signed copy of this award-winning children's book series and/or purchase a tooth fairy pillow handmade by the author. Check out embroidered book pocket pillow for your little readers at home. And for yourself - Pick out a one-of-a-kind beautiful handmade apron or piece of altered couture [ladies clothing] designed and handmade by Little Bird Products.

Doctor Multimedia 921, 1804

North Las Vegas, NV
909-234-2909
doctormultimedia.com
Doctor Multimedia is a full scale agency that is your one-stop solution to marketing your medical practice. We have graphic designers, WordPress developers, social media masters, content creators, SEO wizards, IT problem solvers, marketing gurus and all around ninjas ready to solve any and all problems your practice may face online. We help your practice grow, and succeed, in every facet of digital marketing.

Doctors Disability Specialists 1628

Middleton, MA
978-907-6005
llfg.net
The Doctors Disability Specialists are a team of financial representatives who have dedicated their career helping doctors of all types protect their income. The team is broken into two general divisions, medical and dental. Your business is unique, so the advice you get should be too.

Doctors Disability Specialists 1006

Middleton, MA
781-308-7930
llfg.com
Doctors Disability Specialists is a financial service office that provides education for students, residents and practicing dentists with their disability insurance options. DDS provides other various financial products for the needs of dentists.

Doral Refining Corp. 1208

Freeport, NY
800-645-2794
doralrefining.com
Refiners of precious metals, gold, silver, platinum, palladium and jewelry.

eAssist Dental Solutions 1333

American Fork, UT
844-327-7478
eassist.me
eAssist Dental Solutions is the provider of an electronic billing service for dental offices. The company's end-to-end solution eases the burden on office staff, while optimizing the claims payment and appeals process. eAssist ultimately helps practices be more efficient, profitable and customer-focused.

Eckard Enterprises LLC 1912

Allen, TX
972-884-5920
eckardenterprises.com

Elevate Oral Care 1330

West Palm Beach, FL
877-866-9113
elevateoralcare.com
Producing effective oral health preventive therapies are what we do, but the "why" is much more important. No patient, especially the very young/old and those with special needs, should ever suffer from the many afflictions associated with preventable oral diseases. We know you also care deeply about the "why". Education is key to success. Our team of Preventive Care Consultants delivers free Continuing Education presentations on keys to implementation of these important therapeutics.

WE ARE HERE TO SUPPORT YOU.



For more than 140 years, we've built relationships with and delivered industry-leading solutions to dental practices of all kinds. From dental supplies to office design, we're here with unmatched support to help practices modernize, grow and deliver the best possible care to every patient.

WE ARE PATTERSON.

Contact your local territory representative
pattersondental.com | 800.873.7683

Visit our Virtual Showroom
pattersondentalshowroom.com



22PD486450 AD (2/22)

Emergency Dental Group 2040

Atlanta, GA
 404-936-3400
edg.health

Enova Illumination 1543

Minneapolis, MN
 651-286-1162
goenova.com

ERC Specialists 1823

Lehi, UT
 574-780-0969
claimerccredit.com

Evolution Dental Surgery and Aesthetic Centers 1002

Duluth, GA
 706-951-3147
evolution.dental

Fast Track Construction 2003

Jefferson, GA
 404-313-3646
fasttrackbuilds.com

First Bank of the Lake 720

Greenville, SC
 561-289-8410
fblake.bank

As a nationwide SBA Preferred Lender, we have the resources and extensive experience to tailor solutions for your business. Our goal is to support your vision with financing that makes good business sense. If you're looking to start or expand your business, we offer loans that are designed to meet your needs.

First Citizens Bank 817

Atlanta, GA
 678-419-5062
firstcitizens.com

FiteBac Dental LLC 1709

Marietta, GA
 770-851-1186
FiteBacDental.com
 Largent Health LLC has targeted dental and skincare products designed for dental offices. FiteBac® the marriage of antimicrobial technology and material science, allows for the manufacture of modern dental products with sustained antimicrobial protection.

Florida Probe VoiceWorks 1608

Gainesville, FL
 317-313-5441
floridaprobe.com

Florida Probe Corporation has been the industry leader in computerized probing and charting for over 25 years. We provide dental professionals with innovative products that help detect, diagnose, and monitor all stages of periodontal disease. All of our products (Florida Probe, GoProbe, Dolphin Disposable and VoiceWorks) provide an interactive exam that dramatically increases patient acceptance of periodontal treatments.

Fotona 1230

Farmers Branch, TX
 214-906-7774
fotona.com/us

With over 50 years of laser expertise and industry leadership, Fotona has sold over 30,000 lasers worldwide with distribution in over 60 countries. Fotona produces award-winning lasers in dentistry, aesthetics, dermatology, gynecology and surgery. Having a strong history of dedication to R&D, Fotona has a reputation for unparalleled quality, reliability, ease-of-use and durability.

Freedom Day USA 1825

Bridgeport, WV
304-476-2254
oracareproducts.com
OraCare is a dental products company dedicated to raising the standard of care in dentistry. Utilizing activated chlorine dioxide and xylitol as the active ingredients, OraCare products are engineered to improve patient outcomes and care.

Garfield Refining 1335

Philadelphia, PA
800-523-0968
garfieldrefining.com
Established in 1892, Garfield Refining is a precious metals refinery located in Philadelphia. Our award-winning refinery buys gold, silver, platinum and palladium and offers the industry's highest payouts. Garfield is family owned and operated, and we have satisfied more than one million customers worldwide. Get in touch to discuss how we can help with your refining needs!

Garrison Dental Solutions 1427

Spring Lake, MI
888-437-0032
garrisondental.com
Garrison Dental Solutions has been helping clinicians achieve tight, predictable contacts on Class II composites since 1996. A privately held company that started in the back corner and basement of Drs. John and Edgar Garrison's dental practice, we now have offices around the world and are the premier manufacturer and market leader of sectional matrix systems worldwide.

GC America, Inc. 1630

Alsip, IL
800-323-8036
gcamerica.com
Founded in 1921, GC Corporation is one of the world's leading manufacturers of innovative materials, devices and equipment designed for use by dental professionals, laboratories and consumers. GC America, a subsidiary of GC Corporation for over 25 years and traces its own history back to Coe Laboratories, founded in 1928.

GEHA Connection Dental Network . . . 1633

Lee's Summit, MO
816-257-5500
connectiondental.com
GEHA Connection Dental Network - Gain access to more than 28 million covered lives through national directories that includes GEHA's FEDVIP members, other insurance companies, plan administrators and self-funded groups. Boost your business with new patients and referrals from the Network. Build your patient base for the long-term with a network that is growing right alongside your practice.

**Georgia Dental Assistants Association/
American Dental Assistants Association 825**

East Alton, IL
636-487-8276
adausa.org

Georgia Dental Association. 1810

Atlanta, GA
404-636-7553-119
gadental.org
The Georgia Dental Association is the state's largest dental association, dedicated to helping dentists succeed. Working on behalf of dentists in the state, the association promotes the highest standards of dentistry through education, advocacy and professionalism. Through the association's GDA Plus+ program (gdaplus.com), members have access to affordable business, personal and medical insurance products, savings on dental supplies, as well as exclusive discounts on products and services.

Georgia Dental Hygienists' Association . . 744

Norcross, GA
404-307-9827
gdha.org
The Georgia Dental Hygienists' Association represents over 7,200 hygienists throughout the state. Our members enjoy peer support, educational events and opportunities for participation in association decision making and public outreach efforts. We strive to advance the art and science of dental hygiene, and to promote the highest standards of education and practice in the profession.

Georgia High Tech Dental Lab Inc . . . 1730

Lawrenceville, GA
404-723-9034
gahightechdentallab.com
Since 2003, Georgia High Tech Dental Lab has served local dentists with personalized care. We have expanded our lab with state-of-the-art milling equipment to provide utmost restorations for our clients. We value our customers and go above and beyond to make sure they are satisfied. Fueled by our commitment to satisfaction, we strive to exceed our client's expectations.

**Georgia State University Byrdine F. Lewis
School of Nursing and Health Professions . . 1348**

Atlanta, GA
404-413-1239
admissions.gsu.edu/program/dental-hygiene-bs
The Georgia State University Bachelor of Science degree program is for registered dental hygienists with an associate degree. The degree is 100% online and will help you advance in the profession.

The Gideons International 1546

Nashville, TN
615-564-5000
gideons.org
The Gideons International distributes new Testaments with Psalms and Proverbs to all medical personnel at no charge in appreciation for what they do in our community.

Glidewell Dental 1220

Newport Beach, CA
800-854-7256
glidewelldental.com
Glidewell Dental provides high quality products and services specializing in crown and bridge, ceramic, sleep apnea appliances, removable full and partial dentures and dental implant restorations. Glidewell is a dental industry leader thanks to its innovative dental technology, esteemed R&D department and dedication to providing free clinical education to promote dental industry growth.

Global Dental Relief 950

Denver, CO
303-858-8857
globaldentalrelief.org
Our mission is to bring free dental care to children throughout the world. Volunteer dentists, hygienists, assistants and non-dental volunteers deliver treatment and preventive care in dental clinics that serve children in schools, orphanages and remote villages.

Golden Dent 1331

Roseville, MI
877-987-2284
golden-dent.com
Detroit based third-generation family dental instrument manufacturer of simple, predictable and unconventional solutions to dentistry that rely upon eighty years of dental knowledge and experience. Our unconventional instrumentation and techniques provide simple solutions to historically frustrating dental procedures, including the Physics Forceps atraumatic extraction system and much more.

Gordon J. Christensen - Practical Clinical Courses 1222

Provo, UT
800-223-6569
pcc dental.com
Practical Clinical Courses has a wide range of DVDs covering the many areas of dentistry. Our DVD library contains over a hundred titles on many topics. These DVDs are for all members of the dental team, as well as patients. Each DVD offers the viewer CE credit for their various educational obligations. Small-sized, personal hands-on courses at our facilities in Provo, Utah include oral surgery, fixed prosthodontics, esthetic dentistry, occlusion, and more.

Greater New York Dental Meeting842

New York City, NY
212-398-6922
gnydm.com
The Greater New York Dental Meeting is the largest Dental Convention/Exhibition/Expo in the United States. This annual convention, in its 98th year, has an exhibit floor consisting of over 650 companies. In addition, there are over 300 seminars and hands-on workshops taught by the world's leading clinicians. In 2019, there were over 52,614 registrants which included over 20,000 Dentists from all 50 states and 156 countries. PRE-REGISTRATION IS ALWAYS FREE!

Halyard Global Products 1430

Mechanicsville, VA
804-723-7000
halyardhealth.com
Halyard Health is a global leader in infection prevention solutions in the healthcare market. Halyard Health serves hospitals, surgery centers and other medical facilities, as well as physician offices, laboratories and dentists with personal protective equipment such as exam gloves, face masks, protective apparel, sterilization wrap, as well as patient care products including cold therapy packs.

HansBiomed USA 1714

Santa Fe Springs, CA
562-777-7043
store.hansgbr.com
HansGBR, Guided bone regenerative products are manufactured directly from HansBiomed Corp., the first tissue bank in Asia, with the aim to deliver quality, safe and new possibilities to healthcare professionals and patients. As a global leader in implant, restorative and regenerative dentistry, we share your passion for safety and quality to achieve the best restorative outcomes in bone regeneration.

Heartland Dental 1651

Effingham, IL
217-240-8685
Heartland.com
As the nation's largest dental support organization, Heartland Dental provides non-clinical administrative support so dentists and their teams can focus on delivering high-quality clinical care and excellent patient experiences. Our support includes assistance with HR, marketing, IT, supplies, insurance credentialing, accounting and more. In addition, we're committed to providing supported doctors and hygienists with an abundance of C.E. programs and leadership development opportunities.

Henry Schein Dental Practice Transitions. . 1026

Sanford, NC
919-316-8537
dentalpracticetransitions.henryschein.com
Finding dental practices for sale, selling a dental practice, hiring an associate and taking on a partner are all important crossroads you will face during your career as a dentist. You can trust Henry Schein Dental Practice Transitions to be your guide through every stage of your career.

Henry Schein Orthodontics 1024

Carlsbad, CA
442-359-0721
henryscheinortho.com/
Our mission at Henry Schein® Orthodontics™ is to enable beautiful, healthy smiles through passionate customer collaboration. For 45 years, this deep sense of affiliation has driven the development of ground-breaking appliances, innovative treatment solutions and ongoing education that foster exceptional patient finishes and accelerated treatment times for increasing practice profitability.

Hiossen 1012

Atlanta, GA
678-705-2561
hiossen.com
Hiossen provides a broad spectrum of dental implant technologies that offer reliable, safer and effective outcomes for your implant surgery. Our team strives to provide the best surgical and restorative outcomes by conducting rigorous testing, research, clinical studies and services which we have proven through our dedication to improving the quality of life of edentulous patients.

Holy Spirit Ranch Ministries949

Jasper, GA
706-253-5441
holyspiritranch.org
Holy Spirit Ranch ministry will be conducting our next free dental clinic on Pine Ridge Reservation this June. We also minister to the homeless in Atlanta at Woodruff Park every Sunday at 3 p.m. Church service, food, clothing, trips to Kenya, Africa and the Philippines.

HuFriedyGroup 1005

Chicago, IL
800-483-7433
hufriedygroup.com
HuFriedyGroup, a global leader in instrumentation, infection prevention and instrument reprocessing workflows, helps dental professionals be the best in practice with the highest quality products, services and educational experiences in the industry. With HuFriedyGroup, clinicians can reduce risk, improve efficiencies, drive compliance, enhance patient and staff safety, and achieve superior clinical performance to continue to be the best in practice.

The Huntington National Bank 1443

Columbus, OH
504-452-2576
huntington.com
Business owners look to The Huntington National Bank for broad expertise ranging from business acquisition and start-up financing to cash management and more. With assets of \$109 billion, Huntington delivers commercial, small business, insurance and consumer banking to businesses and consumers across eight Midwestern states through a network of 950 branches and 1,770 ATMs. The Huntington National Bank is Member FDIC.

Hunza Dental 1905

Deer Park, NY
908-783-5766
hunzadental.com

Impladent Ltd. 1124

Jamaica, NY
718-465-1810
impladentltd.com
Impladent Ltd offers OsteoGen® Bioactive Resorbable Calcium Apatite, TriStar® Bone Graft Fixation Screw Kit, allografts and membranes, including OsteoGen® Bone Grafting Plugs/ Strips - one-step solutions for socket/ridge preservation. Our collagen plug filled with graft is an easy, affordable way to graft extraction sites with no need for additional membrane.

Integrity Dental Services. 913

Duluth, GA
470-222-2902
integritydentalservice.com

Invisalign iTero 705

Morrisville, NC
732-586-2285
invisalign.com; itero.com; aligntech.com
Align Technology is a global medical device company with industry-leading products including the Invisalign® system, the most advanced clear aligner system in the world, and iTero® intraoral scanners and services. Align’s products help dental professionals achieve the clinical results they expect and deliver effective, innovative dental options to their patients.

iotech International 1349

Boca Raton, FL
561-509-0205
iotechinternational.com

itrac llc. 1031

Portland, OR
541-342-2958
illumitrac.com
illumitrac Software and Dental Revolution are two brands under the itrac llc brand family that provide leading-edge solutions to grow your practice revenue from automating your in-house membership club to marketing strategy customized to your practice and goals.

Ivoclar Vivadent 806

Amherst, NY
800-533-6825
ivoclarvivadent.com
Since our founding in 1933 in Schaan, Liechtenstein, Ivoclar Vivadent has evolved into a market-leading provider of innovative dental materials for quality esthetic dentistry. Our products are used by dental laboratories and dentists in over 100 countries throughout the world. Our employees are dedicated to your success by providing world-class technical and customer support through education programs offered at our 21 International Centers for Dental Education located throughout the world.

J. Morita USA, Inc. 1240

Irvine, CA
800-831-3222
morita.com/usa
Established in 1964, J. Morita USA is one of the leading manufacturers and distributors in the dental market with a full line of innovative, high quality products. J. Morita USA offers 3D/pan/ceph X-ray equipment, handpieces, endodontic and chairside products, as well as consumable dental supplies such as bone regeneration material, impression material and restoratives.

Jeunesse Innovations. 812

Hollywood, FL
754-444-8985
elevareskin.com

Karl Schumacher Dental, LLC 1928

Linden, NJ
800-523-2427
karlschumacher.com
For over 60 years, Karl Schumacher Dental Instruments has provided the profession with the highest grade of German quality instrumentation. Stop by our booth to see the latest additions to our line including Titanium Implant Currettes and new surgical instruments.

Keating Dental Lab 1817

Irvine, CA
949-955-2100
keatingdentalarts.com
Keating Dental Arts (KDA) is an award-winning, full service dental lab located in Irvine, CA. Established in 2002, KDA strives to do business with this simple thought in mind: to add value to your dental practice. By receiving a high quality restoration, along with reliable, friendly service, a dental practice is bound for success. Part of our success is sharing in the growth of your practice. We look forward to helping you continue “Creating Smiles Everyday.”

Kenwood / Wired Fox. 1225

Greer, SC
855-770-7194
twowayradiocenter.com
Kenwood Business Two-Way Radios

Kettenbach 821

Huntington Beach, CA
877-532-2123
kettenbach-dental.us
Founded in 1944, Kettenbach GmbH was created for the development and marketing of medical and dental products. Today, the company is one of the leading international producers of impression and resin materials for dental use and is also known in other surgical areas of medicine.

Kilgore International, Inc. 1234

Coldwater, MI
800-892-9999
kilgoreinternational.com
Kilgore International Inc. (since 1955) specializes in anatomical models for patient and student education. We offer a vast variety of dental implant models, plastic skulls, pediatric dental models and endodontic models for easy case presentations.

Kleer 1743

Wayne, PA
844-965-337
kleer.com
Kleer, the leader in subscription dental membership plans, is on a mission to liberate dental care. Its advanced, cloud-based platform allows dentists to reclaim control of the dental marketplace from insurance companies by creating membership plans to offer directly to patients. With Kleer, dentists can grow their practices, serve more patients and offer those patients the highest levels of care. Patients get better, more affordable care without jumping through insurance company hoops.

Kube Innovation 1129

Montreal, QC
800-511-8792
kubecoinnovation.com

LabStore 1211

Duluth, GA
678-584-4884
atlantadental.com
ADS Lab Store carries all major brands of teeth, lab supplies and equipment. Our customer service team is experienced and friendly! All tooth orders will arrive next day anywhere in the USA. Our great prices and personal care is making us the fastest growing laboratory supply company in the country!

LED Dental 916

Vancouver, BC
949-680-8382
velscope.com
The VELscope® Vx Enhanced Oral Assessment System is an award-winning device for adjunctive oral screening, utilizing proprietary tissue fluorescence technology to aid in the visualization of oral mucosal abnormalities that may not be apparent or visible to the naked eye, including oral cancer, pre-malignant dysplasia, infections and trauma. In addition, the VELscope Vx can be used to aid in the identification of diseased tissue.

Leixir Dental Group 1700

Pearl, MS
601-854-5554
leixir.com
The Leixir Group is a partnership of a growing international group of full-service, state-of-the-art dental laboratories with a focus on digital dentistry. This unique focus extends to providing pathways to acquiring intra-oral scanners to our dentist clients.

Lighthouse 360, a Henry Schein One Company 1023

New York, NY
888-704-3592
lh360.com
Lighthouse 360 is an automated patient communication system that helps dental practices save time, minimize broken appointments, and keep the schedule full. Built specifically for dentistry, the software works like an extra member of the dental staff, handling the most repetitive daily tasks so the practice can focus on the patients within the practice.

LIGHTMED Corporation 1346

San Clemente, CA
949-218-9555
lightmed.com
LIGHTMED is a medical device and technology company focused on developing, manufacturing and marketing a wide range of innovative laser systems for the ophthalmic, dental and dermatology markets. Our leading technologies are used to treat a variety of medical conditions, improving the lives of millions of people. LIGHTMED has been in business since 1997 with its own R&D and manufacturing facilities located in the U.S.A. and Taiwan. All of LIGHTMED's products are backed by an industry-leading warranty.

Listerine 804

Skillman, NJ
862-222-7631
listerineprofessional.com

Live Oak Bank 1122

Wilmington, NC
877-890-5867
liveoakbank.com/dental
Live Oak will support you with customized loan products focused on your success. With a fusion of extraordinary service and expertise, our team embraces a creative approach to solving problems and surpassing goals. We understand the nuances of your business model and will help you avoid costly mistakes. This is more than just your day job – it's who you are. Let's craft a loan solution that will help you thrive.

LUMADENT, INC. 1717

Reno, NV
775-829-4488
lumadent.com
LumaDent provides the best option available for high-quality loupes and headlights at the best price! Combined with unbeatable customer service LumaDent truly is The Brighter Choice. Stop by our booth and ask about our show specials!

M.A.R.S Bio-Med Processes Inc. 1004

Whitby, ON
866-594-3648
marsbiomed.com
M.A.R.S is the manufacturer of the LibertyBOSS Amalgam Separator. The ONLY system that can service a Dental Practice for up to 3 years with NO Filters, NO Maintenance, NO Inspections, comes with a WRITTEN Guarantee of Compliance and FREE Advertising as Environmentally Friendly! Visit M.A.R.S to learn why Dental Practices all over the United States are upgrading to the LibertyBOSS.

Mango Voice 1928

St. George, UT
435-900-1114
mangovoice.com

Maxilla Marketing 1713

Amherst, NY
585-298-1778
maxillamarketing.com

McGill & Hill Group 1423

Charlotte, NC
704-424-9780
mcgillhillgroup.com
McGill & Hill Group is a one-stop financial services resource for the dental profession, based on our "every step of the way" team approach. You'll receive the highly-skilled guidance it takes to move your dental practice step-by-step through tax and business planning, practice management, transitions, legal, accounting, investment advisory and retirement plan services. Stop by our booth for a recent issue of our monthly newsletter *The McGill Advisory*.

Medentika 1520

Andover, MA
800-448-8168
medentika.com
MEDENTIKA® supplies dental technicians, dentists and patients with an attractive system of precise implants and durable abutments, compatible with all popular manufacturers. Anyone who meets MEDENTIKA® personnel will get to know a team...a team that perfects products with élan – on a daily basis and with passion.

MEDI LAZER 1601

Las Vegas, NV
844-556-3120
medilazer.net
Our mission statement is simply "Quality Not Compromise" is ingrained in every aspect of our business, from an unwavering belief in the limitless potential applications of low-level laser, down to the care and quality of the smallest component of our devices.

Medi Loupes 1016

Las Vegas, NV
716-946-3167
mediloupes.com
Medi Loupes offers top quality loupes and lights at the lowest prices. Our industry leading lifetime warranty and quality are second to none. Stop and see why we have excelled over the rest.

Medical Missions Outreach 1046

McDonough, GA
843-813-3740
medical-outreach.com

Medidenta 1020

Las Vegas, NV
800-221-0750
medidenta.com

Medidenta has bundles that include free handpieces and accessories to save you money and increase productivity. Recommendations for sterilization are now active in 13+ states. Check out the newest technology in Medidenta's Air Free line. Come discuss our Bur Invitation where you'll lock in low rates for a whole year on all types of burs, even DIAMOND. Medidenta also services all brands of handpieces.

MGE Management Experts 834

St. Petersburg, FL
727-530-4277
mgeonline.com

MGE Management Experts is the leader in practice management training for dentists, dental specialists and their teams. Arguably the largest dental practice management company in North America, if not, the world and educate over 1,000 dentists and staff every month. For 28 years MGE has offered a series of courses, seminars and practical implementation steps designed to give a doctor the KNOWLEDGE to GROW THEIR BUSINESS so that they can practice the WAY THEY WANT.

Microcopy 1509

Kennesaw, GA
800-235-1863
microcopydental.com

For over 50 years, Microcopy has been at the forefront in the design and development of single-patient-use diamond and carbide burs for the dental industry. Our award-winning products are some of the most well respected on the market. With a global presence we continue to educate the world on the importance of single-patient-use products.

Midmark Corporation 1132

Versailles, OH
800-643-6275
midmark.com

A leader in the dental industry, Midmark is designing better care with an integrated portfolio of dental clinical and digital solutions that enable its customers to maximize profitability, increase efficiency, ensure safety and enhance patient care. Midmark Dental provides innovative patient care solutions with the most advanced technology on the market to help create a safe, inviting and comfortable environment.

Millennium Dental Technologies, Inc. . 1511

Cerritos, CA
888-495-2737
lanap.com

Millennium Dental seeks to bridge the growing divide between gum disease patients and dentists by providing a comfortable patient experience with bone-building clinical results. The FDA-cleared and patented LANAP® Protocol, offers a vastly less painful and less invasive alternative to flap surgery. The PeriLase® MVP-7 is designed for The LANAP® Protocol and is packaged with five days of training.

Modern Doc Media 1541

La Jolla, CA
866-509-5054
moderndocmedia.com

Modular & Custom Cabinets 1441

Maple, ON
800-388-6236
mccdental.com

Momnt 1448

Atlanta, GA
703-362-4900
heyartis.com

MVB Bank 1840

Bridgeport, WV
801-477-7798
mvbbanking.com/business/small-business-lending
MVB Bank Practice Finance is a national direct lender that specializes in the dental industry. Our creative loan structures promote cash flow, growth, and liquidity for our clients. Each member of our team of industry specialists has 10 – 20 years of experience lending to the dental community we serve. Our team is open to speaking directly to business owners, as well as industry specialists, consultants and brokers who are representing business owners with financial needs.

Nadia International, Inc. 1320

Austin, TX
800-237-1868
ronadro.com
Nadia International, Inc. will display educational/dental bronze and porcelain sculptures created by the world famous sculptor, Ronadro. Ronadro has over 7,900 dentists in 80 countries that collect his museum quality works of fine dental art. His works of art are displayed at the Smithsonian Institute, National Museum of Dentistry in Baltimore and various dental universities all over the world.

Nashville Dental Inc. 1429

Madison, TN
615-868-3911
nashvilledental.com

Products and services to support, sustain and grow healthy dental practices, NDI offers numerous products and services to support the local dental profession. Nashville Dental is a partner for all stages of your practice's life cycle. Whether you are a dental student preparing for graduation, an experienced dentist with an established practice or a retiring dentist looking forward to your golden years, we can help you accomplish your goals.

Neodent 1520

Andover, MA
855-412-8883
neodent.com

Neodent® is a global brand available in more than 60 countries, with more than 1.6 million implants sold annually, focused on progressive treatment concepts. Neodent® is the second largest dental implant company worldwide with a proven record of clinical success and professional and patient satisfaction.

Nobel Biocare USA 1507

Yorba Linda, CA
800-993-8100
nobelbiocare.com

Nobel Biocare is about you, for your patient. That's our promise. And it's a promise based on over 65 years of research and development in implantology, ever since Per-Ingvar Brånemark's groundbreaking discovery of osseointegration, and first ever dental implant treatment. But we never settle for the status quo. We follow no one. We are bold innovators to the very core, doing whatever it takes to improve the possibilities for professionals to treat more patients better.

Nobio / Infinix Products 816

Middlebury, CT
203-313-9269
nobio.com

North American Dental Group 1223

New Castle, PA
517-403-5260
nadentalgroup.com
North American Dental Group is transforming the dental experience. A tall order that begins with empathy. Caring and understanding are at the core of this transformation. Complete care for our patients, caring for one another and caring for the work we do. It is our foundation and it will define us now and in the future. As we grow, we seek to be best-in-class in every aspect.

NSK America Corp. 1721

Hoffman Estates, IL
888-675-1675
nskidental.com

NSK America specializes in ultra-high-speed rotary equipment and create innovative products that deliver outstanding value. NSK delivers a growing range of dental equipment including air-driven and electric handpieces, specialty handpieces (endo, surgical, hygiene), electric motors and maintenance systems. Almost all parts are manufactured in-house to guarantee the highest precision, reliability and unmatched performance of all products.

Oak Dental Partners 1904

Alpharetta, GA
404-710-2794
childrenandteendental.com

On Demand Orthodontist 2000

Bismarck, ND
404-465-3390

ondemandorthodontist.com

ODO is a concierge assisted Orthodontics platform that utilizes AI in patient monitoring along with world class aligner expertise to support clinicians in treating most case complexities in four appointments or less.

On Pointe Business Solutions 1002

Madison, GA
706-343-4063
dentalops.net

Onpharma Company 1131

Sutter Creek, CA
877-336-6738
onpharma.com

Onpharma Co. designs, markets and sells products that improve local anesthetics in dentistry. The Company's Onset® Buffering System provides dental practitioners a simple and convenient way to buffer local anesthetic cartridges to a neutral pH at chair side immediately before delivering the local anesthetic injection. Chair side buffering using the Onset system will make your local anesthetic better, whether you are using Articaine, Lidocaine, Prilocaine or Mepivacaine.

Onsite Dental 700

Aliso Viejo, CA
949-305-2449
onsitedental.com



KEATING
DENTAL LAB

YOU CAN COUNT ON KEATING

Get 50% Off on the first 5 Keating Dental Custom Implant Abutments with Bruxer® or Bruxer Aesthetic Restorations®!

*Offer valid for new Keating customers and for current customers who have never ordered Keating Custom Abutments before. Offer ends June 30, 2022. Restrictions apply.



www.keatingdentallab.com/50off

OraCare 1924

Bridgeport, WV
304-476-2254
oracareproducts.com

OraCare is a dental products company dedicated to raising the standard of care in dentistry. Utilizing activated chlorine dioxide and xylitol as the active ingredients, OraCare products are engineered to improve patient outcomes and care.

Oral Cancer Cause 1147

Largo, FL
727-599-8153
oralcancercause.org

Orascope 1605

Madison, WI
800-369-3698
orascope.com

A pioneer in medical vision for over 30 years, Orascope™ designs award-winning dental loupes and headlights that focus on magnification, illumination and ergonomics. Engineered with performance in mind, Orascope loupes employ rich details such as adjustable nose pads, flexible temple hinges and working distances refined in half-inch increments.

OSAP (Organization for Safety, Asepsis and Prevention) 926

Atlanta, GA
404-944-4824
osap.org

The Organization for Safety, Asepsis and Prevention (OSAP) is a growing association of clinicians, educators, researchers and industry representatives who advocate for safe and infection-free delivery of oral healthcare. OSAP offers an extensive online collection of resources, publications, FAQs, checklists and toolkits that help dental professionals deliver the safest dental visit possible for their patients.

PDT, Inc.-Paradise Dental Technologies . . 1808

Missoula, MT
800-240-9895
pdt dental.com

The fastest growing instrument company in the world since 2000. The Montana Jack®, Amazing Gracey™, FlipTop Cassettes™, Gleason Guide™, and the Wingrove™ Titanium Implant instrument designs are unsurpassed in every criteria of instrument evaluation. Check out our new Restorative and Surgical line.

Pharmacists Mutual Insurance Company . . 1716

Algona, IA
800-247-5930
phmic.com

Pharmacists Mutual Insurance Company is a nationally recognized leader and provider of insurance products and risk management solutions for pharmacists, dentists, veterinarians and associated businesses and professionals. For over a century, Pharmacists Mutual has provided peace of mind to its members through specialized insurance products and superior personal service.

Pharmanex 1652

Dunwoody, GA
404-538-5608

Pharmanex provides patented nutritional testing equipment and high quality nutritional products that support oral (including periodontal) and systemic health. Our Biophotonic scanner measures antioxidant levels with a 30 second, non-invasive test. Our program creates an additional revenue source for your practice while it supports you in lifting your patients' health. Published clinical studies substantiate the direct relationship between increased antioxidants and improved oral health.

Philips Sonicare and Zoom Whitening . . 1515

Stamford, CT
201-251-5000
philipsoralhealthcare.com

From its number one dental professional recommended Sonicare toothbrush to Philips Zoom! whitening systems, Philips provides dental professionals with advanced solutions designed to meet their patient's specific needs and inspires consumers to achieve superior oral health.

PLANMECA USA, Inc. 1115

Hoffman Estates, IL
630-320-2877
planmecausa.com

Planmeca is one of the largest privately held companies in the dental equipment market. We provide 2D and 3D imaging, Intra oral scanning, milling, 3D printing, custom cabinetry, dental units and software solutions for your high tech clinic. We make patient safety a priority. Planmeca's exclusive Planmeca Ultra-Low Dose protocol's and extra oral bitewings image patients with less radiation. Stop by our booth to learn how. Our Emerald scanner is the fastest in the industry, come give it a try.

PNC Healthcare Business Banking 933

Atlanta, GA
216-222-2992
pnc.com/hcprofessionals

At PNC, our Healthcare Business Bankers work exclusively with dentists and healthcare providers. Our experience, expertise, and consultative approach helps enable us to diagnose and prescribe unique solutions to optimize cash flow and offer customized financing for practice debt refinance, ownership transitions, practice expansions, real estate and equipment finance.

Podium 1210

Lehi, UT
801-541-0198
podium.com

Podium helps businesses make interaction with consumers simple and convenient by focusing on familiar communication channels they already use. Increased interaction makes businesses more visible, improves business operations and drives purchase decisions. Podium serves 130,000+ users across nearly 15,000 businesses and is redefining the modern relationship between businesses and consumers.

Porter Royal Sales 1041

Hatfield, PA
425-353-8802
royaldentalgroup.com

Royal Dental Group & Porter Instrument is the leading manufacturer for dental stools, chairs, operating equipment, cabinets, units, sterilizers and Nitrous Oxide under brand names Royal Dental, Biotec, Inc., Proma, Inc. and Porter Instrument Company, Inc.

Power Dental USA 726

McHenry, IL
815-363-8003
mydentalusa.com

Power Dental USA Inc. offers a complete line of precision diagnostic, operative, restorative, hygiene, periodontal, surgical, piezo bone surgery, implant system kits and implant instruments. Retipping and sharpening services are also available. We also offer a trade in discount.

PPM- Professional Practice Management . . 1211

Duluth, GA
800-643-4361
ppmgt.com

PPM provides monthly dental accounting and tax services as well as practice buy/sell services. If you are thinking of selling your practice or looking for a practice to purchase, we can help. Our livelihood does not depend on practice sales so our advice is based on what is best for both parties. We help both buyers and sellers with information needed to make smart, well-timed decisions. Speak confidentially with one of our transition specialists to see how we can meet your specific needs.

PPO Profits 914

Chicago, IL
800-613-1695
ppoprofits.com
PPO Credentialing, Negotiations and Claims Processing

The Pankey Institute 1626

Key Biscayne, FL
305-428-5500
pankey.org

The Pankey Institute provides visionary dental education addressing the technical, philosophical, behavioral and financial habits necessary to build a successful practice and achieve a work/life balance. We deliver education in a community of learners and inspire dental professionals to narrow the gap between what is known and what is practiced.

Practice Pathways - Zions Bank 1042

Salt Lake City, UT
843-754-5067
practicepathways.com

Practice Pathways® provides professional practice loans to help you acquire a practice, expand an existing practice or refinance your practice loans.

PracticeLife. 1211

Duluth, GA
833-872-9203
PracticleLifeDental.com

Practice Life is a network of companies with unique services to help Grow, Protect and Strengthen your practice. Discover a pre-negotiated fee schedule pays up to 30% higher fees than most plans. Learn new tools for strengthening your practice leadership and for making strategic financial decisions. Take a look at the fastest growing practice management software that happens to be free! Plus, new efficiencies for every team member and education for the patient.

ProDentUSA 905

East Brunswick, NJ
732-390-5532
prodentusa.com

At ProDent USA, we know what goes into making a quality instrument that will make your dental work easier. With over 30 years of experience, we skillfully craft each instrument to ensure it meets the needs of our individual customers. We are so confident in our quality that we back all of our instruments with a one-year warranty.

Professional Sales Associates, Inc. . . . 1441

Seville, OH
330-299-7343
profsales.com

Professional Sales Associates is a manufacturers representative group for Dental Equipment. The following are the manufacturers we represent: DentalEZ, Accutron by Crosstex, Forest Dental Equipment, ICW International, Crown, RAMVAC, StarDental, Tuttnauer and Modular & Custom Cabinets, LTD, MCC. Our wide range of products covers a majority of the essentials needed in the dental practice.

Prophy Magic 1020

Las Vegas, NV
800-221-0750
prophymagic.com

Ask about our CDC bundles with bulk handpieces to get you compliant with the new regulations recommended by the CDC and put the top-rated prophy angles in your office at the same time. We have the latest technology in Cordless to hit the dental industry, CR rated Air & Water Syringe Tips, high-speed solutions, burs, paste and more. Booth Number 1219 is one you can't afford to miss. Ask about all our FREE incentives.

Provide, Inc. 1032

San Francisco, CA
440-228-7365
getprovide.com

The industry's only digital finance company, we save you time and resources so you can focus on buying or expanding the practice of your dreams. We provide dentists, veterinarians and other healthcare practitioners a seamless experience as they build, grow and elevate their practices – and it's built just for you.

Pulpdent Corporation. 1206

Watertown, MA
617-926-6666
pulpdent.com

PULPDENT® Corporation is a family-owned dental research and manufacturing company that is leading the way in bioactive dental materials.

Q-Optics & Quality Aspirators 940

Duncanville, TX
800-858-2121
q-optics.com

Q-Optics is dedicated to manufacturing high end magnification and supplying practitioners with a high-quality, lifetime guaranteed, custom fit loupe system.

RecallMax 1133

Lehi, UT
800-651-8603
recallmax.com

RecallMax is a software solution that focuses on keeping your schedules full. We go beyond just automated patient communication and offer a multi-pronged approach to recall that picks up where automation stops. Recall shouldn't be a four letter word, and that's why our software is tailored to helping with the core issues that impact the success of recall management in the practice.

RGP Dental Inc 941

Bristol, RI
800-522-9695
rgpergo.com

RGP is the leading manufacturer in ergonomic seating in the dental industry. Since 1996 we have been making the workplace more enjoyable and more comfortable for thousands of professionals. Our unique seating systems and arm support attachments target all of the main areas where people experience fatigue and pain. Stop by booth #941 at this years meeting and see how we can help you become more productive and pain free!"

Ritter Dental USA. 704

San Antonio, TX
210-805-8931
ritterdentalusa.com

At Ritter Dental USA, our priority is providing superior Dental Equipment, featuring German craftsmanship, to professionals around the globe. We offer the most innovative and highly functional Dental Units on the market today, specially built to anticipate the needs of patients and professionals. Let us serve as your trusted provider of Dental Instruments, chairs, stools, compressors and other products that are vital to your practice.

Rose Micro Solutions 1135, 1617, 1741

West Seneca, NY
716-608-0009
rosemicrosolutions.com

Rose Micro Solutions sells high quality optical loupes & LED lighting systems for less! We are a "family" business consisting of four brothers. We named the company after our mother "ROSE". Stop by our Booth(s) to see our "NEW" line of custom Rayban & Oakley TTL Loupes, you'll love the optics!

Safe RayZ. 959

Lexington, KY
859-608-1579
saferayz.com

Invented by a dentist and hygienist with a combined 35 years of experience in dentistry, Safe RayZ™ is a tool used to assist clinicians to effectively and efficiently capture X-rays without putting their health at risk.

Sage Dental 1712

Boca Raton, FL
561-999-9650
mysagedental.com

Sage Dental is a leading dental support organization in Florida and Georgia. Offering cosmetic, preventive, general, reconstructive and specialty dentistry, Sage Dental has over 70 convenient locations throughout Florida and the Atlanta area. Sage Dental equips all of its supported dentists and staff members with CE, leadership skills training and a wealth of administrative services that include human resources, marketing, office administration and purchasing.

Salvin Dental. 805

Charlotte, NC
800-535-6566
salvin.com

Salvin Dental® / Salvin Regenerative® "Everything For Your Implant Practice But The Implants®" AmnioExcite™ 3-Layer Placental Membrane, SalvinOss® Xenograft Bone Material, AlloSculpt-3D® Bone Putty, RenovixPLUS™ Resorbable Membrane, CytoSurg® PTFE Membranes & Sutures, LifeNet Health Allograft Bone Materials, OraMEM® Collagen Membranes, Specialized Surgical Instruments, Fixation & Tenting Screw Kits, Membrane Tack Kits, Implant Motors, Headlamps, Infection Control.

SciCan / Coltene 1235

Canonsburg, PA
800-572-1211
scican.com
SciCan Inc. manufactures and distributes through dental dealers our line of sterilizers, surface disinfectants, instrument washers, dental handpieces and electric motor systems, sterilizer monitoring products and automatic care and maintenance handpiece systems.

Scratch 830

Pasadena, CA
855-727-2395
get.scratchpay.com/dental
Why Scratch? Payment plans starting as low as 0% APR No hard credit checks or hidden fees Higher loan approval rates Available at 12,000 medical practices Easy, 2-minute application with instant approval decision Checking rates and accepting plans never impacts your credit score Scratch Plans: Simple, convenient, secure. Care now, pay later with Scratch!

SGA Dental Partners 1033

Richmond Hill, GA
912-225-5040
sgadental.com

Shining 3D Technology Inc..807

San Francisco, CA
415-259-4787
shining3ddental.com
Shining 3D provides fully integrated 3D digital dental solutions, from obtaining 3D data with 3D scanners for lab and intraoral 3D scanners for clinics, then design with professional dental CAD software, to printing dental products, including working models, orthodontics models, implant models, surgical guides, wax-ups, partial frameworks with 3D printers.

Shofu Dental Corporation 1322

San Marcos, CA
800-827-4638
shofu.com
Shofu Dental, home to some of the most innovative, award-winning products in dentistry. Products such as the EyeSpecial digital dental camera, the bioactive and therapeutic “Beautiful” line of Giomer restoratives, and our industry standard abrasives and polishers. We are looking forward to helping you.

SignaPay Medical 1931

Oakbrook Terrace, IL
630-390-4554
signapaymd.com

Simplifeye 1610

646-846-7467
simplifeye.com
Grow your practice. Capture new patients instantly with Amplify by Simplifeye: the first ever 24/7 Live HIPAA-compliant web chat run by dental professionals. Provide patients with an easy way to communicate with your practice when it’s convenient for them, ultimately landing well-qualified referrals in your practice. Our live chat specialists respond within seven seconds, answering questions and gathering the relevant information. Just think how much time that will save your front office team!

Simply Hygiene 1211

Duluth, GA
678-584-4970
simplyhygiene.com
Simply Hygiene provides support, innovation and education to dental hygienists and dental hygiene students. We welcome you to open your own personal account to purchase hygiene supplies at a great value and receive the attention and support you deserve!

The Smile Defenders 1827

Bridgeport, WV
304-476-2254
oracareproducts.com
OraCare is a dental products company dedicated to raising the standard of care in dentistry. Utilizing activated chlorine dioxide and xylitol as the active ingredients, OraCare products are engineered to improve patient outcomes and care.

Snap On Optics 1121

602-272-0827
snaponoptics.com
Snap On Optics is an industry loupes and light manufacturer. Our products are created for reliability, universal compatibility and portability. See clearer with our through the lens loupes and last longer with our extended 16 hour battery pack. Check us out and experience the difference yourself.

Sodium Dental641

Ann Arbor, MI
800-821-8962
sodiumdental.com
Sodium Dental is a leader in Dental Technology Integration and digital x-ray sensor repair. Sodium Dental services dentists all over the world for sensor repair, digital x-ray technology manufacturing, digital imaging, installation, sales, training and support. Visit Sodium dental at booth 641 to LEARN more and WIN a great prize by spinning our prize wheel. Got an immediate need?

Solmetex, LLC 1112

Northborough, MA
800-216-5505
solmetex.com
We have amalgam separation down to a science. When it comes to Amalgam Separation, no one knows more than Solmetex. Twenty five years ago, our experience in water science led us to create a system that easily and affordably removes amalgam waste from dental practices. As a ‘total solution provider,’ Solmetex takes care of waste handling and recycling so you don’t have to. Good for you and good for the environment. Solmetex – clearly the leader in amalgam separation.

Solutionreach 1525

Lehi, UT
801-331-7114
solutionreach.com
Solutionreach is a cloud-based platform for revolutionizing healthcare, with a powerful array of tools to easily acquire, retain, educate and reactivate patients.

Southern Dental Alliance. 1344

Kennesaw, GA
941-417-9654
southerndentalalliance.com

Spident Co., Ltd. 1114

Incon, Korea [South]
925-931-0743
spident.co.kr
Restorative materials: composite, resin, needles, impression materials

Stacker Building Group 1028

Brentwood, TN
615-840-0171
stackerbuildinggroup.com
Stacker Building Group is a commercial general contractor that offers the capability to construct new building projects, tenant build-outs and renovation projects. SBG focuses largely on dental and related construction projects. These projects range from large, medical office buildings, ground up single practice facilities or small remodels in existing practices.

Star Dental Partners746

Plano, TX
469-604-2399
stardentalpartners.com
Star Dental Partners is a differentiated Dental Support Organization that partners with high quality dentists in the Southern region of the United States. We support your practice by providing customized solutions to the non-clinical business challenges you face. Our top priority is to help our dentists reach their goals.

StellaLife 1227

Glenview, IL
800-828-7265
stellalifehealing.com

StellaLife® is an innovative biotech company on a mission to improve people’s lives and significantly reduce, or in some cases eliminate, the need for narcotic pain medications, steroids and antibiotics. Awarded 2019 Top Healing Product, the VEGA® Oral Care is formulated to temporarily reduce post-surgical dental pain, accelerate healing and promote optimum oral health.

Straumann 1520

Andover, MA
978-747-2538
straumann.us

Straumann® – the world’s leading brand for confidence in implantology and beyond. We stand for premium Swiss quality, precision and innovation delivering confidence in dentistry, backed by the largest global scientific network. As the global leader in implantology, we deliver cutting-edge innovations regarded as industry benchmarks and disruptive technological breakthroughs, supported by long-term scientific evidence. We push the boundaries to enable the next generation of dental care.

Straumann Group Digital Solutions . . 1520

Andover, MA
800-448-8168
straumannusa.com

Straumann Group Digital Solutions for dentists and dental laboratories include cost-effective, efficient and patient-centric equipment for intraoral scanning and guided surgery. Dentists, lab technicians and patients all benefit from a digital workflow that saves time and improves patient communication featuring efficient and cost-effective workflows for all phases of treatment.

Sunbit 1231

Los Angeles, CA
845-701-5284
sunbit.com/dental

Sunbit is the preferred buy now, pay later technology for everyday needs and services. Sunbit eases the stress of buying everyday things by offering access to fast, fair and transparent payment options to people everywhere. Our technology is offered in-store and online at more than 10,000 locations, including 1 in 3 auto dealership service centers, optical practices, dentist offices and specialty healthcare services.

Sunrise Dental Equipment, Inc.. 1532

Leesburg, FL
352-326-5528
sunrisedentalequipment.com

We provide Dentists with a unique BUY/SELL/TRADE opportunity, always striving to save you thousands. We sell a combination of new, refurbished and good quality used equipment. We also specialize in BANK REPOS, allowing us to resell equipment that is mostly in like new condition for a fraction of the original cost. From a single item to a complete office, come see us if you want to save thousands.

SUNSTAR AMERICAS, Inc.. 1624

Schaumburg, IL
800-528-8537

us-professional.gumbrand.com/gumbrand
Sunstar Americas, Inc. is a leader in developing high-quality, research-based oral care solutions for better overall patient health. By partnering with dental and medical clinicians, academics and researchers, Sunstar continues to innovate and provide daily oral care, advanced gum care and chairside products under the GUM® and Butler® brands.

Superior Dental Design & Upholstery. . .801

Orlando, FL
407-347-5992
superiordds.com

Superior Dental Design Services is a family-run business celebrating our 42nd year of selling quality, new and recycled dental equipment. Brands such as Adec, Belmont, DCI, Tuttnauer, Beaverstate and more. Our showroom is located in downtown Orlando. There you can tour our 15,000 square foot production facility which is opened Monday-Friday. We encourage dentists to stop by and see how each piece is crafted to your specifications.

Surgitel. 1635

Ann Arbor, MI
800-959-0153
surgitel.com

SurgiTel designs and manufactures premium loupes, headlights and accessories to enhance vision and help avoid eye stress and neck/back pain. SurgiTel loupes are sold around the world and have received multiple awards for our exclusive, patented innovations in lens, prism and LED technologies. Always looking to build and maintain lasting customer relationships with our innovative products, SurgiTel keeps on the forefront of vision and ergonomics. Visit our booth to try all our newest products!

Symmetry Dental Equipment Cabinetry 1100

St. Louis, MO
314-497-0403
symmetrydental.com

Symmetry Dental Equipment manufactures all your dental operatory and sterilization cabinet console needs including integrated delivery and assistant equipment packages. Textured laminates, solid surface countertops, soft close drawers and doors, nickel handles and structural steel bases are stand features on all of our cabinets consoles.

TMJ Services 1732

Brentwood, TN
615-771-1983
tmjservices.net

TMJ Services provides clinical, technical and marketing training and licensing in the use of our patented, FDA approved, non surgical device for the permanent relief of the symptoms of TMD. The Urbanek Device and Protocol has been used to treat over 3,000 patients to date with a 95% success rate. Doctors licensed in our network are able to develop substantial increase in new patient flow and cash income for their practice using our proprietary program substantially increasing referral sources.

Tokuyama America 1821

Encinitas, CA
877-378-3548
tokuyama-us.com

Tokuyama Dental America is a leading manufacturer of dental products, such as restoratives, adhesives and denture reline material. We are 100% committed to Innovating Tomorrow’s Dentistry, Today™. Tokuyama Dental’s products include innovations such as Omnichroma, the world’s only universal composite that matches every tooth shade with one shade of composite. Now, the same award-winning benefits are available in a flowable with the launch of Omnichroma Flow!

Top Quality Mfg., Inc. - Glove World . . 1109

Beverly Hills, CA
800-483-8559
topqualitygloves.com

We are the home of GLOVES and other infection control products widely used in, but not limited to the medical and dental industries.

Transition Acceleration Group 1030

Moultrie, GA
404-965-8209
transitionaccelerationgroup.com
We offer a wide variety of practice management services including medical and dental credentialing, medicare/DME applications, Practice Acceleration Coaching, management support, and sales guidance for buyers/sellers.

Tuttner USA Co., Ltd. 1441

Hauppauge, NY
800-624-5836
tuttnerusa.com
For over 90 years, Tuttner's sterilization and infection control products have been trusted by professionals throughout the world. Fully automatic EZ and new EZPlus models feature active closed door drying for sterility and efficient drying. EZ11Plus has 5 trays and an 11" x 19.8" chamber. All EZ and EZPlus models come with a 2 year parts and labor warranty. Our manual autoclaves set the standard for steam sterilization and are the benchmarks in the industry.

Ultradent Products, Inc. 1621

South Jordan, UT
800-552-5512
ultradent.com
Ultradent Products, Inc. is a leading developer of high-tech dental and hygiene materials, devices and instruments worldwide. Ultradent's mission is to improve the level of oral healthcare and to make dental procedures more predictable and hassle-free. Consistent with its mission, Ultradent works to improve the quality of life and health of individuals through financial and charitable programs.

Ultralight Optics 734

Costa Mesa, CA
323-316-4514
ultralightoptics.com
Ultralight Featherlight is the award-winning, smallest, and lightest LED loupe-light with custom made attachments that will fit onto all loupes, glasses, safety glasses, everything! With 6 full intensity levels and touch-free upgrade option available, have a system that really works for you.

Ultralight Optics 1935

Costa Mesa, CA
323-316-4514
ultralightoptics.com
Ultralight Featherlight is the award-winning, smallest, and lightest LED loupe-light with custom made attachments that will fit onto all loupes, glasses, safety glasses, everything! With six full intensity levels and touch-free upgrade option available, have a system that really works for you.

United Community Bank 841

Greenville, SC
864-240-6201
ucbi.com
Building and expanding your dental practice should not be stressful, especially when it comes to financing. As a national dental lender and expert in the market, United Community Bank provides Commercial, SBA 7(a), SBA 504 and USDA Business and Industry Loans to fit the unique financing needs of the dental industry. Our team is dedicated to making the lending process simple and straightforward. You focus on your patients, we will focus on helping you grow.

Valumax International 1127

Allentown, PA
610-336-0101
valumax.net
3-Bar Superior ArchAway Mask is comfortable for wearing all day long, you even forget it's on. Only 3-Bar ArchAway Mask can claim this, you try it on, you will agree with it, No hyperbole tricks, it is real. Compare with your old masks, you will see how much more comfortable and better fitting the ArchAway Mask is. 10 boxes + 2 boxes free at the show.

Vatech America. 1613

Fort Lee, NJ
201-210-5374
vatechamerica.com
Vatech is the world's leading provider of dental digital radiography and Cone Beam CT and offers the most diverse product portfolio. Vatech is dedicated solely to innovative digital dental X-ray imaging technologies which aid dentists and patients.

Vector Research & Development 1100

University Place, WA
877-883-7455
vectorusa.net
Vector Research & Development provides everything you need from a full line of German made highspeed handpieces including handpiece replacement parts, LED bulbs and accessories, prophylaxis handpieces, stain removers and lab handpiece systems, to scaling units and implant motor systems. Iridium Dental provides hand-held digital dental radiography. MaxRay and Cocoon x-ray system, Iridium I-Rex Premium Sensors.

VeriONE. 1120

Louisville, KY
800-626-5651
whipmix.com
Founded in 1919, Whip Mix manufactures dental supplies, lab equipment, CAD/CAM technologies including the manufacture of zirconia Discs, 3D Print Resins, and the Whip Mix®, Denar® and Hanau™ occlusion products. Whip Mix provides technical support for all of its products including Asiga Printers, 3Shape Scanners and Roland Dental Mills. The global company sells through distributors in over 80 countries with a European distribution center in Germany.

Verrific 912

Chicago, IL
928-208-4583
verrific.biz

Video Dental Concepts 1221

Ormond Beach, FL
800-323-2690
videodental.com
Video Dental Concepts was established in 1989 and is now a pioneer in the dental industry. We strive to provide the latest technology at affordable prices. From intraoral cameras and digital sensors to our digital impression scanner we have you covered on all of your 2D/3D digital imaging needs!

Vivos Therapeutics 713

Highlands Ranch, CO
866-908-4867
vivoslife.com
Vivos Therapeutics Inc. (NASDAQ: VVOS) is a medical technology company focused on developing and commercializing innovative treatments for patients suffering from sleep disordered breathing, including obstructive sleep apnea (OSA).

Water Pik Inc.. 1315

Fort Collins, CO
800-525-2020
waterpik.com

Water Pik, Inc. is a manufacturer of innovative personal care products, including the #1 recommended Waterpik® Water Flosser and a full line of professional in-office use products. Water Pik, Inc. is proud to introduce the New Waterpik® Sonic-Fusion and Waterpik Aquarius™ Water Pik also offers Waterpik® UltraThin Fluoride Varnish with popular flavors. Check out our Great Show Specials, and Sign up for a Lunch & Learn in your office. Also pick up samples available at the Booth 1315.

Weave833

Lehi, UT
888-579-5668

getweave.com/industry/dentistry

Weave is the all-in-one customer communication and engagement platform for small business. From the first phone call to the final invoice and every touchpoint in between, Weave connects the entire customer journey. Weave’s software solutions transform how businesses attract, communicate with, and engage customers to grow their business.

Wells Fargo N.A. 1417

Concord, CA
630-644-5240

practicefinance.wellsfargo.com

From opening your first practice to expanding or transitioning your business, we’ll work with you to gain a comprehensive understanding of your full financial picture. For everything from loans to start a practice to the things you need to run your practice, including patient financing, we’re here to help. We provide simple solutions to run your business so you can be an effective business owner while you care for your patients.

Whip Mix Corp. 1021

Louisville, KY
800-626-5651

whipmix.com

Founded in 1919, Whip Mix manufactures dental supplies, lab equipment, CAD/CAM technologies including the manufacture of zirconia Discs, 3D Print Resins, and the Whip Mix®, Denar® and Hanau™ occlusion products. Whip Mix provides technical support for all of its products including Asiga Printers, 3Shape Scanners and Roland Dental Mills. The global company sells through distributors in over 80 countries with a European distribution center in Germany.

ZOLL Medical Corporation 1324

Chelmsford, MA
617-571-5158
zoll.com

ZOLL® Medical Corporation, a leader in medical devices and software solutions, provides AED and CPR products for health care organizations that accommodate or serve the public, such as dentists, doctors, nursing homes, and long-term care facilities. Our clinically advanced, easy-to-use products help lay rescuers and professionals alike respond quickly and effectively to sudden cardiac arrest. Real CPR Help® technology in ZOLL’s AEDs and defibrillators provides real-time feedback on CPR quality.

Zoll-Dental 1604

Niles, IL
800-239-2904

zoll dental.com

Zoll-Dental is a manufacturer of dental hand instruments located in Chicago. Our 100% USA made product line includes basic hygiene to advanced oral surgery instrumentation. All of our hinged instruments are from Europe with a few exceptions. Zoll-Dental also has a full instrument service center.

Zubler USA917

Lawrenceville, GA
972-600-9187

zublerusa.com

Equipment and materials for the dental professional.

Zyris - Smiles All Around 1432

Goleta, CA
800-560-6066

zyris.com

At Zyris we want you to See it. Feel it. Try it. You’ll be amazed to see how our unique products give you total control over the oral environment. No more fighting the tongue. No more fighting saliva and changing cotton rolls. Procedures go 30% faster with less stress for you and the dental team.

Food & Beverage

Georgia World Congress Center



Complimentary coffee daily in the Total Health Pavilion (booth 1555):

Gourmet Coffee Station

Thursday and Friday from 2 – 5 p.m.
Saturday from 10 a.m. – 12 p.m.

Stop by for a free cup of gourmet coffee!

Courtesy of **HEARTLAND[®]**
DENTAL

The banner features a white coffee cup with steam rising from it on the left. The background is dark brown with decorative swirls. A yellow speech bubble on the right contains the text 'Stop by for a free cup of gourmet coffee!'. The Heartland Dental logo is on the bottom right.

Eatery Hours:

Thursday & Friday 11 a.m. – 3 p.m. | Saturday 10 a.m. – 2 p.m.

Eatery #1

[A1 – left side of the Exhibit Hall]

- Georgia Subs & Salads
- Papa John's (pizza)
- SoKoMe (rice bowl & dumplings)
- Cajun Café (gumbo /jambalaya/ red beans & rice)

Eatery #2

[A2 – right side of Exhibit Hall]

- Newk's (sandwiches/salads/sides)
- Nathan's Hotdogs
- 4 Rivers BBQ
- Papa John's (pizza)
- Pita Hut (rice bowl)

Coffee/Esspresso/Pastries available in GWCC A Building:

Southern Roots

(near Registration, A Building Main Entrance)

Wednesday 7 a.m. – 2:30 p.m.

Thursday, Friday & Saturday 6 a.m. – 4 p.m.

Cappuccino Express

[A300 Level and at Exhibit Hall entrance] 7 a.m. – 4 p.m.

Thank you to our partners



DENTALINTELLIGENCE



The Hinman Dental Meeting wishes to thank the following companies for providing supplies for our hands-on courses.

Please visit these exhibitors while at the Meeting.

3M Oral Care
ACTEON North America
A. Titan Instruments
Atlanta Dental Supply
Biolase

BQ Ergonomics LLC
Fotona
Garrison Dental Solutions
GC America, Inc.

Ivoclar Vivadent
HuFriedy Group
Nobel Biocare USA
Straumann
Ultradent Products, Inc.

ULTRADENT'S MOST REQUESTED EQUIPMENT



UVENEER® DIRECT COMPOSITE TEMPLATE SYSTEM

The unique, minimally invasive Uveneer template system creates beautiful composite veneers with predictable shape and symmetry in just one visit.



GEMINI™

810 + 980 DIODE LASER

GEMINI™ 810 + 980 DIODE LASER

The Gemini laser features 20 watts of peak super-pulsed power and a stunning, fully transparent electroluminescent display. No matter the procedure, the innovative Gemini laser makes it faster, smoother, and more efficient.



VALO™

VALO™ CURING LIGHT

Every VALO curing light contains ultra-high-energy broadband LEDs to cure all dental materials and an optimally collimated beam for a complete, uniform cure.



ultrapro™ Tx air

ULTRAPRO™ TX AIR HANDPIECE

Lightweight and ergonomic, the Ultrapro Tx Air handpiece provides a smooth polishing experience you and your patients will love.



Stop by Booth #1621

for a demonstration on these products and more!

800.552.5512 | ULTRADENT.COM

© 2022 Ultradent Products, Inc. All rights reserved. 020822